



Woodley Crescent, NW2

£410,000

Situated on the second floor of a recently built development with lift access, is this one bedroom flat with an open-plan living area with a well-fitted kitchen leading on to a private balcony, a large bathroom, storage and all offered in excellent condition throughout.

Coleby House is a new development situated a short distance from Cricklewood Station (Thameslink) and soon to be David Lloyds Gym as well as numerous road connections including the North Circular (A406), Hendon Way (A41) and the M1 motorway.

Features

- One Bedroom
- Excellent Condition
- Private Balcony
- Close To Transport
- Open Plan Living Area
- Chain Free

Woodley Crescent, London, NW2

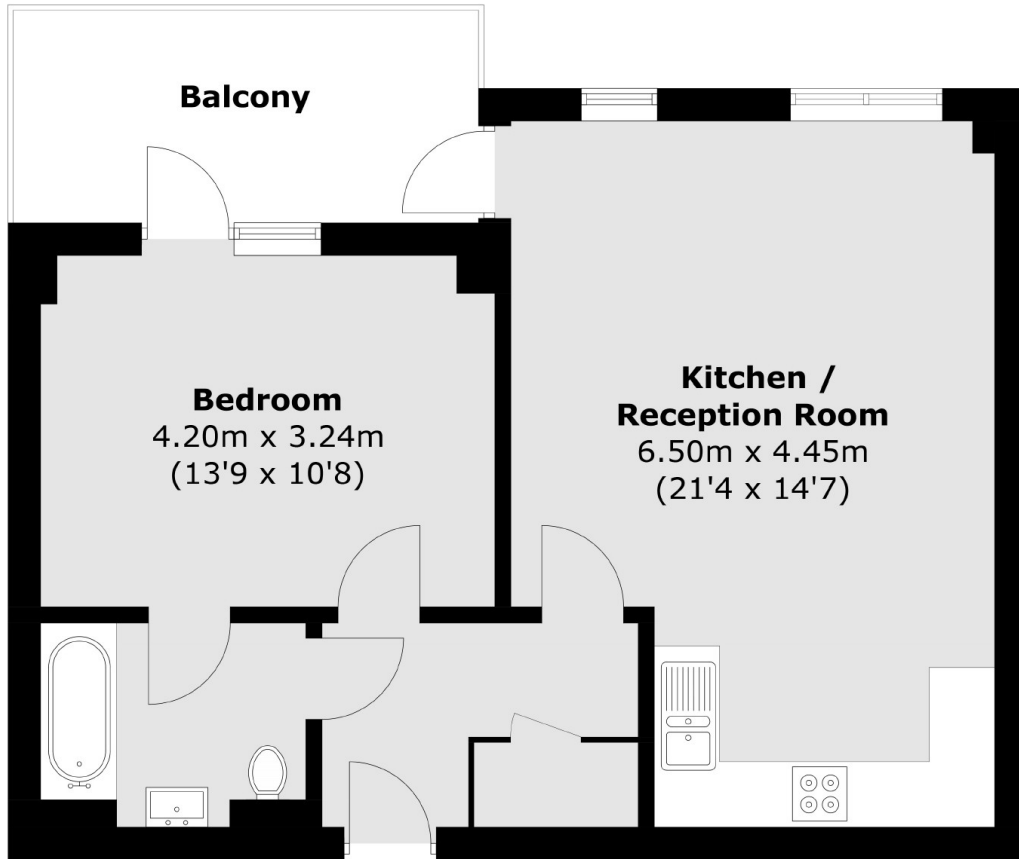

Total area (approx.): 52.0 sq. m (559.7 sq. ft)
Balcony (approx.): 8.4 sq. m (90.4 sq. ft)