



Quantock Gardens, NW2

£670,000

A semi-detached house situated in the desirable Golders Green Estate boasting three bedrooms, family bathroom, two reception rooms and separate kitchen leading out on to the garden. The property comes with off-street parking and no onward chain.

Quantock Gardens is situated within the favourable Golders Green Estate; a very family-orientated residential area. Local transport links include Cricklewood (Thameslink) station, the new Brent Cross West station and numerous bus routes.

Features

- Three Bedrooms
- Two Reception Rooms
- Separate Kitchen
- Off-Street Parking
- Potential to Extend (STPP)
- No Onward Chain

Quantock Gardens, London, NW2

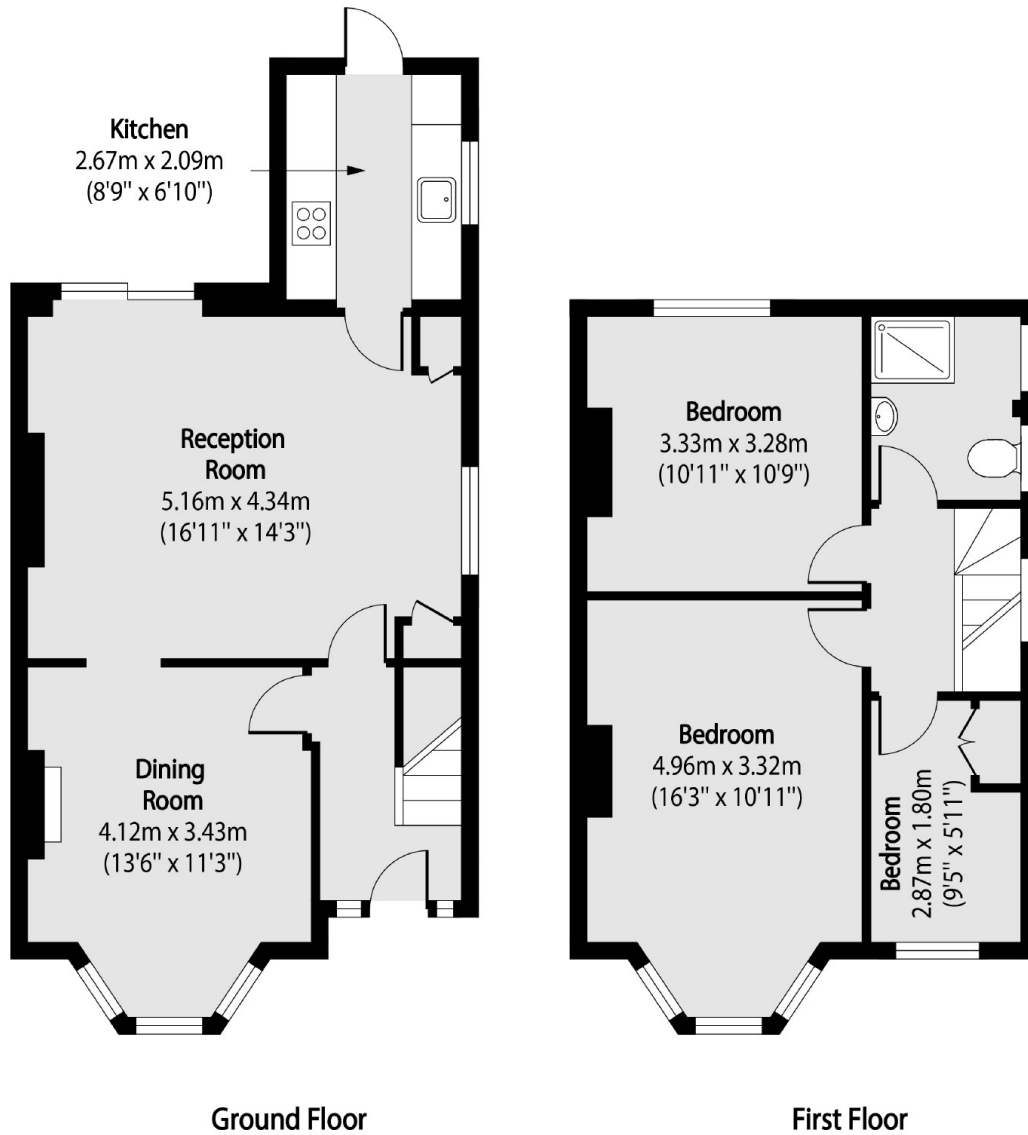

Total area (approx): 86.43 sq m (930 sq. ft)