



Dartmouth Road, NW2

£530 Per week

This two bedroom top floor conversion is ideally situated in the heart of the Mapesbury with excellent transport links and local amenities near by. The property is bright and spacious with a open plan living area, a modern integrated kitchen, tiled shower room and good storage space throughout.

Dartmouth Road is well situated for Willesden Green and Kilburn high streets with many boutique cafés, restaurants and local amenities. Willesden Green, Kilburn stations (Jubilee Line) and Brondesbury (Overground) and many bus services are also on your doorstep.

Features

Two Bedrooms
Tiled Bathroom
Open Plan Kitchen
Built In Storage
Bright and Spacious
Ideally Situated

Dartmouth Road, London, NW2

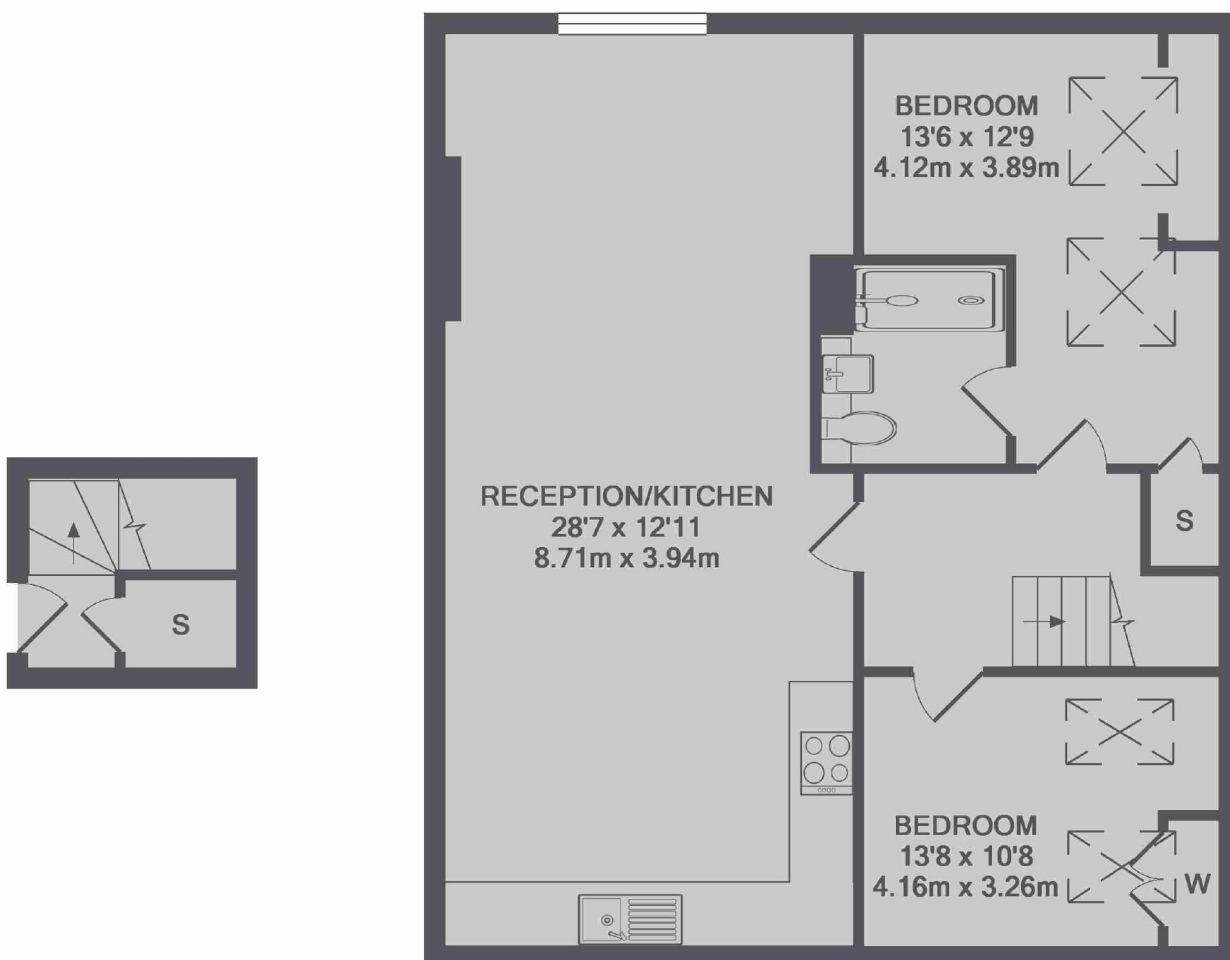

1ST FLOOR

2ND FLOOR

TOTAL APPROX. FLOOR AREA 733 SQ.FT. (68.1 SQ.M.)
Made with Metropix ©2017