



Romney Row, NW2

£535,000

A two/three double bedroom mid-terrace house, with a separate eat-in kitchen, two reception rooms, ground floor WC and two shower rooms. The property comes with front and rear gardens, off-street parking and no onward chain.

Brent Terrace is a quiet, no-through residential road located just 0.8 miles from Cricklewood and its variety of amenities including Cricklewood Station, David Lloyd Gym and numerous supermarkets and shops. The new upcoming Station Brent Cross West is a short distance away.

Features

- Two/Three Double Bedrooms
- Two Shower Rooms and WC
- Separate Eat-In Kitchen
- Front And Rear Gardens
- Off Street Parking
- No Onward Chain

Romney Row, London, NW2

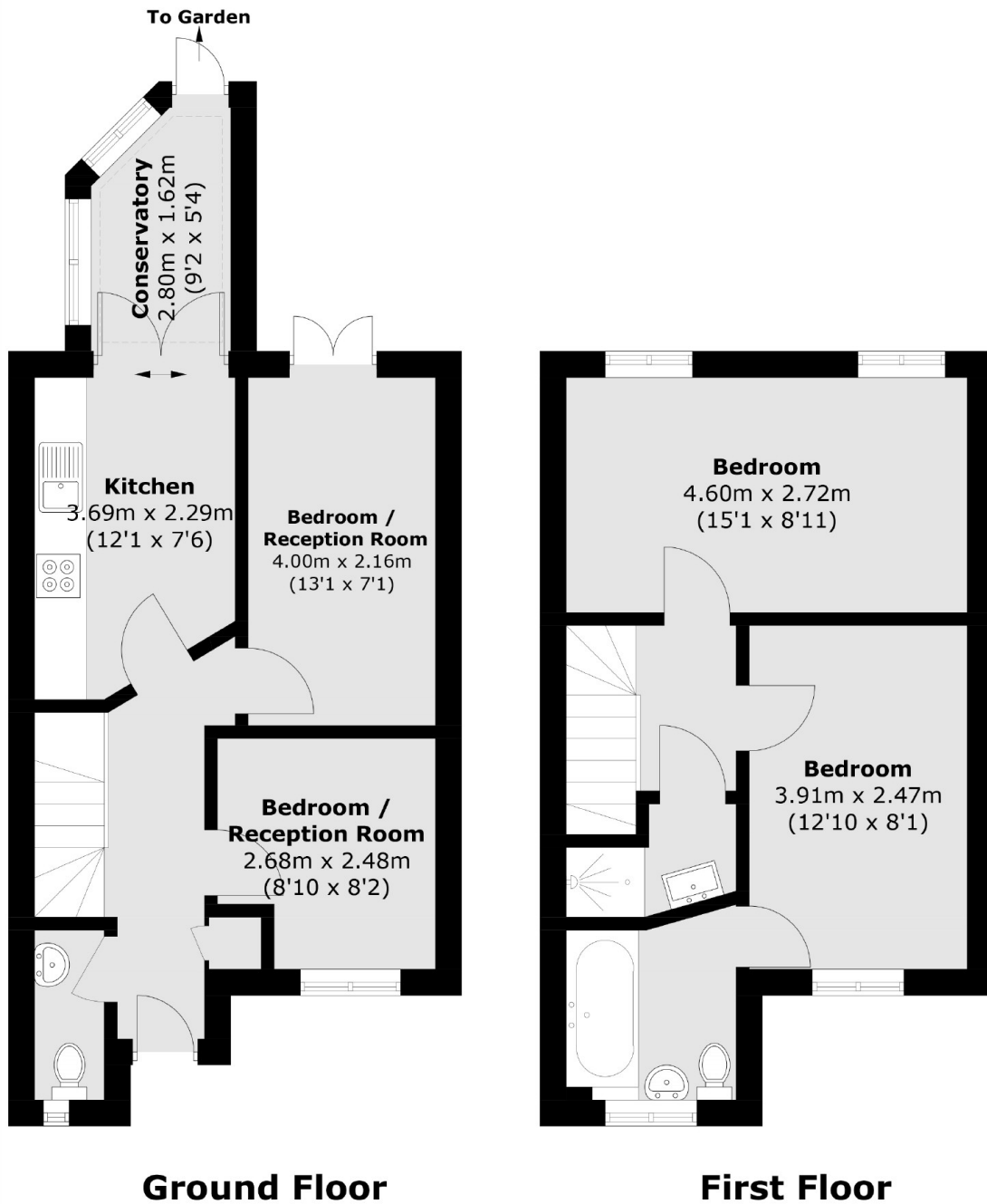

Total area (approx.): 72.5 sq. m (780.3 sq. ft)