



Shoot Up Hill, NW2

£350,000

Situated within a period conversion is this one double bedroom first floor flat with an open plan living area with well-fitted kitchen, bathroom, access to beautiful communal gardens and off-street parking. The property comes with no onward chain.

Shoot Up Hill is a short distance from Kilburn Station (Jubilee Line) & Brondesbury Overground Station as well as the large array of shops, cafes, restaurants and supermarkets found on Kilburn High Road and Cricklewood Broadway.

Features

- First Floor Flat
- High Ceilings
- One Bedroom
- Communal Gardens
- Off Street Parking
- No Onward Chain

Shoot Up Hill, London, NW2

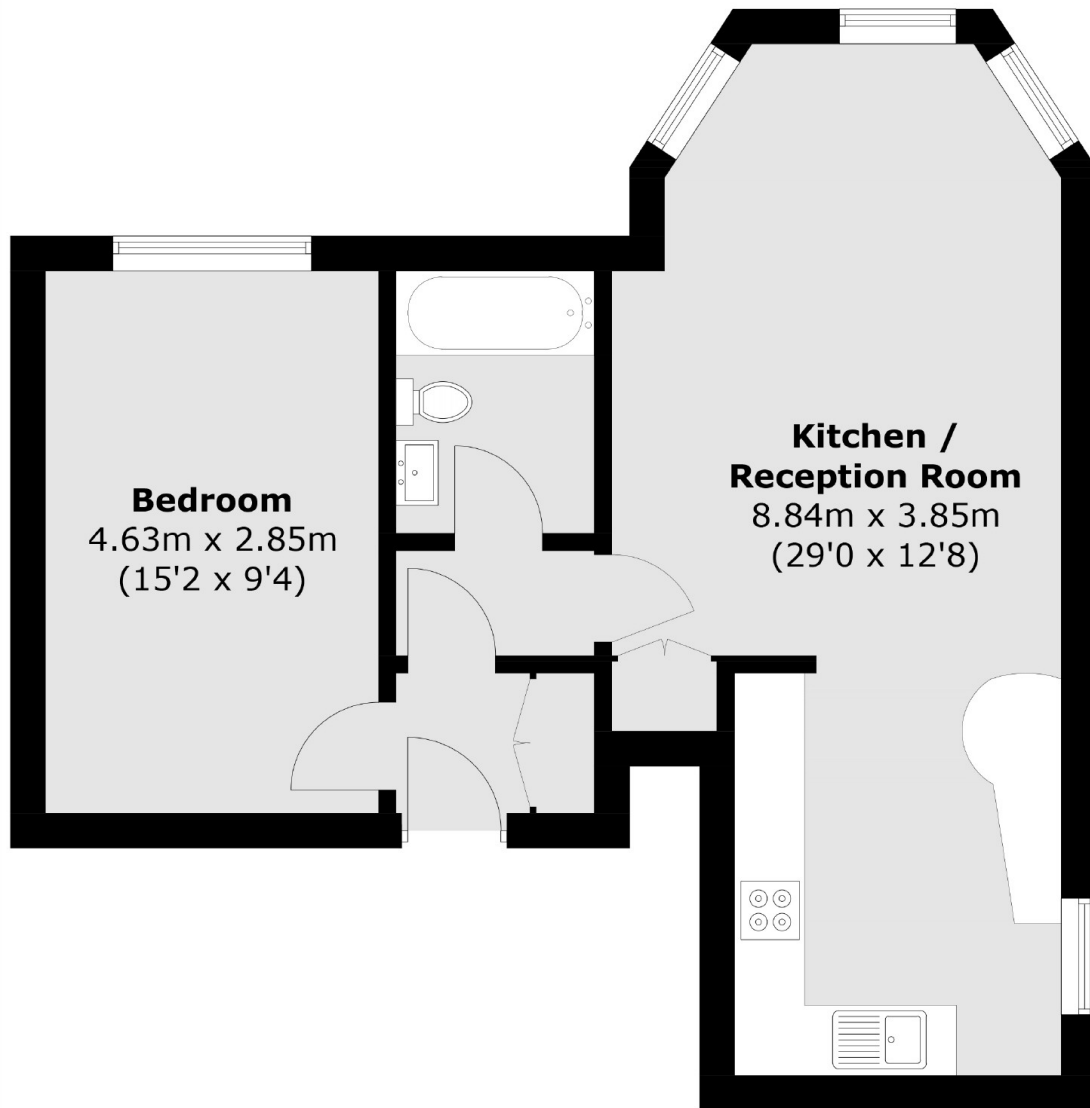

Total area (approx.): 51.8 sq. m (557.6 sq. ft)

Dexters

Cricklewood
28-30 Cricklewood Broadway
London
NW2 3HD
Sales
020 7794 7710

Energy Rating: D. We aim to make our particulars both accurate and reliable. However they are not guaranteed; nor do they form part of an offer or contract. If you require clarification on any points then please contact us, especially if you're traveling some distance to view. Please note that appliances and heating systems have not been tested and therefore no warranties can be given as to their good working order.

 **RICS** | Regulated
Estate Agent
and Letting Agent

dexters.co.uk