



Needham Terrace, NW2

£590,000

A unique freehold cottage having been thoughtfully renovated throughout and offering a spacious open plan living area and kitchen with two double bedrooms, modern bathroom and access to a secluded courtyard garden.

Needham Terrace is located at the end of the quiet Railway Cottages 'The Terraces' and is part of a welcoming community. Numerous bus routes and Cricklewood Station (Thameslink) are within easy reach for access to Central London.

Features

Two Double Bedrooms
Railway Cottage
Courtyard Garden
Fully Renovated
Open Plan Living Area

Needham Terrace, London, NW2

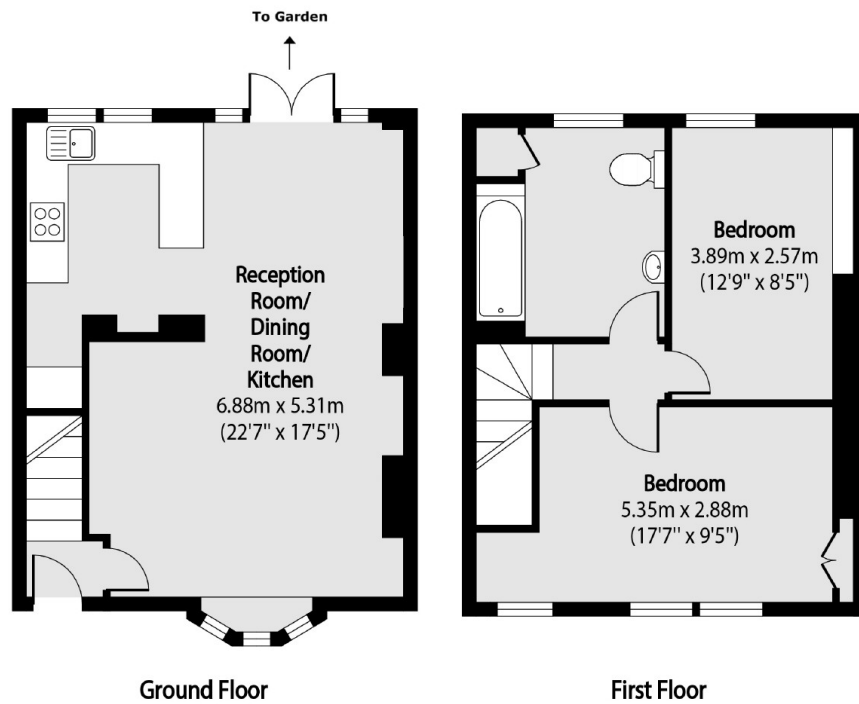

Total area (approx): 74.06 sq m (797 sq. ft)