



Shoot Up Hill, NW2

£450,000

Situated in this well-maintained purpose built block is this two double bedroom flat with a separate kitchen, spacious reception room, ample storage, bathroom and separate WC. The flat is located on the fourth floor with lift access and comes with access to communal gardens, off-street parking, a garage and no onward chain.

Wiltren Court is close to the trendy shops and bars of West End Lane and is within easy reach of Kilburn station (Jubilee Line) and Brondesbury station (Overground) offering excellent access to the City.

Features

- Two Double Bedrooms
- No Onward Chain
- Fourth Floor With Lift Access
- Separate Kitchen
- Newly Extended Lease
- Off Street Parking And Garage

Shoot Up Hill, London, NW2

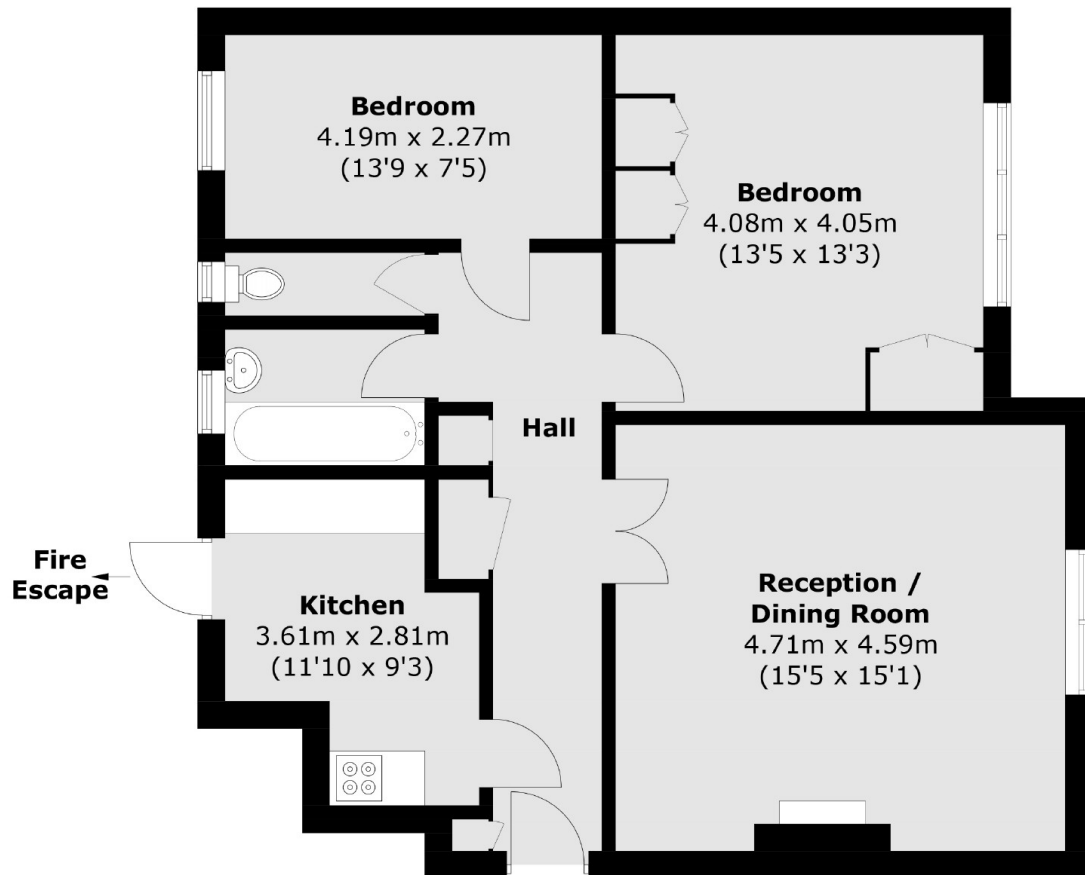

Total area (approx.): 77.1 sq. m (829.9 sq. ft)