



4 Isabella Court, Harrow Road, Warlingham, Surrey, CR6 9EY

Pollard Machin
estate agents since 1885

4 Isabella Court
Harrow Road
Warlingham
Surrey CR6 9EY

Monthly Rental Of £1,400

Pollard Machin

estate agents since 1885

A beautifully presented top floor two bedroom apartment in a quiet residential area with an allocated parking bay. Two double bedrooms including fitted wardrobes within the master bedroom. Bedframe available if required. An open plan kitchen/living room including appliances such as washing machine, hob, oven and fridge freezer. A modern bathroom which has a shower over the bathtub. Electric heating and double glazed throughout this property.

Isabella Court is located on Harrow Road in Warlingham. Conveniently within reach to a popular local pub, The Harrow as well as Chelsham Common and Sainsburys super market. Warlingham village has an array of local shops, pubs and restaurants. There are plenty of local primary, secondary schools and playing fields within reach.

Tandridge Council Tax Band - C .

EPC Rating - C.

Deposit - £1730.



4 Isabella Court Harrow Road

Approximate Gross Internal Area
603 sq ft - 56 sq m

Bathroom
7'3 x 6'2
2.21 x 1.88m

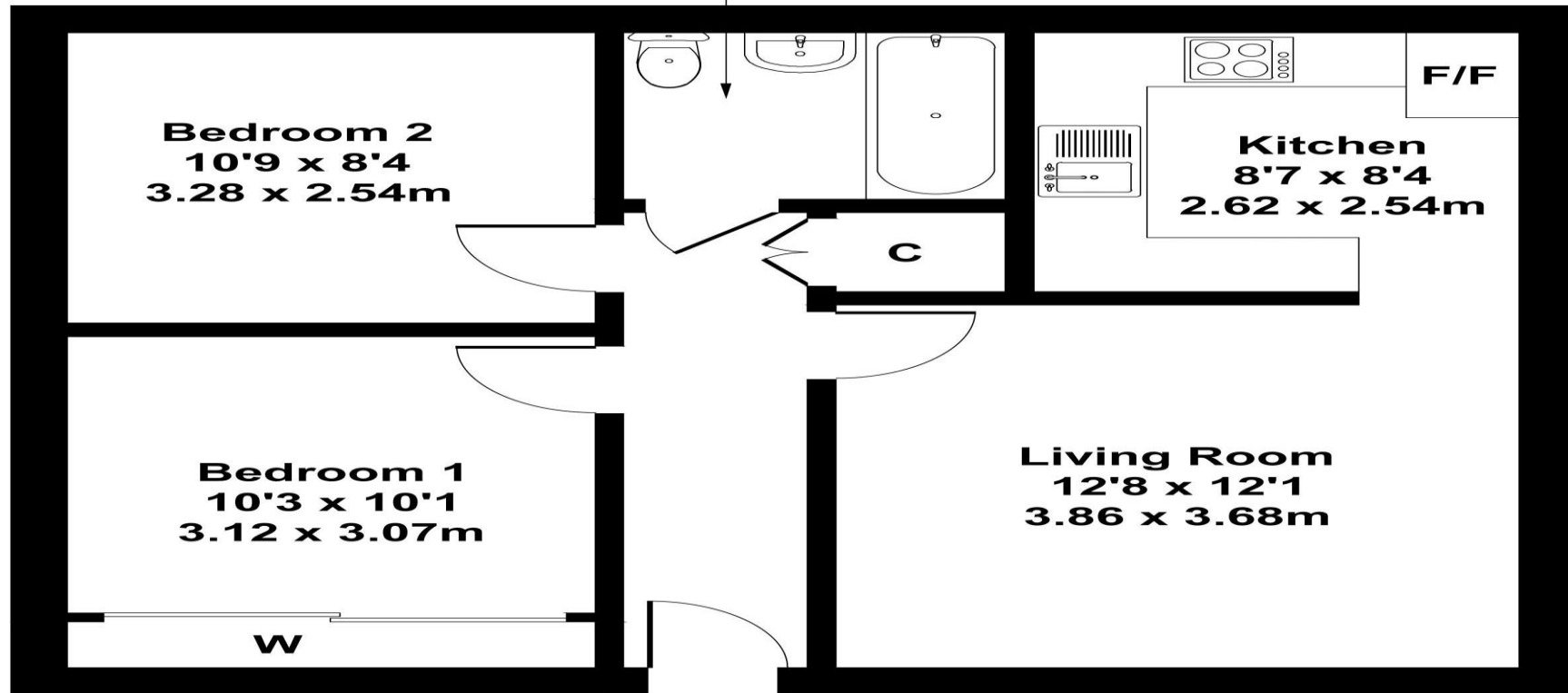

**Not to Scale. Produced by The Plan Portal 2024
For Illustrative Purposes Only.**

The Agents has not had sight of the title documents and therefore the buyer is advised to obtain verification of the tenure from their solicitor or surveyor. All measurements are approximate. The fixtures, Fittings & Appliances have not been tested and therefore no guarantee can be given that they are in working order. Photographs are reproduced for general information and it cannot be inferred that any item shown is included in the sale. You are advised to contact the local authority for details of Council Tax, Business Rates etc. Every care has been taken with the preparation of these Sales Particulars but complete accuracy cannot be guaranteed. If there is any point which is of particular importance to you, we will be pleased to check the information for you. These particulars do not constitute a contract or part of a contract.



Viewings Strictly by Appointment Only

Pollard Machin Estate Agents
45 Limpsfield Road
Sanderstead
Surrey
CR2 9LA
Tel: 020 8657 4466

Email: sales@pollardmachin.co.uk
Web: www.pollardmachin.co.uk

Selling exclusive homes throughout Surrey

Pollard Machin

estate agents since 1885