

2 ALTO BLOCK B SILLAVAN WAY
GREATER MANCHESTER, M3 6GB

£1,350 PCM

The Alto development is located just a stones throw from Deansgate and the heart of city centre. The property is situated on the first floor and briefly comprises: entrance hall, spacious open plan living/dining room, fully fitted dining kitchen, two double bedrooms, an en-suite shower room off the master bedroom and a modern main bathroom. Secure Parking Space. Available 11th August 2025

buckleyfrayne

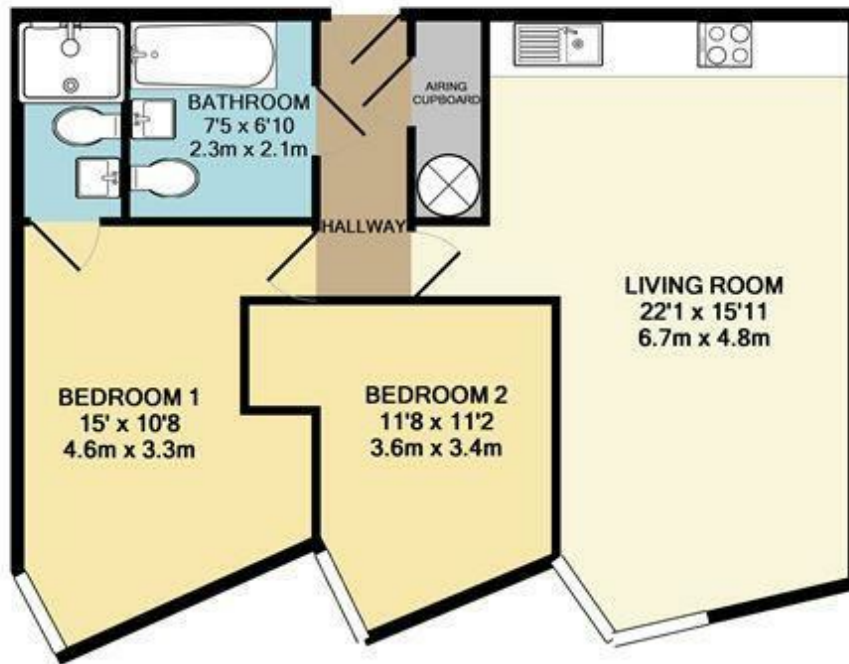

TOTAL APPROX. FLOOR AREA 632 SQ.FT. (58.7 SQ.M.)

Whilst every attempt has been made to ensure the accuracy of the floor plan contained here, measurements of doors, windows, rooms and any other items are approximate and no responsibility is taken for any error, omission, or mis-statement. This plan is for illustrative purposes only and should be used as such by any prospective purchaser. The services, systems and appliances shown have not been tested and no guarantee as to their operability or efficiency can be given.
Made with Metropix ©2013

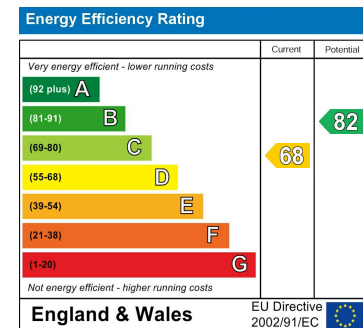
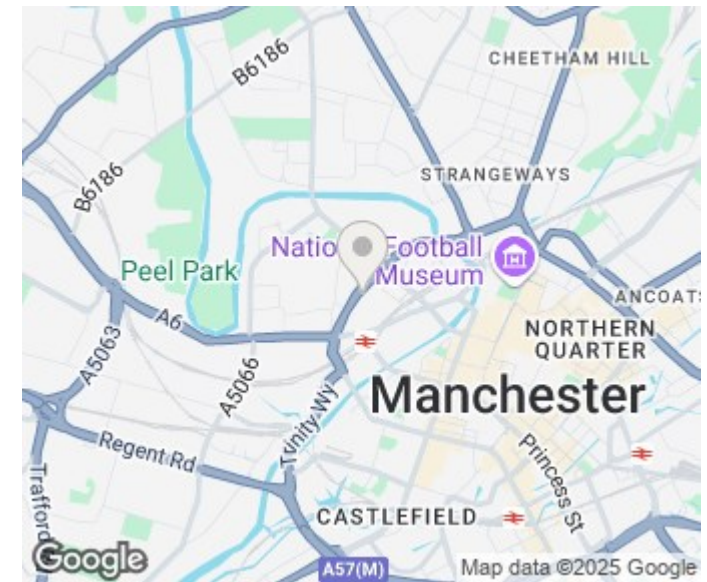

Agents Note: Whilst every care has been taken to prepare these particulars, they are for guidance purposes only. All measurements are approximate and are for general guidance purposes only and whilst every care has been taken to ensure their accuracy, they should not be relied upon and potential buyers/tenants are advised to recheck the measurements

Manchester Office Lettings
6-14 Great Ancoats Street
Northern Quarter
Manchester
M4 5AZ

0161 236 0004
mark.buckley@buckleyfrayne.co.uk
www.buckleyfrayne.co.uk

buckleyfrayne