



1013 CITY LINK HESSEL STREET
GREATER MANCHESTER, M50 1DH

£1,025 PCM

A spacious modern two bedroom apartment located close to the local metro station providing great access to Manchester city centre, Salford Quays and Media City. The accommodation briefly comprises: spacious open plan loungedining area, fully fitted kitchen, two double bedrooms and a three piece bathroom suite. Parking Space. Fully Furnished. Available 8th November 2024.

buckleyfrayne

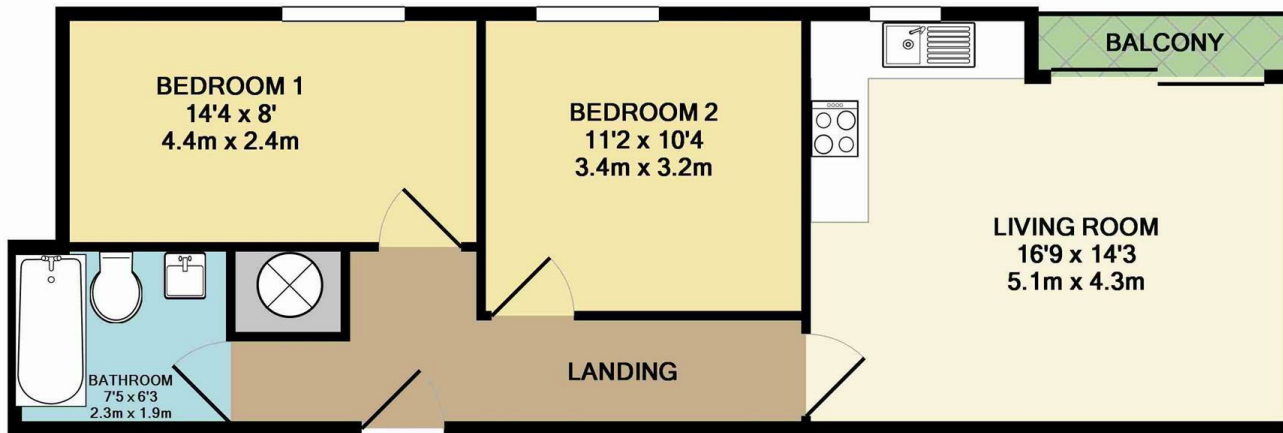

TOTAL APPROX. FLOOR AREA 592 SQ.FT. (55.0 SQ.M.)

Whilst every attempt has been made to ensure the accuracy of the floor plan contained here, measurements of doors, windows, rooms and any other items are approximate and no responsibility is taken for any error, omission, or mis-statement. This plan is for illustrative purposes only and should be used as such by any prospective purchaser. The services, systems and appliances shown have not been tested and no guarantee as to their operability or efficiency can be given

Made with Metropix ©2014

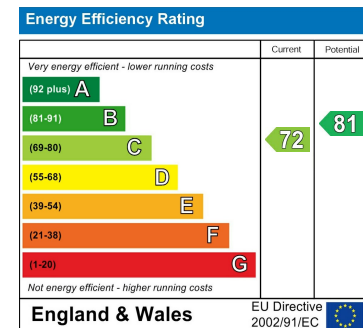
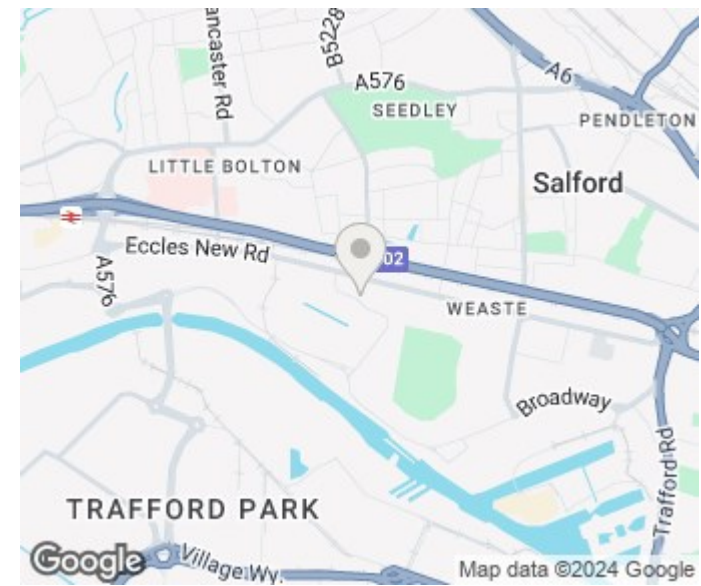

Agents Note: Whilst every care has been taken to prepare these particulars, they are for guidance purposes only. All measurements are approximate and are for general guidance purposes only and whilst every care has been taken to ensure their accuracy, they should not be relied upon and potential buyers/tenants are advised to recheck the measurements

Manchester Office Lettings
6-14 Great Ancoats Street
Northern Quarter
Manchester
M4 5AZ

0161 236 0004
mark.buckley@buckleyfrayne.co.uk
www.buckleyfrayne.co.uk

buckleyfrayne