

Royal Way, **Starcross**, EX6 8EQ



Stunning views across the Exe Estuary can be enjoyed from this versatile town house ideally located to take advantage of the benefits this waterside village has to offer. Arranged over three floors and fitted with gas central heating and uPVC double glazing it comprises; Entrance Porch, Reception Hall, Kitchen/Diner, Living Room, 4 Bedrooms, En Suite Shower Room, Bathroom, Small Garden, Garage and Parking.
Tenure: Freehold. Council Tax Band: D EPC: D

£320,000

01626 862379

www.fraserandwheeler.co.uk

FRASER & WHEELER

Situated a few yards from the river the property offers the opportunity for fishing, kayaking and other water sports. It is also located just off a level cycle route offering a gentle ride to the beach, or Exeter in the opposite direction, past a selection of well renowned pubs. There are beautiful walks around the country lanes and the picturesque estate of Powderham Castle to be enjoyed. The property is also well located for the range of facilities offered by the village including primary and pre-schools, doctors surgery, general store, chemist, church and pubs as well as regular bus and rail services. The accommodation is arranged over three floors allowing flexibility to meet a variety of requirements. It is fitted with gas central heating with radiators to all principal rooms and uPVC double glazed windows and doors. The stunning views can even be enjoyed from the comfort of your own armchair in the double aspect sitting room where double doors open on to a small balcony. In addition to the estuary views a pleasant outlook to the countryside to the rear of the village can be enjoyed from the two larger bedrooms.

Accommodation

uPVC stable door to;

Entrance Porch

Storage cupboard and door to;

Reception Hall

Stairs to the first floor, door to the garage and doors to;

Cloakroom

Fitted with a wash hand basin with tiled splashback and WC. Extractor fan.

Kitchen/Dining Room

4.46m x 3.17m (14'8" x 10'5")

Fitted with a range of cupboard and drawer base and wall units to three walls, built in electric oven and hob, plumbing for dishwasher and washing machine, space for fridge freezer, window and patio doors to the rear garden.

First Floor Landing

Stairs to the second floor and doors to;

Living Room

4.46m x 3.19m (14'8" x 10'6")

Stunning, far reaching views over the estuary and far beyond can be enjoyed from this bright, double aspect room with patio doors opening on to a small timber balcony. Electric fire.

Bedroom 1

4.46m x 3.20m (14'8" x 10'6") maximum

Enjoying a pleasant outlook to the front aspect towards the countryside in the distance. Door to;





En Suite

Fitted with a shower cubicle, vanity wash hand basin and WC. Heated towel rail, opaque window.

Second Floor Landing

Window to the side aspect also offering the stunning views over the estuary. Linen cupboard and doors to;

Bedroom 2

4.20m x 2.57m (13'9" x 8'5")

Fitted with a built in wardrobe and offering the open outlook towards the countryside.

Bedroom 3

3.21m x 3.16m (10'6" x 10'4")

Another room offering the stunning views over the estuary and beyond. Built in wardrobe.

Bedroom 4

3.00m x 1.80m (9'10" x 5'11")

Offering the views towards the countryside.

Bathroom

Finished with fully tiled walls and fitted with a white suite comprising deep bath with electric shower over, pedestal wash hand basin and WC. Heated towel rail and opaque window.

Outside

To the front of the property is a driveway providing space for two vehicles and leading to;

Garage

5.10m x 2.60m (16'9" x 8'6")

Roller door and wall mounted gas combination boiler serving the central heating and hot water systems.

To the rear of the property is a small area of low maintenance garden with artificial grass and a paved patio area, all enclosed by an old stone wall and fencing.



Ground Floor
42.1 sq.m. (453 sq.ft.) approx.

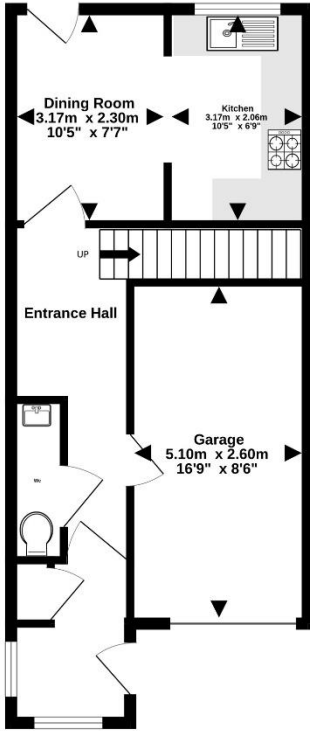

1st Floor
35.7 sq.m. (384 sq.ft.) approx.

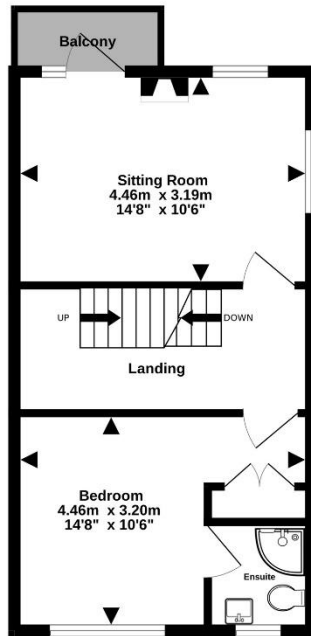

2nd Floor
35.9 sq.m. (387 sq.ft.) approx.

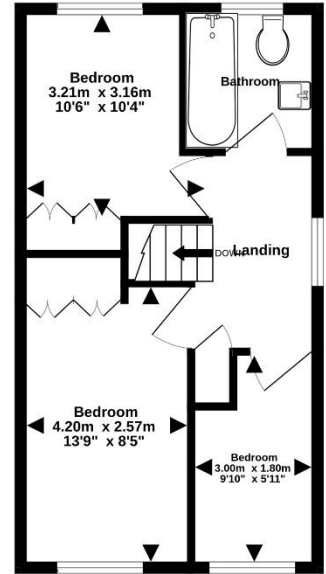

TOTAL FLOOR AREA : 113.7 sq.m. (1223 sq.ft.) approx.

Whilst every attempt has been made to ensure the accuracy of the floorplan contained here, measurements of doors, windows, rooms and any other items are approximate and no responsibility is taken for any error, omission or mis-statement. This plan is for illustrative purposes only and should be used as such by any prospective purchaser. The services, systems and appliances shown have not been tested and no guarantee as to their operability or efficiency can be given.
Made with Metropix ©2023



19 Queens Street, Dawlish, Devon, EX7 9HB
Telephone: 01 626 862379
Email: info@fraserandwheeler.co.uk
www.fraserandwheeler.co.uk



Fraser & Wheeler has not tested any apparatus, equipment fixtures and fittings or any services and cannot verify that they are in working order or fit for purpose. Prospective purchasers are advised to obtain their own independent reports from relevant professionals such as a surveyor or solicitor. Fraser & Wheeler advises buyers to make their own enquiries as to the tenure. All measurements and room descriptions are for general guide purposes only and buyers should verify information provided before purchasing furniture, fittings, carpets or appliances.