



255 Bishopsworth Road
, Bristol, BS13 7LH

Asking Price £249,995



255 Bishopsworth Road

, Bristol, BS13 7LH

***** CASH BUYERS ONLY *****

This property is in need of a full internal and external renovation.

Matthews and Co are pleased to bring to the sales market this 3 bed semi-detached situated in the sought-after location of Bishopsworth Road in Bedminster Down. The property briefly consists of hallway, through lounge/dining room and kitchen to the ground floor, upstairs are three bedrooms and a family bathroom. To the rear is a large garden, there is a garage to the side of the house and off street parking to the front.





Floor Plan

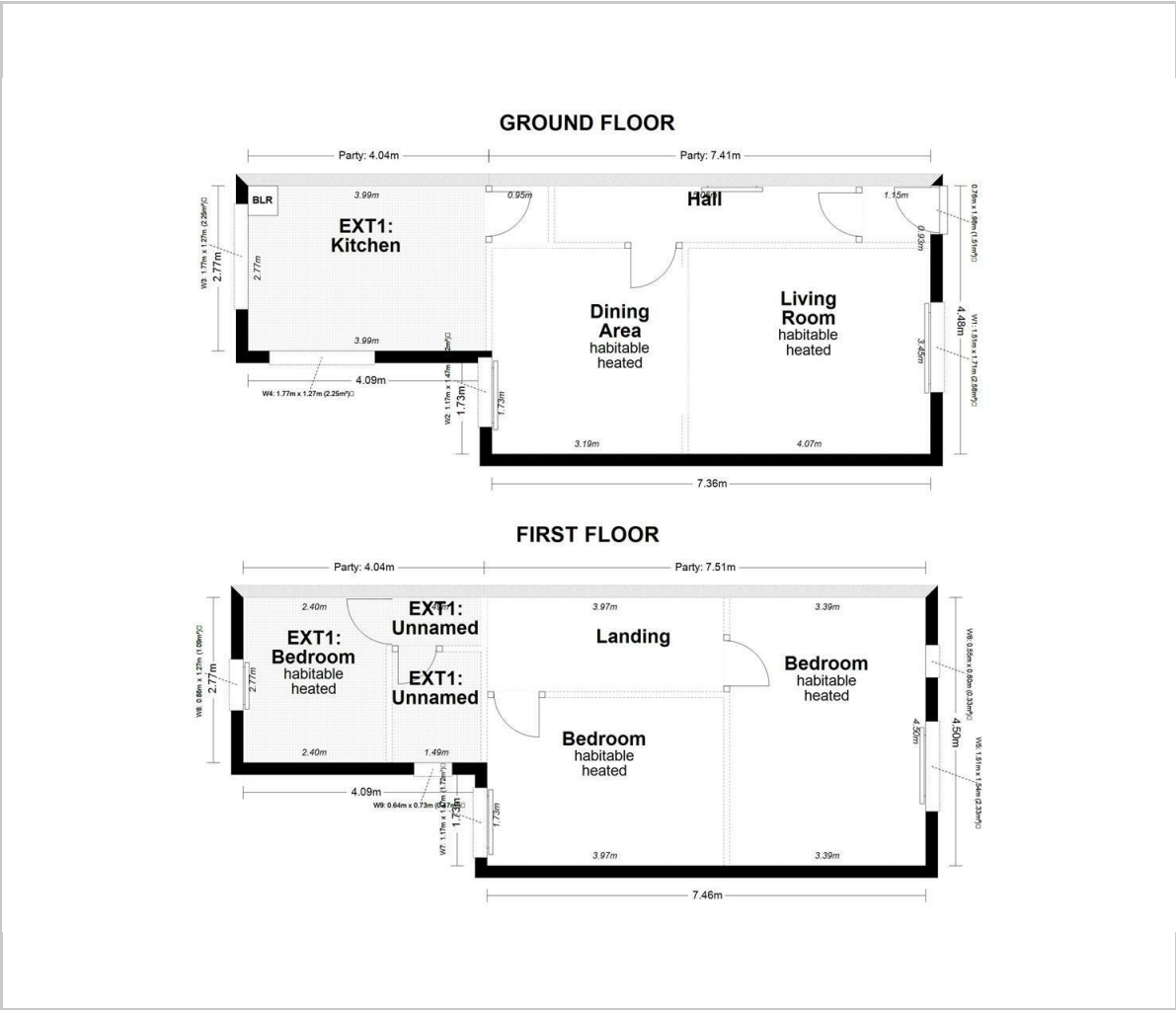

Viewing

Please contact our Knowle Office on 01179 711417 if you wish to arrange a viewing appointment for this property or require further information.

These particulars, whilst believed to be accurate are set out as a general outline only for guidance and do not constitute any part of an offer or contract. Intending purchasers should not rely on them as statements of representation of fact, but must satisfy themselves by inspection or otherwise as to their accuracy. No person in this firms employment has the authority to make or give any representation or warranty in respect of the property.

298 Wells Road, Knowle, Bristol, BS4 2QG

Area Map

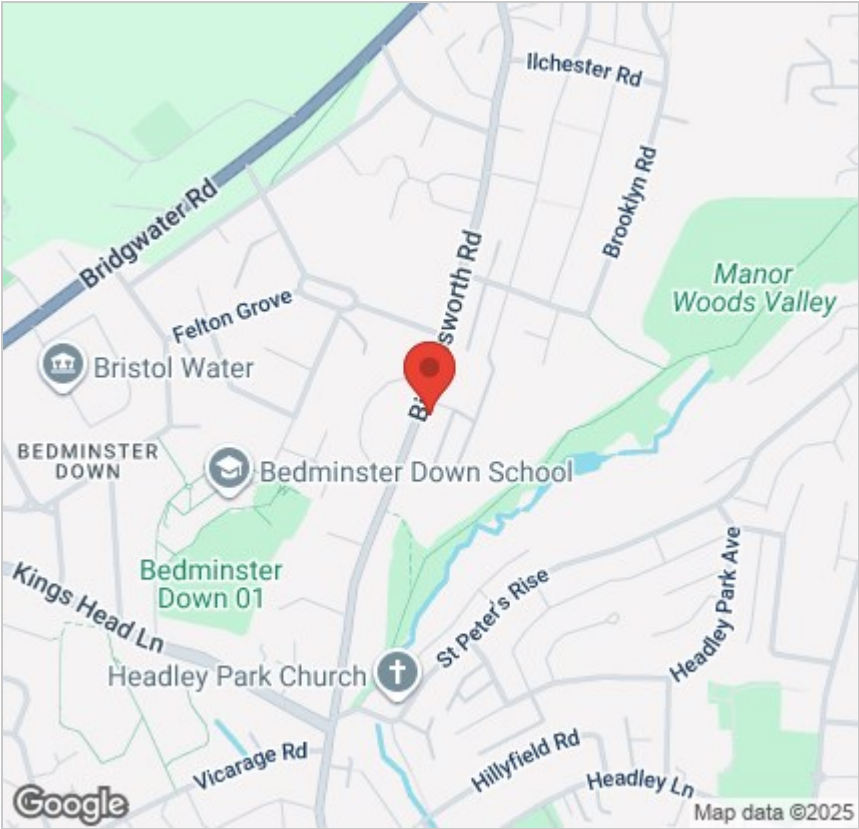

Energy Efficiency Graph

