



Steeple End | | Halesworth | IP19 8LL

**£950 Per Month**

**DURRANTS**  
SINCE 1853

## Key features

## Description

Nestled in the charming area of Steeple End, Halesworth, this delightful cottage offers a perfect blend of character and modern living. With two inviting bedrooms, this property is ideal for couples, small families, or those seeking a peaceful retreat. The well-presented interior features a newly fitted bathroom, ensuring comfort and convenience.

The cottage boasts a single reception room that serves as a warm and welcoming space for relaxation or entertaining guests. Its thoughtful design maximises the use of space, creating an inviting atmosphere throughout.

Situated in a prime town centre location, residents will enjoy easy access to local amenities, shops, and eateries, making daily life both convenient and enjoyable. The surrounding area is rich in history and offers a variety of leisure activities, perfect for those who appreciate the charm of a quaint market town.

## Directions







Floor plans

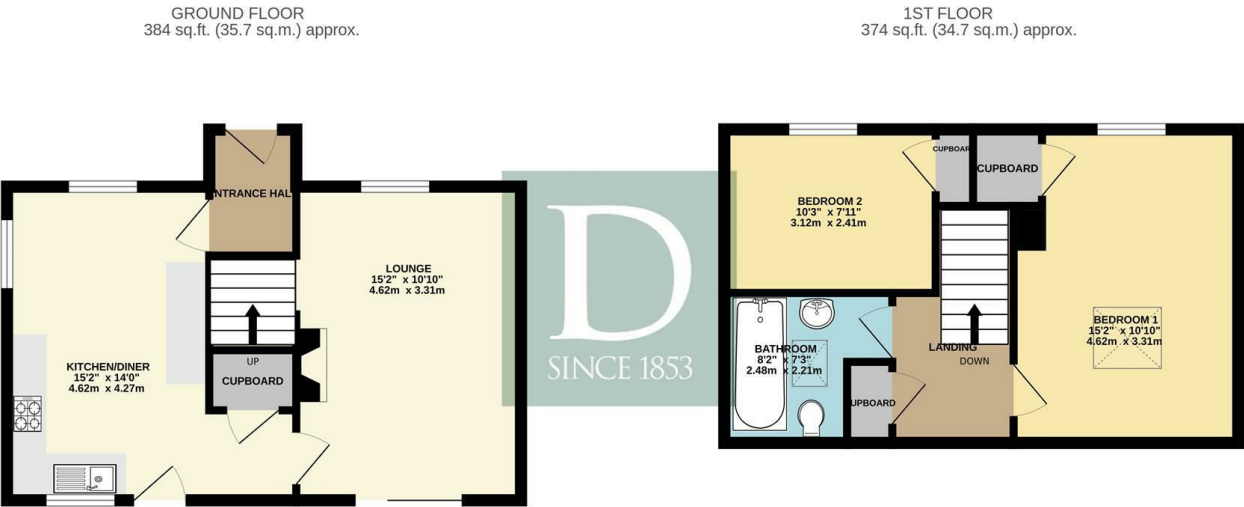

TOTAL FLOOR AREA : 758 sq.ft. (70.4 sq.m.) approx.

Whilst every attempt has been made to ensure the accuracy of the floorplan contained here, measurements of doors, windows, rooms and any other items are approximate and no responsibility is taken for any error, omission or mis-statement. This plan is for illustrative purposes only and should be used as such by any prospective purchaser. The services, systems and appliances shown have not been tested and no guarantee as to their operability or efficiency can be given.

Made with Metropix ©2025

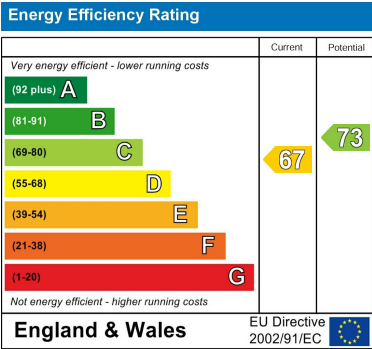

12 Thoroughfare  
Halesworth  
Suffolk  
IP19 8AH  
01986 872553  
halesworth@durrants.com  
<https://durrants.com/>