



Old Bank Mews | Wrentham | Beccles | NR34 7JS

£850 PCM

DURRANTS
SINCE 1853

Key features

- Brand New Kitchen Appliances
- Three Bedroomed
- Lounge
- Kitchen/Diner
- Cloakroom
- Bathroom
- En-suite
- Village location
- Allocated Parking Space
- Shared Courtyard

Description

Grade II Listed 3 bedroom house with light and well balanced spacious accommodation, off street parking space.

Directions

Applicants are advised to proceed from the Agents Southwold Office, turn right and proceed out of Southwold taking the first right turning into Lowestoft Road. At the junction with the A12 in the centre of Wrentham turn right, after approximately 100 yards turn right into Old Bank Mews, the property is located on the right.



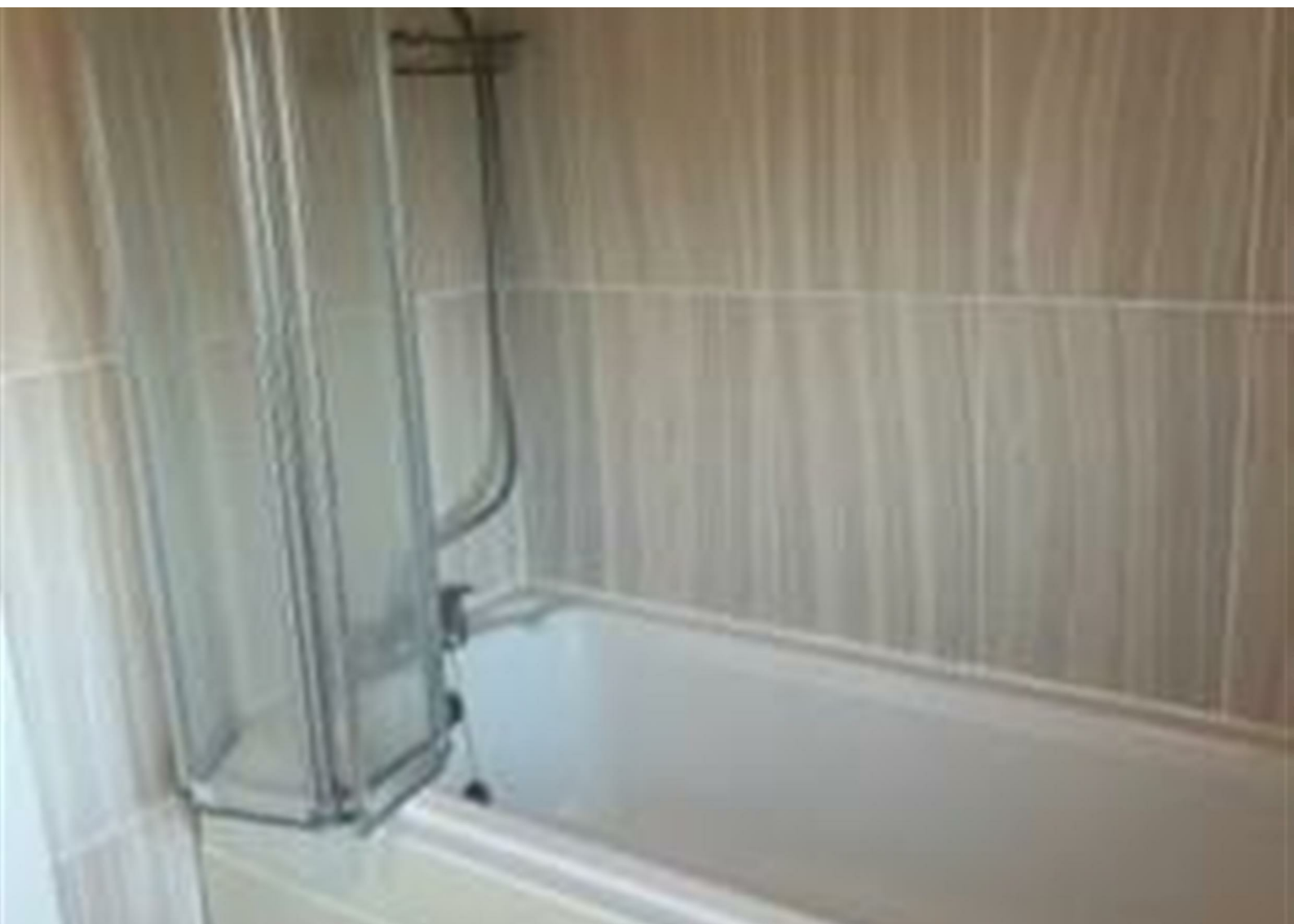

Floor plans



GROUND FLOOR

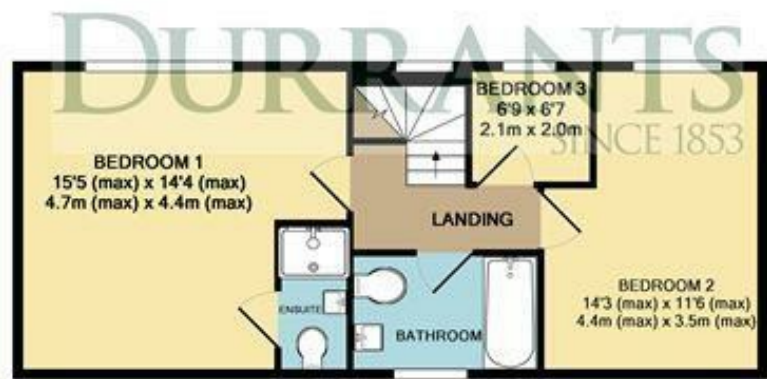

1ST FLOOR

Whilst every attempt has been made to ensure the accuracy of the floor plan contained here, measurements of doors, windows, rooms and any other items are approximate and no responsibility is taken for any error, omission, or mis-statement. This plan is for illustrative purposes only and should be used as such by any prospective purchaser. The services, systems and appliances shown have not been tested and no guarantee as to their operability or efficiency can be given.
Made with Metropix ©2012

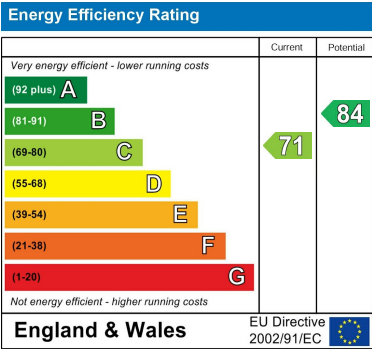

98 High Street
Southwold
Suffolk
IP18 6DP
01502 723292
southwold@durrants.com
<https://durrants.com/>