



The Summit

Mount Pleasant | Reydon | Southwold | IP18 6QP

£1,400

DURRANTS
SINCE 1853

Key features

- Detached bungalow
- Spacious accommodation
- Off road parking
- Village location
- Landscaped courtyard garden

Description

The Summit is a spacious and well presented detached bungalow, situated in the popular village of Reydon.

The property to the rear has a right of way over the drive to access their property.

The property would be required to remain on the Sales market for the duration of any tenancy and sales viewings will need to be allowed as part of the tenancy agreement.

Directions





Floor plans

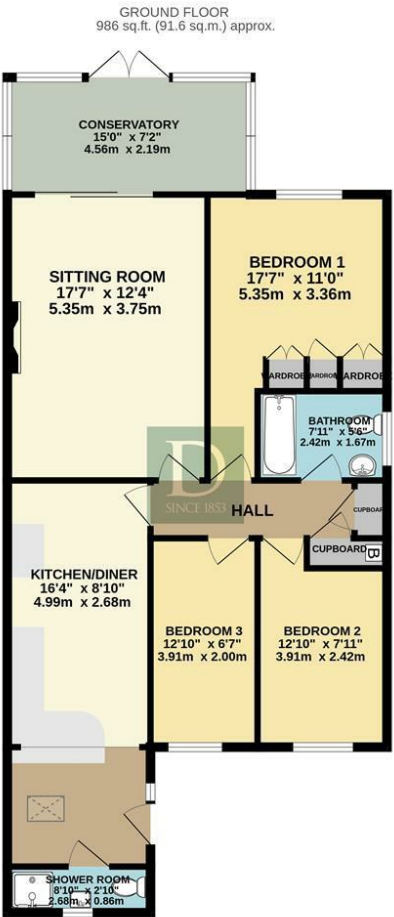

TOTAL FLOOR AREA : 986 sq.ft. (91.6 sq.m.) approx.

Whilst every attempt has been made to ensure the accuracy of the floorplan contained here, measurements of doors, windows, rooms and any other items are approximate and no responsibility is taken for any error, omission or mis-statement. This plan is for illustrative purposes only and should be used as such by any prospective purchaser. The services, systems and appliances shown have not been tested and no guarantee as to their operability or efficiency can be given.

Made with Metropix ©2024

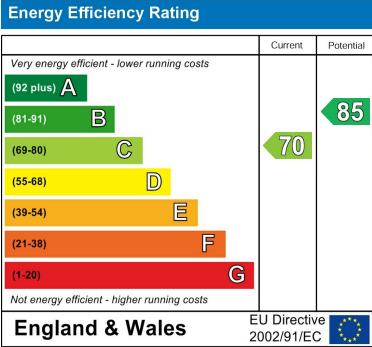

98 High Street
Southwold
Suffolk
IP18 6DP
01502 723292
southwold@durrants.com
<https://durrants.com/>