



KAREN PARKS
SALES & LETTINGS



25 Park Road

Formby, Liverpool, L37 6AA

£240,000



25 Park Road

Formby, Liverpool, L37 6AA

£240,000



ACCOMMODATION

Ground Floor

Hallway

Front Reception Room

12'8" x 10'6" (3.88 x 3.22)

Living Room

13'1" x 10'6" (3.99 x 3.22)

Kitchen

8'10" x 6'2" (2.71 x 1.88)

First Floor

Landing

Bedroom 1

12'2" x 10'6" (3.73 x 3.22)

Bedroom 2

11'7" x 10'6" (3.54 x 3.22)

Bedroom 3

6'9" x 6'2" (2.08 x 1.88)

Bathroom

6'9" x 6'2" (2.06 x 1.88)

Outside

Front Garden

Rear Garden

Garage

12'9" x 8'6" (3.90 x 2.60)

Important Information

Tel: 01704 835780



Road Map



Hybrid Map



Terrain Map

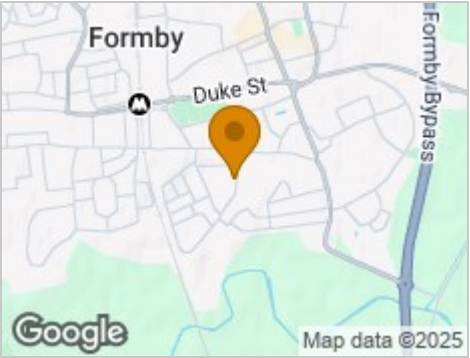

Floor Plan

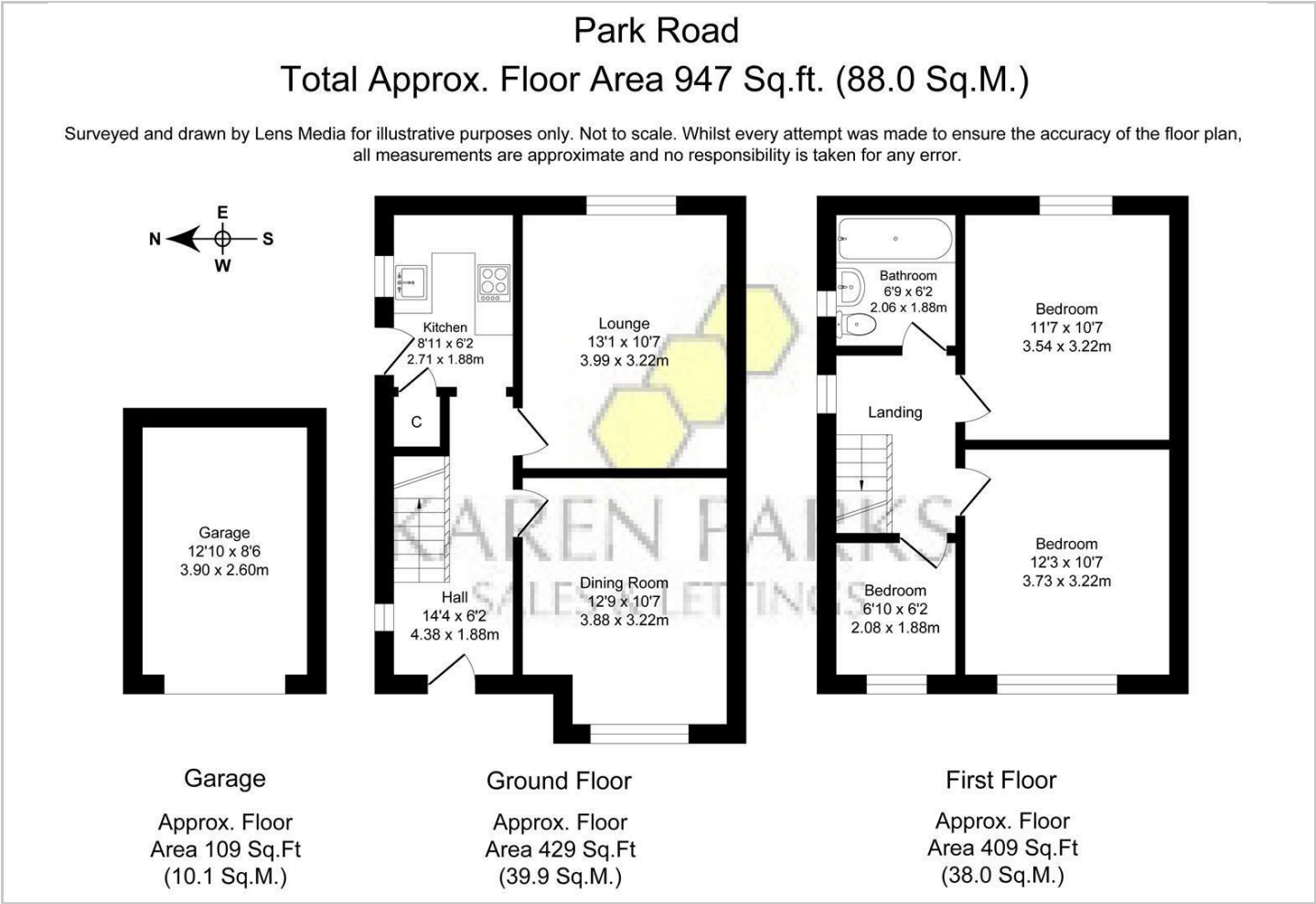

Viewing

Please contact our Formby Office on 01704 835780 if you wish to arrange a viewing appointment for this property or require further information.

Energy Efficiency Graph

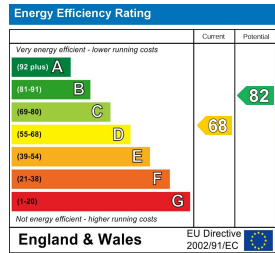

These particulars, whilst believed to be accurate are set out as a general outline only for guidance and do not constitute any part of an offer or contract. Intending purchasers should not rely on them as statements of representation of fact, but must satisfy themselves by inspection or otherwise as to their accuracy. No person in this firms employment has the authority to make or give any representation or warranty in respect of the property.