



2

Bedrooms



2

Bathrooms



2

Receptions



- GORGEOUS TWO BEDROOM COUNTRY HOUSE
- NEWLY RENOVATED THROUGHOUT
- STUNNING VIEWS OVERLOOKING NEARBY BUCKNALL PARK
- SPACIOUS LOUNGE with natural wood flooring, log burner and patio doors
- BEAUTIFUL OPEN-PLAN FAMILY ROOM/KITCHEN with ample storage space, room for a dining table and patio doors leading to the garden
- CONVENIENT DOWNSTAIRS SHOWER ROOM with double shower cubicle and sleek tiling



They say 'a HOUSE is made of walls and beams, but a HOME is built with love and dreams...' Welcome to Heath HOUSE Lane, Bucknall - where your dream home is here waiting! Set on one of Bucknall's most desirable streets, this extended and beautifully renovated two-bedroom detached home on Heath House Lane offers the perfect mix of countryside charm and contemporary living - with uninterrupted views over Bucknall Park that truly set it apart. From the moment you arrive, you'll be impressed by the spacious block-paved driveway, offering parking for up to nine vehicles - ideal for entertaining or family life. The home's sleek silicone render not only adds curb appeal but also ensures a durable, weatherproof finish that will stand the test of time. Step inside to a bright, spacious hallway, complete with two storage cupboards and a striking natural wood staircase that sets the tone of the quality found throughout. The lounge is both cosy and full of light, with natural waterproof flooring, a charming log burner feature, three windows, and patio doors leading to the showstopping rear extension. The extended living space is truly the heart of the home - tiled floors, a pitched roof, and plenty of natural light create a warm and open atmosphere. There's room here for a family seating area, a dining table, and a well-planned kitchen with ample cupboard storage. Whether you're cooking or simply doing the dishes, you'll be treated to a stunning garden and park views from the window. Patio doors lead directly to the garden, bringing the outside in. Also on the ground floor is a stylish wet room, complete with double shower cubicle and elegant tiling, plus a separate laundry room, perfectly positioned to house noisy appliances and keep the rest of the home peaceful. Upstairs, you'll find two generous double bedrooms, both offering breathtaking views across Bucknall Park. The family bathroom is modern and serene, featuring sleek vanity units, a bathtub with overhead shower, and an additional storage cupboard on the landing. Outside, the garden continues to impress with a beautiful Indian stone patio, step leading down to a block paved patio, and a well-kept lawn framed by decorative flower beds and shrubs - a peaceful, private retreat with a view you'll never tire of. And to top it all off, the home is equipped with owned solar panels, helping you save on energy bills and reduce your carbon footprint. This is more than just a house - it's a lifestyle. Homes like this on Heath House Lane rarely come to market. Don't miss this chance to make it yours. Contact Samuel Makpeace Today!



Ground Floor



First Floor

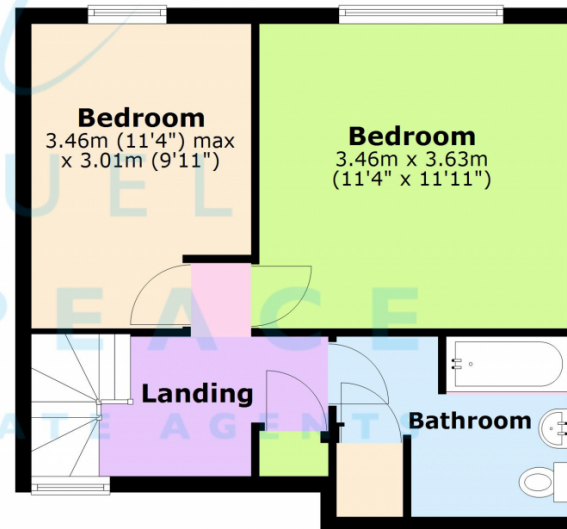

Energy Efficiency Rating		
	Current	Potential
Very energy efficient - lower running costs		
(92+) A		
(81-91) B		
(69-80) C	80	83
(55-68) D		
(39-54) E		
(21-38) F		
(1-20) G		
Not energy efficient - higher running costs		
England, Scotland & Wales		EU Directive 2002/91/EC

Address: Heath House Lane, Bucknall, Stoke-on-Trent

Scan me for more info

