



 **3**
Bedrooms

 **1**
Bathroom

 **2**
Receptions

SAMUEL
MAKEPEACE
BESPOKE ESTATE AGENTS



- **RECENTLY RENOVATED THROUGHOUT**
- **SPACIOUS LOUNGE/DINER** with bay window and sliding patio doors
- **MODERN FITTED KITCHEN** with integrated dishwasher
- **THREE GREAT SIZED BEDROOMS**
- **STUNNING SHOWER ROOM** with tiled flooring
- **LOW MAINTENANCE, SOUTH FACING REAR GARDEN** with patio area and lawn
- **SINGLE GARAGE** with power/lighting
- **PAVED DRIVEWAY** for two vehicles
- **SOLD WITH NO UPWARD CHAIN**



'What a Wonderful World'...and an even better home! Set in the highly sought-after Caton Crescent, Milton, this beautiful three bedroom link-detached home is ready for its next owner - sold with no upward chain for a hassle free move. With stunning views, stylish interior, and great outdoor space, this is a home that truly hits all the right notes. Step into a large, inviting hallway to find out exactly what this gorgeous home has to offer. The spacious open-plan lounge/diner is filled with natural light, thanks to a large bay window and sliding patio doors that open onto the garden. The modern kitchen is both stylish and practical, featuring a bespoke ceramic sink and integrated dishwasher for effortless living. Upstairs, you'll find three generously sized bedrooms, with the second bedroom offering stunning views. The contemporary shower room is finished to a high standard, complete with tiled flooring and a luxurious double shower cubicle. Step outside to enjoy the low-maintenance, SOUTH facing garden, featuring a patio area and steps leading to a neat lawn - perfect for relaxing in the summer or entertaining. A single garage with power/electricity, along with a paved driveway for two vehicles, adds the final touch to this must-see home. Don't let this one slip away! Contact Samuel Makepeace Bespoke Estate Agents Today!



Ground Floor

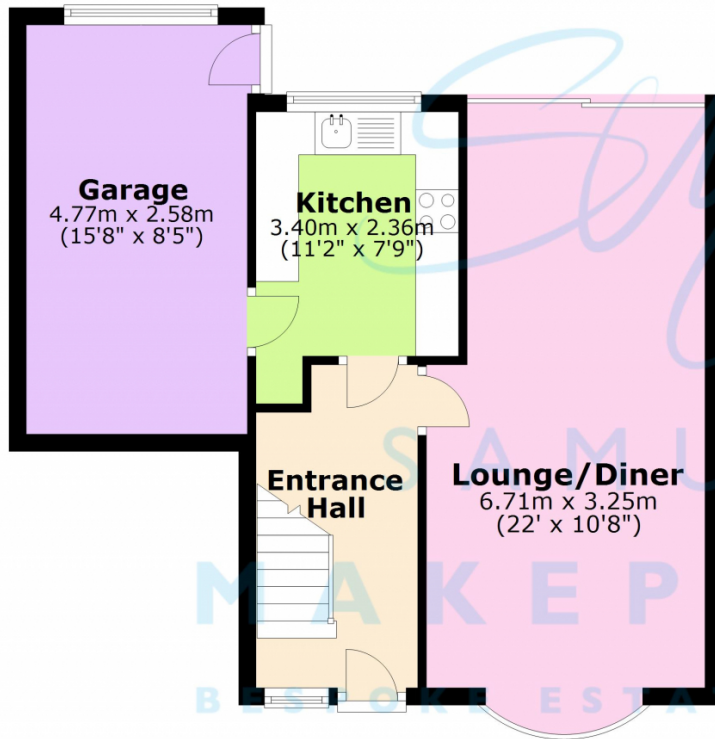

First Floor

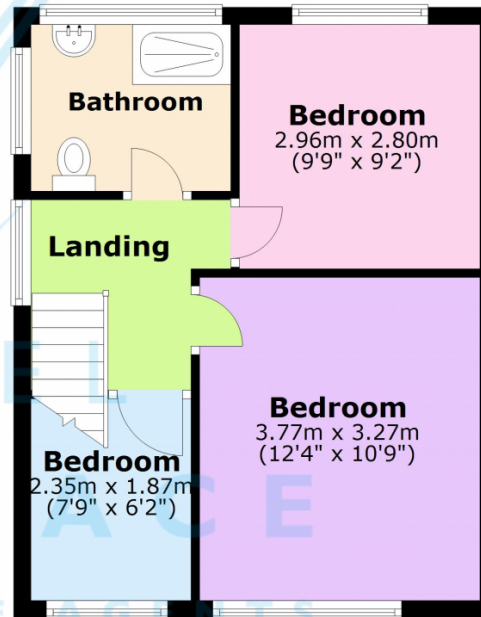

Scan me for more info

