



 **3**
Bedrooms

 **1**
Bathroom

 **2**
Receptions

SAMUEL
MAKEPEACE
BESPOKE ESTATE AGENTS



- STUNNING PERIOD TERRACE
- PERIOD CHARACTERISTICS WITH MODERN TWIST
- TWO RECEPTION ROOMS, ONE WITH OPEN FIREPLACE
- OPEN CONCEPT KITCHEN DINER
- CONSERVATORY EXTENTION & WC
- THREE GREAT SIZED BEDROOMS
- FIRST FLOOR CHIC BATHROOM
- LOW MAINTENACE REAR GARDEN with FIELDS SURROUNDING
- HIGHLY SOUGHTER AFTER AREA



Is it a bird? Is it a plane? No, it's your future home on RAVENS LANE! Welcome to this charming terraced property nestled in the heart of Bignall End, located on Ravens Lane. Combining timeless period elegance with modern comforts, this three-bedroom home boasts stunning original features such as intricate fireplaces and beautiful MINTON TILED flooring in the hallway, perfectly blending character with contemporary style. Upon entering, you'll be greeted by the first reception room, currently used as the living room. It's bright, airy, and full of charm, with a cozy fire adding warmth to the space. Flowing seamlessly into the second reception room, this flexible space can serve as a children's playroom, a FAMILY LOUNGE, or even a formal dining room – the choice is yours. The CONTEMPORAY KITCHEN is every chef's dream! With its open-plan layout, it offers plenty of space for a dining table, making it the heart of the home – perfect for gatherings and family time. Velux windows and a bay window flood the space with natural light, creating a warm and inviting atmosphere. Adjacent to the kitchen is a handy extension, currently used as a separate utility room, enhancing the property's practical appeal. The ground floor is completed by a convenient WC. Upstairs, you'll find THREE BEDROOMS, including a master retreat with breathtaking views over the surrounding fields. The additional bedrooms are ideal for children, guests, or even a home office. The CHIC BATHROOM features both a bath and an overhead shower, adding to the home's luxurious feel. Outside, the property continues to impress with well-maintained lawn areas, and with fields behind, it offers a tranquil oasis. The front of the home is set back from the road, with grand steps leading to the entrance of your dream home! Don't miss the opportunity to make this stunning property yours. Contact Samuel Makepeace Bespoke Estate Agents today!

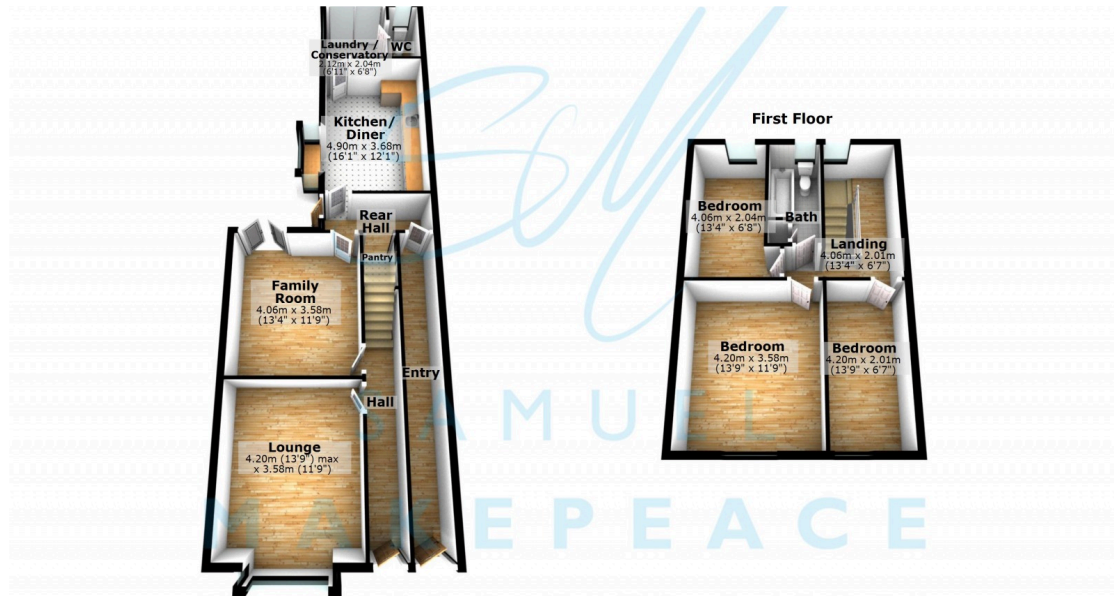



We accept no responsibility for any mistake or inaccuracy contained within the floorplan. It is provided as a guide only, and should be deemed an illustration only. The plan is not to scale, and does not suggest the correct positioning of any item within its contents. Samuel Makepeace Bespoke Estate Agents 01782 914 444. Plan produced using PlanUp.



Scan me for more info

