



## Molyneux Drive, SW17

**£1,600 PCM**

A one bedroom apartment in a private development, suitable for a professional single occupant or a professional couple.

- Purpose Built
- One Bedroom
- Modern Kitchen
- Bathroom Suite
- Close To Station
- Private Development

For further information on the costs associated with renting a property, please pop into our office or visit our website.



Molyneux Drive is located within minutes of Tooting Bec Northern line station, and also benefits from off street parking.





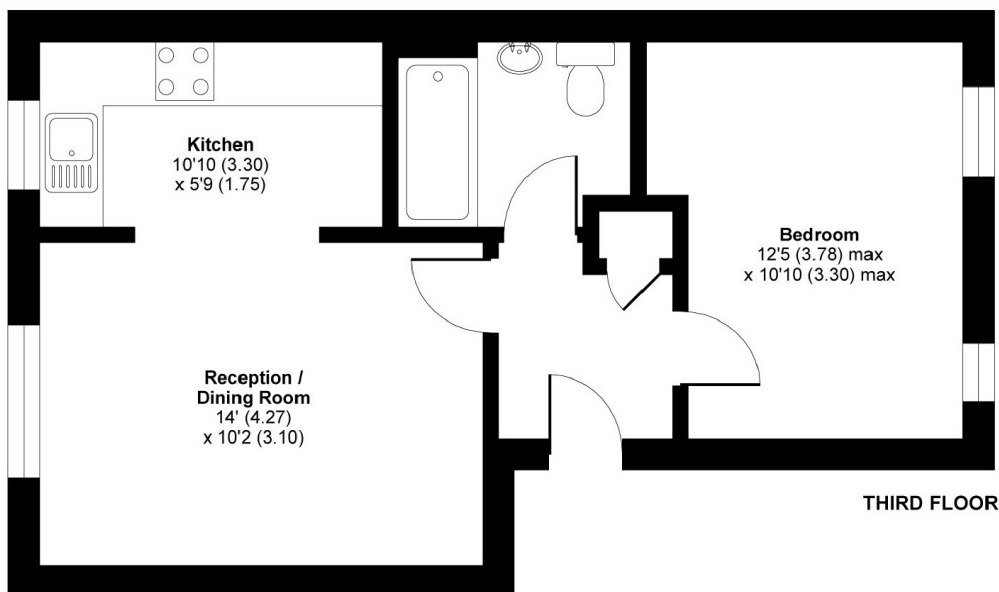

APPROX. GROSS INTERNAL FLOOR AREA 420 SQ FT 39 SQ METRES

**Molyneux Drive, London, SW17**

Copyright nichecom.co.uk 2018 Produced for Jacksons the Independent Estate Agents REF : 239092

Jacksons Tooting  
26 Tooting Bec Road  
London  
SW17 8BD  
020 8767 0522  
tooting.lettings@jacksonsestateagents.com

Energy Rating: C We aim to make our particulars both accurate and reliable. However they are not guaranteed; nor do they form part of an offer or contract. If you require clarification on any points then please contact us, especially if you're traveling some distance to view. Please note that appliances and heating systems have not been tested and therefore no warranties can be given as to their good working order.