



MITCHAM LANE, SW16

£500,000

- Two Bedrooms
- Private Garden
- Excellent Condition
- Victorian Conversion
- Close To Transport Links
- Energy Rating: D





ABOUT THE HOME

A charming Victorian ground floor conversion featuring a generous private garden and a separate outdoor office, perfect for maximising indoor living space. The property boasts an abundance of period features throughout.

Mitcham Lane is located in Furzedown, a highly desirable area between Tooting and Streatham. Links into the city are available via a short walk to Streatham Common Overground Station, or a small commute to Tooting Broadway Tube. There are many bus links near by offering services through Tooting, Streatham, Mitcham Lane is also nearby many great local amenities.





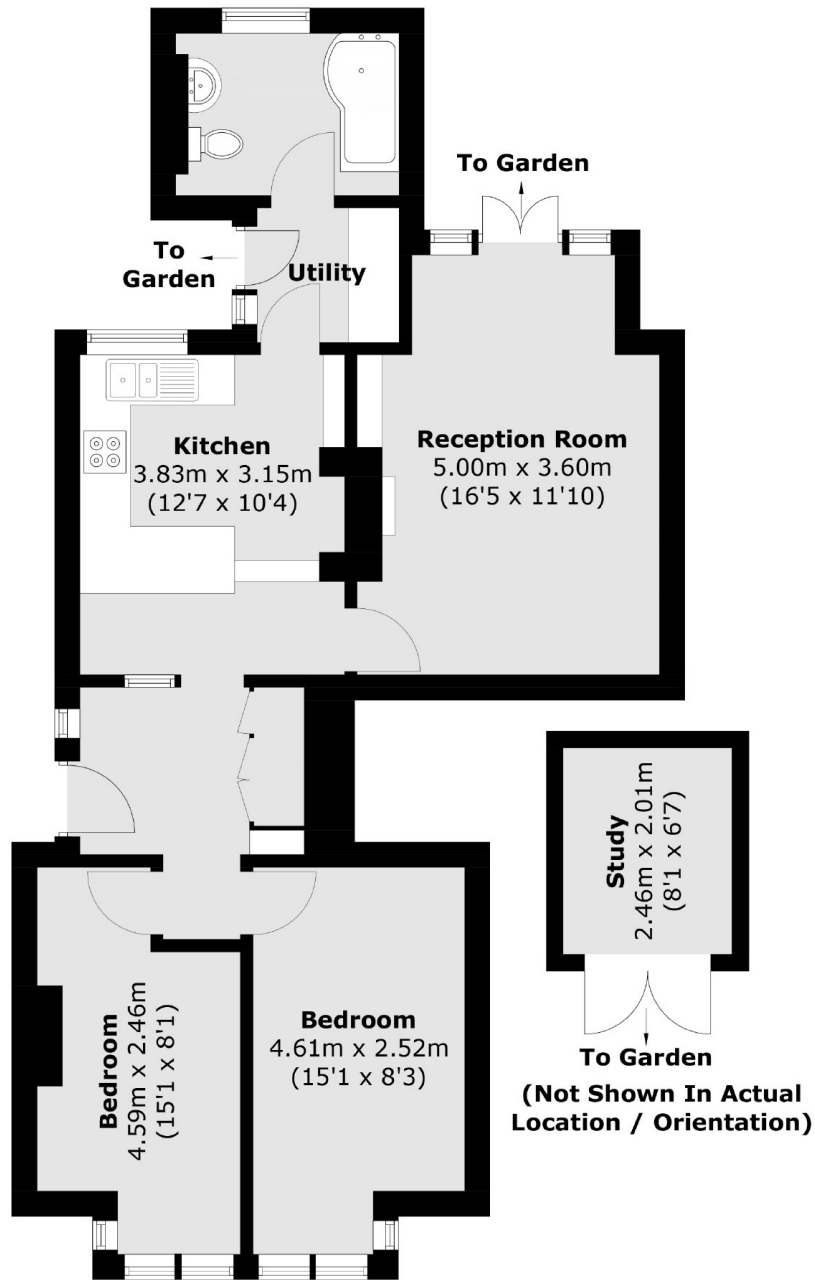

Ground Floor

Approx Internal Area: 66.1 sq. m (711.5 sq. ft)
Study: 4.9 sq. m (52.7 sq. ft)

JACKSONS TOOTING

3 Upper Tooting Road, London,
SW17 7TS
Sales: 020 8487 3175
Lettings: 020 8487 3176

Energy Rating: We aim to make our particulars both accurate and reliable. However they are not guaranteed; nor do they form part of an offer or contract. If you require clarification on any points then please contact us, especially if you're traveling some distance to view. Please note that appliances and heating systems have not been tested and therefore no warranties can be given as to their good working order.