



TREVELYAN ROAD, SW17

£700,000

- Private South Facing Garden
- Share Of Freehold
- Large Reception Area
- Two Double Bedrooms
- First Floor Maisonette
- Highly Sought After Road





ABOUT THE HOME

A spacious first floor Victorian maisonette that has an immaculate finish throughout. The internal layout comprises of two double bedrooms, large reception room, a beautifully decorated bathroom and a well laid out kitchen, which provides access to the landscaped south facing garden.

Located on a popular road in Tooting, this property is well situated for easy access to an array of shops, bars and restaurants on offer. The wide open spaces of Tooting Bec Common are also close by, as are the excellent transport links including Tooting Station and Tooting Broadway Underground Station.





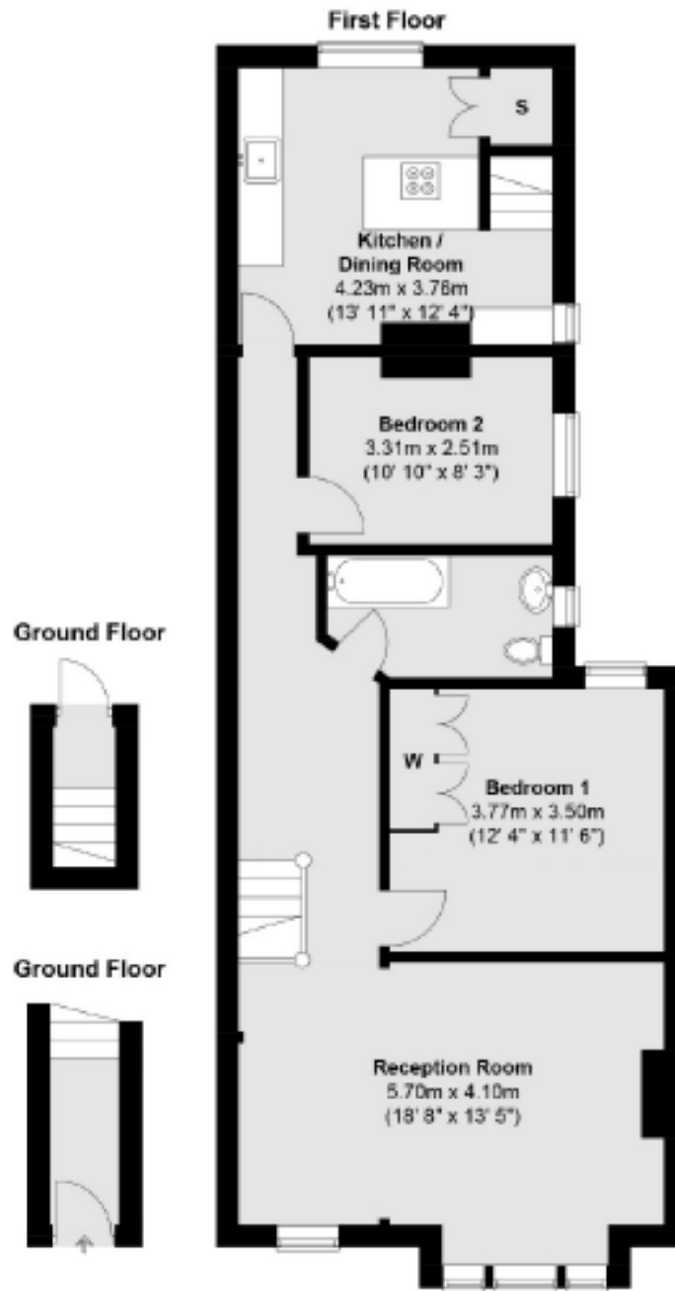

Total area (approx.) : 85.9 sq. m (924 sq. ft)

JACKSONS TOOTING

3 Upper Tooting Road, London,
SW17 7TS
Sales: 020 8487 3175
Lettings: 020 8487 3176

Energy Rating: We aim to make our particulars both accurate and reliable. However they are not guaranteed; nor do they form part of an offer or contract. If you require clarification on any points then please contact us, especially if you're traveling some distance to view. Please note that appliances and heating systems have not been tested and therefore no warranties can be given as to their good working order.