



UPPER TOOTING ROAD, SW17

£475,000

- Two Bedroom
- Close To Tube Station
- Private Balcony
- Gated Development
- Off-Street Parking with allocated parking
- EPC Rating: B





ABOUT THE HOME

A stunning two-bedroom, two-bathroom flat in a highly sought-after location, just a stone's throw away from Tooting Bec tube station with an array of local amenities right on your doorstep. Nestled within a secure gated development, this apartment offers stylish, contemporary living in the highly desirable area of Tooting Bec.

This second-floor flat at the rear of the building enjoys a quiet location. It boasts a double bedroom with en-suite, built-in wardrobe and private balcony. The second bedroom is currently used as a study. The flat has recently been updated, including a new family bathroom, boiler and oven.

Whitham court is perfectly positioned in the heart of Tooting offering excellent transport links via Tooting Bec, Tooting Broadway and Balham stations. It is also within close proximity to well-regarded schools and an abundance of popular restaurants and shops, making it an ideal home for those seeking both convenience and vibrant city living.





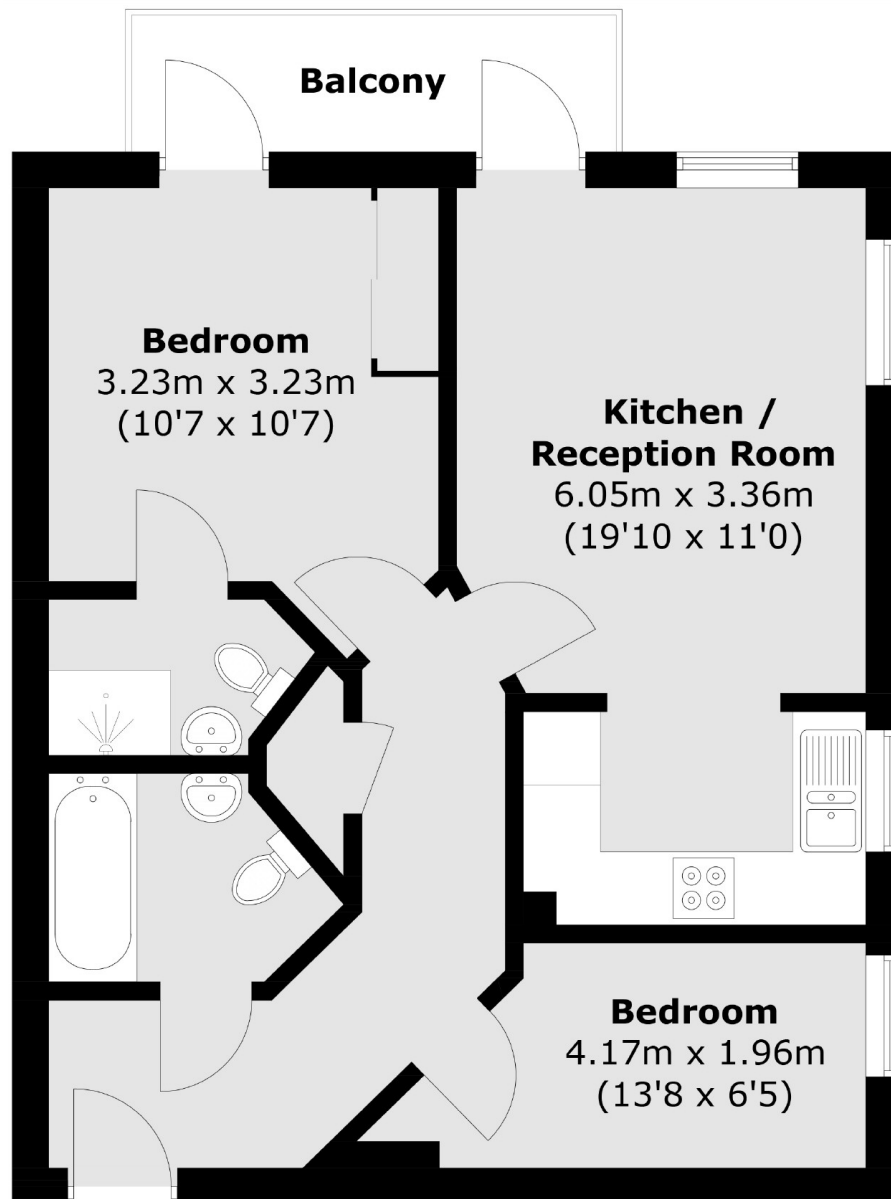

Total area (approx.): 54.4 sq. m (585.5 sq. ft)
Balcony: 4.4 sq. m (47.3 sq. ft)

JACKSONS TOOTING

3 Upper Tooting Road, London,
SW17 7TS
Sales: 020 8487 3175
Lettings: 020 8487 3176

Energy Rating: We aim to make our particulars both accurate and reliable. However they are not guaranteed; nor do they form part of an offer or contract. If you require clarification on any points then please contact us, especially if you're traveling some distance to view. Please note that appliances and heating systems have not been tested and therefore no warranties can be given as to their good working order.