



HENRY DOULTON DRIVE, SW17

£425,000

- Two Double Bedrooms
- Large Sitting Room
- Modern Kitchen
- Well Appointed Bathroom
- Residents Parking
- Close to Tooting Bec Common



2



1



1



ABOUT THE HOME

A beautifully presented, neutrally decorated two-bedroom apartment, located in the sought-after Heritage Park development. This bright and airy property enjoys abundant natural light throughout and offers convenient access to the amenities of both Balham and Tooting Bec.

Accommodation comprises: entrance hall giving access to all rooms, two double bedrooms, living room leading to a newly fitted kitchen and modern bathroom. The property further benefits from ample storage and residential permit parking.

Henry Doulton Drive forms part of Heritage Park which has well kept communal areas, communal bike storage and an on site caretaker. Heritage Park is a sought after modern development located in Tooting Bec, ideally positioned for access in and out of Central London, as well as providing easy access to both Tooting underground (Northern Line) and Tooting overground stations. The location also benefits from fantastic bus links and easy access to the shopping, dining and entertainment facilities of Tooting and Balham's underground and overground station and its amenities on the high road are also within a short distance.





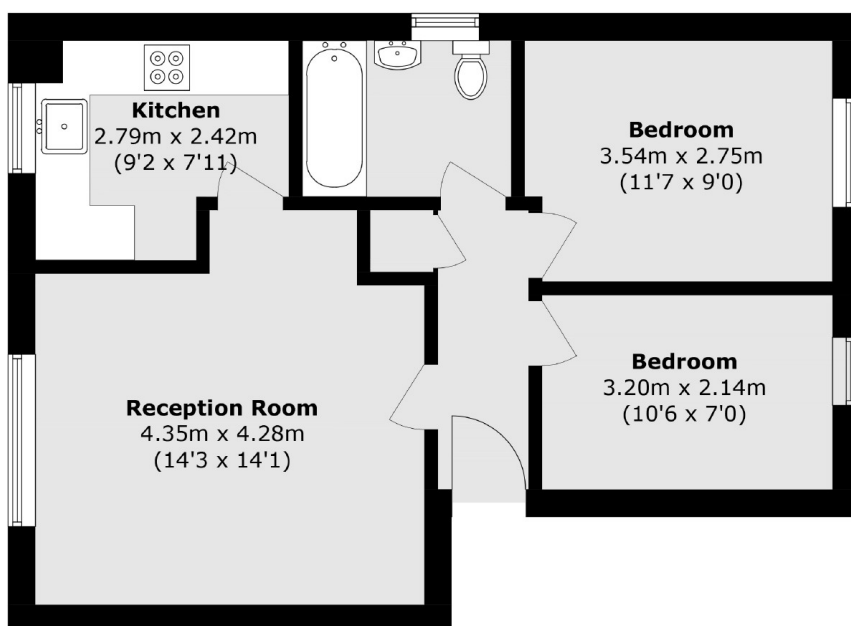

Total area (approx.): 48.9 sq. m (526.4 sq. ft)

JACKSONS TOOTING

3 Upper Tooting Road, London,

SW17 7TS

Sales: 020 8487 3175

Lettings: 020 8487 3176

Energy Rating: We aim to make our particulars both accurate and reliable. However they are not guaranteed; nor do they form part of an offer or contract. If you require clarification on any points then please contact us, especially if you're traveling some distance to view. Please note that appliances and heating systems have not been tested and therefore no warranties can be given as to their good working order.