



GATTON ROAD, SW17

£750,000

- Freehold Victorian House
- Three Bedrooms
- Private South Facing Garden
- Freehold
- Chain Free
- Potential to Extend (STPP)





ABOUT THE HOME

A three bedroom Victorian family home on a popular residential road in Tooting Broadway with a private south facing garden, no onward chain and potential to extend (STP).

Gatton Road is ideally situated for Tooting Broadway Underground station. The green open spaces of both Wandsworth Common and Tooting Bec Common are easily accessible as is the shops, bars and restaurants that both of these areas have to offer. In particular being opposite the buzzing Tooting Broadway Market, one of south London's oldest markets.





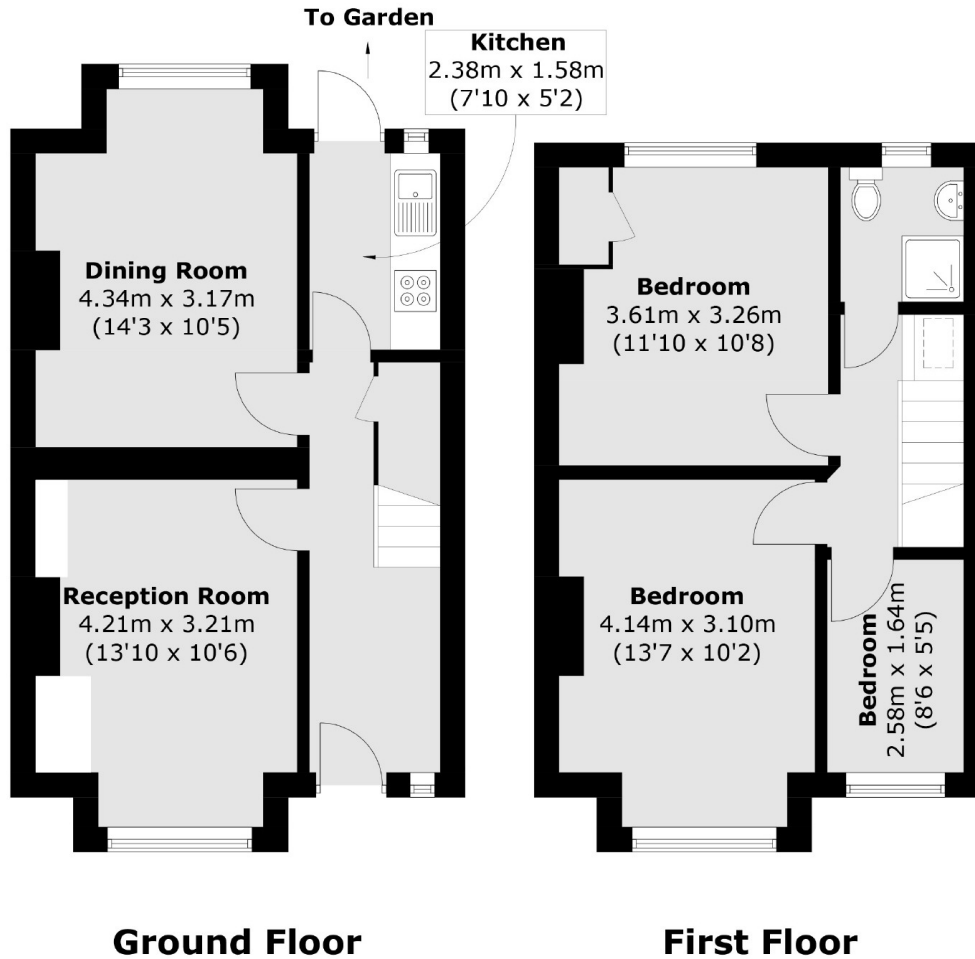

Total area (approx.): 77.0 sq. m (828.8 sq. ft)

JACKSONS TOOTING

3 Upper Tooting Road, London,
SW17 7TS
Sales: 020 8487 3175
Lettings: 020 8487 3176

Energy Rating: We aim to make our particulars both accurate and reliable. However they are not guaranteed; nor do they form part of an offer or contract. If you require clarification on any points then please contact us, especially if you're traveling some distance to view. Please note that appliances and heating systems have not been tested and therefore no warranties can be given as to their good working order.