



MOLYNEUX DRIVE, SW17

£275,000

- Studio Apartment
- Well Appointed Bathroom
- Stylishly Presented
- Residents Parking
- Modern Kitchen
- Long Lease





ABOUT THE HOME

A charming studio apartment, located in the highly sought after Heritage Park development. Stylishly presented and located within moments of Tooting Bec Common, Tooting Bec Tube and a number of bars and restaurants.

Molyneux Drive forms part of Heritage Park which boasts well kept communal areas, communal bike storage and an on site caretaker. Heritage Park is a sought after modern development located in Tooting Bec close to the amenities of both Balham and Tooting and the open spaces of the Tooting Bec Common.





Second Floor

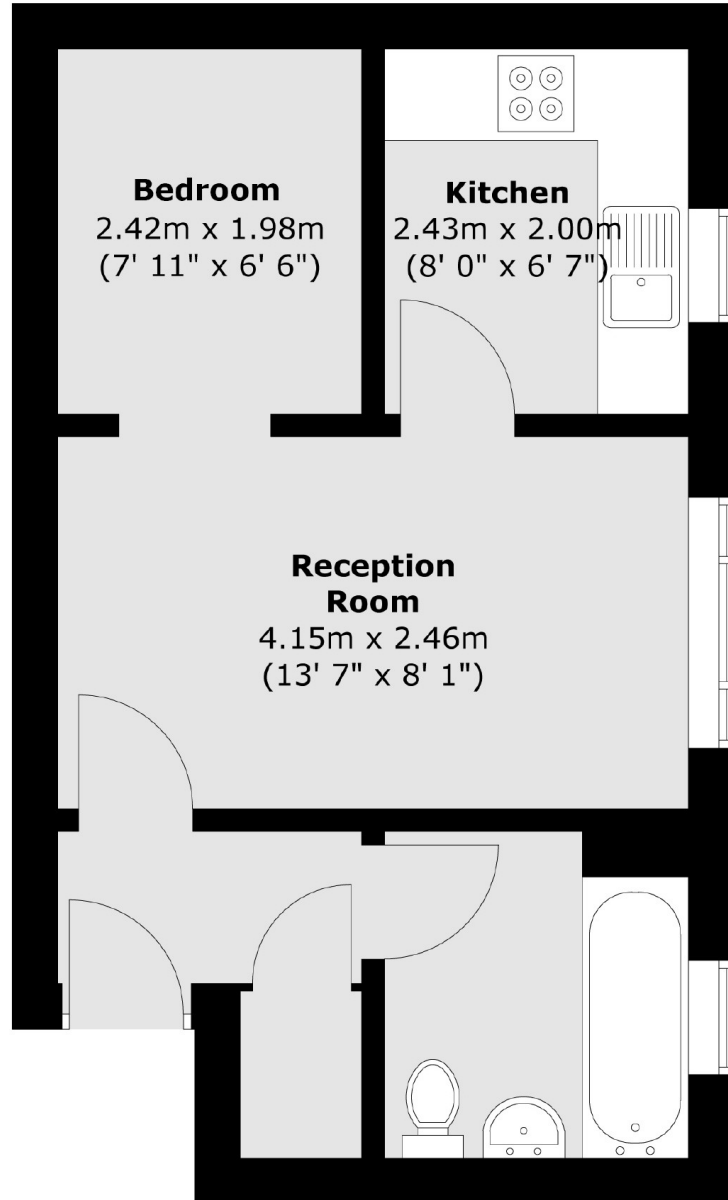

Total area (approx.) : 29.1 sq. m (313 sq. ft)

JACKSONS TOOTING

3 Upper Tooting Road, London,
SW17 7TS
Sales: 020 8487 3175
Lettings: 020 8487 3176

Energy Rating: We aim to make our particulars both accurate and reliable. However they are not guaranteed; nor do they form part of an offer or contract. If you require clarification on any points then please contact us, especially if you're traveling some distance to view. Please note that appliances and heating systems have not been tested and therefore no warranties can be given as to their good working order.