



Langroyd Road, SW17

£4,500 PCM

This five bedroom, new build home is decorated to a neutral standard. The property benefits from four bathrooms, a modern kitchen breakfast room and a private garden making it perfect for a family or professional

- Reception Room
- Modern Kitchen
- Five Bedrooms
- four Bathrooms
- Private Garden
- Close to Station

For further information on the costs associated with renting a property, please pop into our office or visit our website.



The property includes a large reception room with doors leading onto patio garden, modern kitchen breakfast room, five double bedrooms, downstairs W.C , four bathrooms and off street parking.

Langroyd Road is ideally situated within a short distance of Wandsworth Common mainline and Tooting Bec northern line stations as well as the shops, bars and restaurants close by.



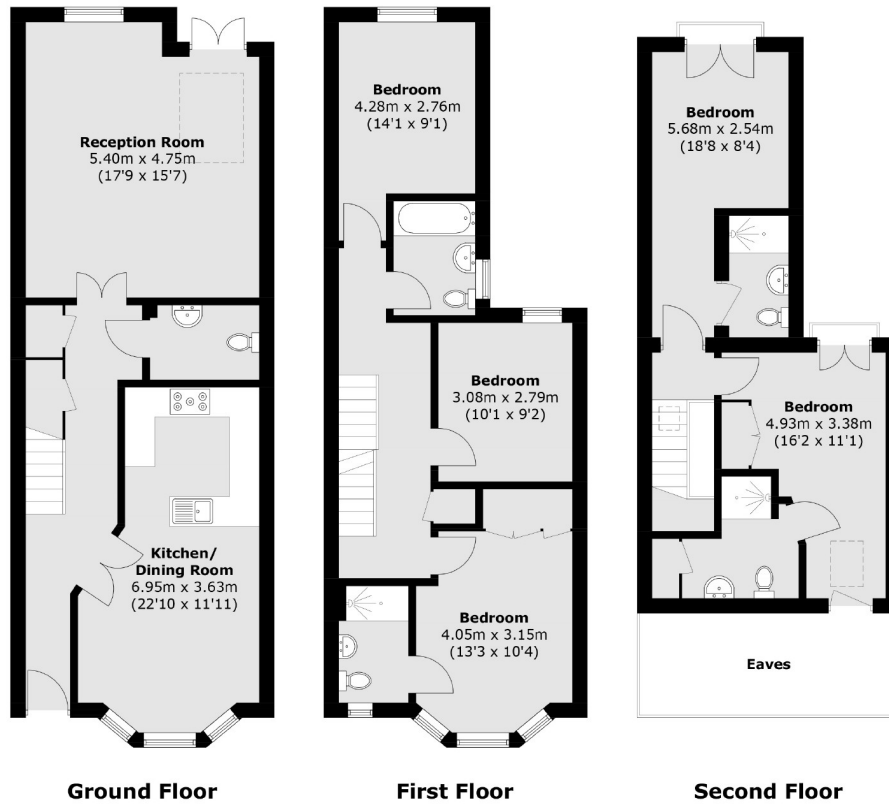

Total area (approx.): 158.7 sq. m (1,708.3 sq. ft)
(Excluding Eaves)

Jacksons Tooting
26 Tooting Bec Road
London
SW17 8BD
020 8767 0522
tooting.lettings@jacksonsestateagents.com

Energy Rating: We aim to make our particulars both accurate and reliable. However they are not guaranteed; nor do they form part of an offer or contract. If you require clarification on any points then please contact us, especially if you're traveling some distance to view. Please note that appliances and heating systems have not been tested and therefore no warranties can be given as to their good working order.