

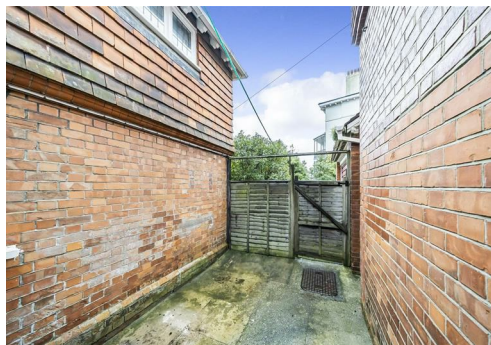

---

Curlew





Torquay 10 miles Totnes 11 miles Exeter  
39 miles

A rare opportunity to purchase a two bedroom ground floor apartment in a historical property in the heart of the picturesque village of Kingswear.

- No onward chain
- Ground floor apartment
- Heart of the village
- Ideal investment
- Courtyard
- Holiday let potential
- Leasehold
- EPC E / Council tax A



### SITUATION

Kingswear sits on the sunny east bank of the River Dart opposite the historic port of Dartmouth and home to the Britannia Royal Naval College. The village is one of the most picturesque in the South Hams offering two popular pubs, a tapas wine bar, coffee shop, post office, village shop, primary school and a church. Kingswear is popular with the sailing community and offers excellent marina facilities, deep-water moorings and is home to the Royal Dart Yacht Club. There is plenty to do in the area with the South West footpath on your doorstep, an abundance of beaches, coves and golf courses nearby. A seasonal steam train service operates to Paignton whilst a regular bus service links to the towns in Torbay. A 5-minute passenger or car ferry ride and you arrive in the historic town of Dartmouth with its wide range of shops and restaurants. The South Devon Expressway (A380) is 12 miles away and provides speedy access to Exeter and the country beyond whilst main line rail links to London Paddington can be made in Totnes and Newton Abbot.

### DESCRIPTION

Curlew forms part of Longford Cottage is an attractive, red brick dwelling situated in a prime position in the heart of the picturesque village of Kingswear and only a stones throw from the River Dart. The property is currently divided into two separate apartments but was once the stables for Longford House. Longford House was home to French Naval Officers during WWII including Philippe de Gaulle, the General's son, who was a junior officer at the time and was visited by his father. Longford Cottages is only a stone's throw from the River Dart situated on the ever charming Priory Street. The location is perfect for exploring the surrounding coast and countryside with the coastal path being nearby and also a slipway offers direct access from Priory Street to the river Dart.

The accommodation is accessed from the shared courtyard is the front door which leads to the entrance hall which is open to the kitchen. The kitchen has a range of units as well as space for an electric oven, fridge and washing

machine. A door opens from the kitchen to a separate enclosed courtyard area. Next to the kitchen is the sitting/dining room which is of a good size offering plenty of space for sitting and dining furniture. Leading from the sitting room are two bedrooms, one will accommodate a double bed and the other a single. The apartment is served by a shower room with corner shower, WC and wash hand basin.

### OUTSIDE

Accessed from the kitchen of Curlew is an enclosed courtyard which is ideal for alfresco dining.

### TENURE

Leasehold with a share of the freehold - a new 999 year lease will be granted upon completion.

### SERVICES

Mains electricity, water and drainage. Electric radiators throughout. Superfast broadband available at this location and various mobile networks are available at this location (information provided by Ofcom)

### LOCAL AUTHORITY

South Hams District Council, Follaton House, Plymouth Road, Totnes, Devon, TQ9 5NE. Tel 01803 861234. E-mail [customer.services@southhams.gov.uk](mailto:customer.services@southhams.gov.uk).

### VIEWING

Strictly by prior appointment with Stags on 01803 835336.

### DIRECTIONS

From The Square (lower/pedestrian ferry) proceed towards the Post Office and Priory Street where you will find the property a short distance on the right hand side.

Guide Price £225,000



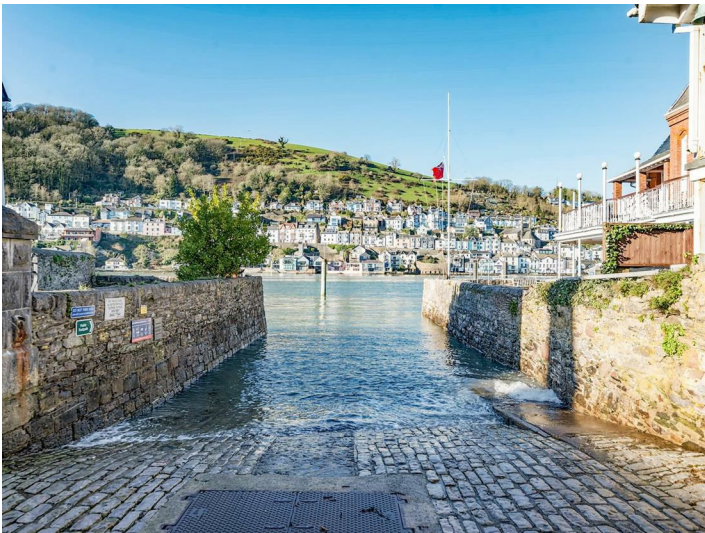



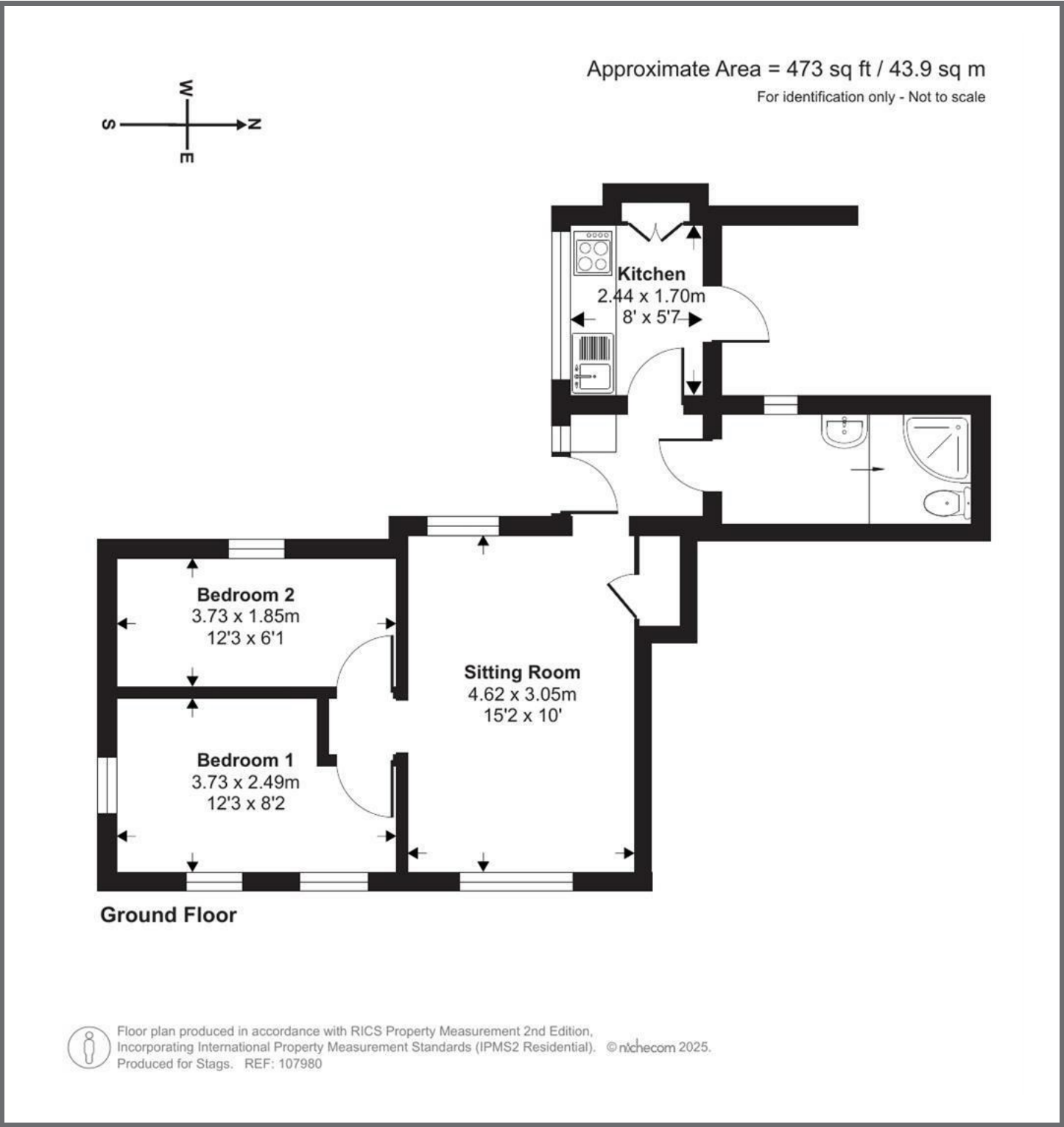

IMPORTANT: Stags gives notice that: 1. These particulars are a general guide to the description of the property and are not to be relied upon for any purpose. 2. These particulars do not constitute part of an offer or contract. 3. We have not carried out a structural survey and the services, appliances and fittings have not been tested or assessed. Purchasers must satisfy themselves. 4. All photographs, measurements, floorplans and distances referred to are given as a guide only. 5. It should not be assumed that the property has all necessary planning, building regulation or other consents. 6. Whilst we have tried to describe the property as accurately as possible, if there is anything you have particular concerns over or sensitivities to, or would like further information about, please ask prior to arranging a viewing.

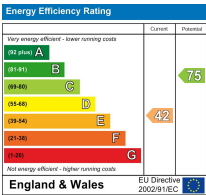

9 Duke Street, Dartmouth, Devon, TQ6 9PY

01803 835336

dartmouth@stags.co.uk

stags.co.uk