



1-4 Hollybush Place
London, E2 9QX

£2,450 PCM

elms
ESTATES

Elms Estates are delighted to bring to the market To Let this Amazing Two Double Bedroom Apartment Located in the Heart of Bethnal Green.

Hollybush Place is located just off Bethnal Green Road within walking distance to Bethnal Green Underground & Overground stations but also with multiple bus routes in to the City, West End and beyond and additionally the Glorious Victoria Park is within a short walk and offers Beautiful Open Spaces and Miles of Scenic Walks. The Relaxed, Cool Feel of Victoria Park Farmers Market will make for wonderful lazy Sunday morning strolls. This property really is set within the Heart of the East End with easy access to all of the Restaurants, Bars, Shops, Markets, Gyms, Parks, Galleries and Museums this Exciting Area has on offer.

Internally the property is finished to a high standard with under floor heating throughout and herringbone floors to the hallway, bedrooms and living space. Offering a very spacious open plan kitchen and living space, two double bedrooms and modern bathroom. The property is AVAILABLE to move in to from 12 July 2025 Onwards.

For more information or to arrange a viewing please do not hesitate to call in and speak with one of our Property Consultants.



Living Space/Kitchen 21'0" x 13'5" (6.40m x 4.09m)



Bedroom One 11'2" x 10'2" (3.40m x 3.10m)



Material Information

Deposit: £2,826.92

Length Of Tenancy: One Year

Council Tax Band: B

Bedroom Two 9'6" x 8'2" (2.90m x 2.49m)



Bathroom





Hollybush Place, E2

Approx. Gross Internal Area 635 Sq Ft - 58.99 Sq M

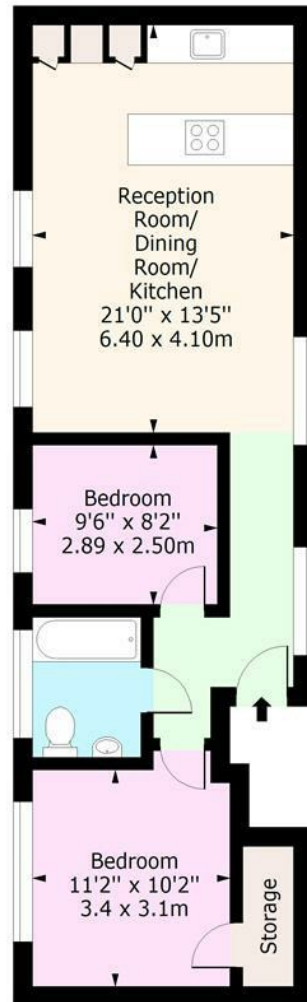

First Floor

Floor Area 635 Sq Ft - 58.99 Sq M

For Illustration Purposes Only - Not To Scale
www.lpaplus.com

