



elms
65 Voss Street
London, E2 6HP
£1,800 PCM

elms
ESTATES

Elms Estates are pleased to be able offer to the Rental Market this One Double Bedroom apartment arranged over two floors

Voss Street is situated within a short walk of either Bethnal Green (Central Line) Tube Station or Bethnal Green London Overground Station. You are also located just next to Weavers Field Recreation Ground offering open spaces and just behind Bethnal Green Road with all possible local amenities.

Internally the property offers wood laminate or tiled floors throughout, Gas Central Heating, Double Glazing along with a modern kitchen and shower room. The property is available to move in to immediately.

For more information or to arrange a viewing please do not hesitate to call in and speak with one of our property consultants.



Reception/Kitchen Area 25'4" x 13'4" (7.74 x 4.08)



Bedroom One 18'1" x 12'10" (5.52 x 3.92)



Shower Room 6'5" x 6'0" (1.97 x 1.85)



Material Information

Deposit: £2,076.92

Length Of Tenancy: One Year

Council Tax Band: C





Voss Street, E2



Approximate Gross Internal Area 518 sq. ft - 48.1 sq. m.

GROUND FLOOR
327 sq.ft. (30.4 sq.m.) approx.

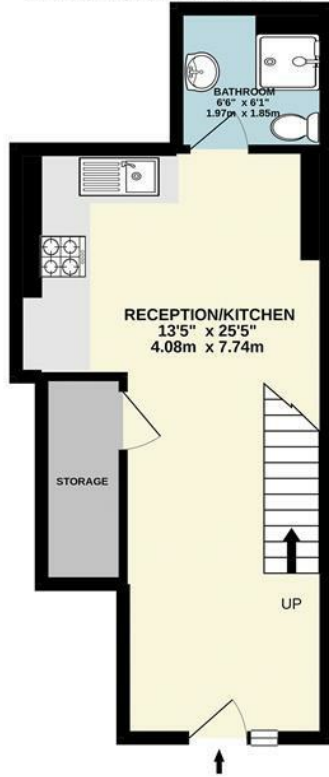

1ST FLOOR
191 sq.ft. (17.7 sq.m.) approx.

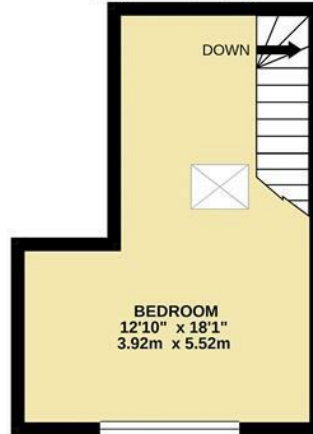

Total Floor Area 518 sq. ft. - 48.1 sq. m. Approx.

For Illustration Purposes Only - Not To Scale.
lpaplus.com

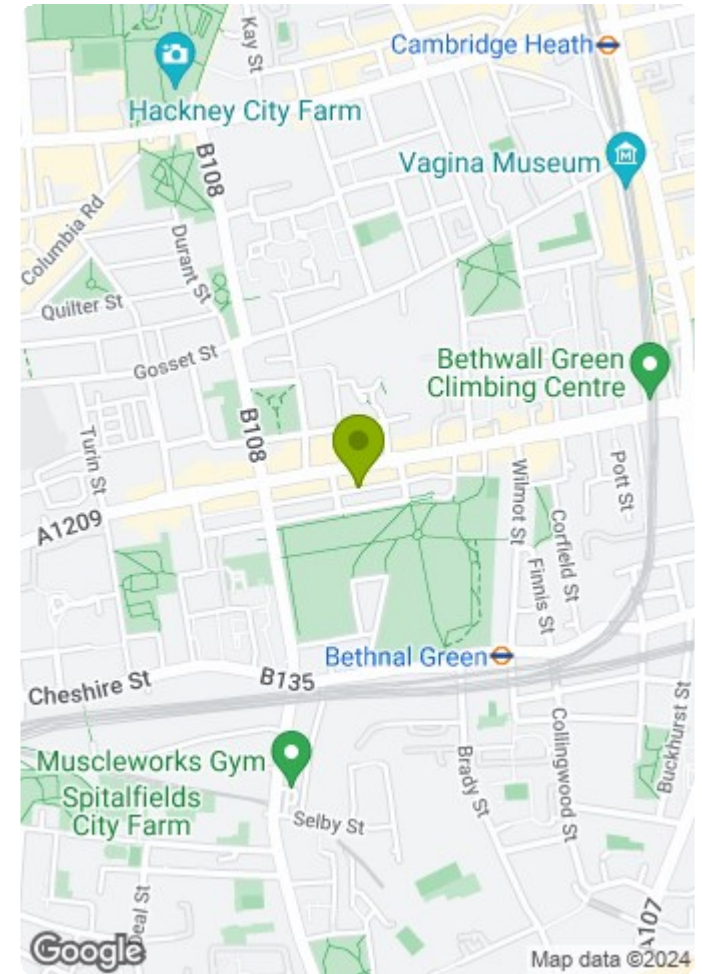

Energy Efficiency Rating		Current	Potential
Very energy efficient - lower running costs			
(92 plus) A			
(81-91) B			
(69-80) C			
(55-68) D			
(39-54) E			
(21-38) F			
(1-20) G			
Not energy efficient - higher running costs			
England & Wales	EU Directive 2002/91/EC		

Environmental Impact (CO ₂) Rating		Current	Potential
Very environmentally friendly - lower CO ₂ emissions			
(92 plus) A			
(81-91) B			
(69-80) C			
(55-68) D			
(39-54) E			
(21-38) F			
(1-20) G			
Not environmentally friendly - higher CO ₂ emissions			
England & Wales	EU Directive 2002/91/EC		