



Iron Works, LONDON, , E3 2NX £2,500 PCM

Elms Estates are pleased to offer to the market For Let this Two Double Bedroom Apartment located on the first Floor with its own balcony.

The property is situated on the trendy Fish Island and is close to Queen Elizabeth Park and Hackney Wick Station while also just being moments away from Victoria Park.

Internally the property offers a spacious and light open plan Reception/Kitchen area with access to the balcony, Two double bedrooms with bedroom one benefitting from an en-suite and a further family bathroom. The property is Available 17th May 2024

For more information or to arrange a viewing please do not hesitate to call in and speak with one of our Property Consultants.



Reception/Dining Area

Kitchen

Bedroom One
15'5" x 9'10" (4.7 x 3.0)

En-Suite

Bedroom Two
14'5" x 9'10" (4.4 x 3.0)

Bathroom

Balcony

Material Information

Deposit: £2,884.61
Length Of Tenancy: One Year
Council Tax Band: D

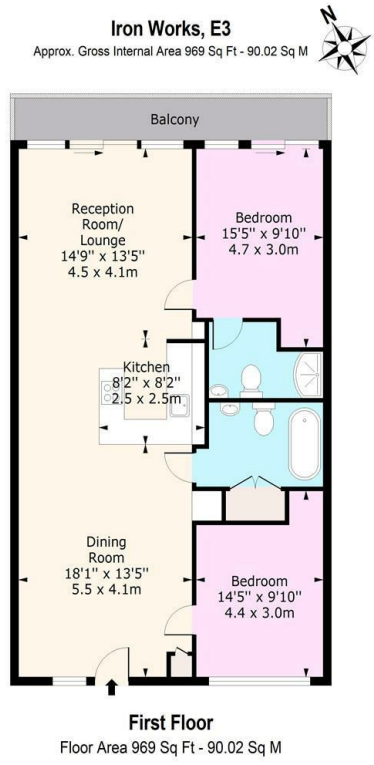

Energy Efficiency Rating		Environmental Impact (CO ₂) Rating	
Very energy efficient - lower running costs	Current	Potential	Very environmentally friendly - lower CO ₂ emissions
(92 plus) A			(92 plus) A
(81-91) B			(81-91) B
(69-80) C			(69-80) C
(55-68) D			(55-68) D
(39-54) E			(39-54) E
(21-38) F			(21-38) F
(1-20) G			(1-20) G
Not energy efficient - higher running costs			Not environmentally friendly - higher CO ₂ emissions
73	77	75	78
England & Wales	EU Directive 2002/91/EC	England & Wales	EU Directive 2002/91/EC