



Old Ford Road, London, , E2 9QE £425,000

Elms Estates are pleased to offer to the market For Sale this Three Bedroom maisonette situated just a short walk to Bethnal Green Station.

James Campbell House is situated just off of Old Ford Road within easy reach of Bethnal Green (central line) tube station with multiple bus routes in to the City, West End and beyond and additionally the glorious Victoria Park is within a short walk and offers beautiful open spaces and miles of scenic walks. The relaxed, cool feel of Victoria Park farmers market will make for wonderful lazy Sunday morning strolls and with Regents Canal also on your doorstep you will find endless new places to explore. This property really is set within the heart of the East End with easy access to all of the restaurants, bars, shops, markets, gyms, parks, galleries and museums this exciting area has on offer.

Internally the property benefits from good living space with a separate kitchen, Three good size bedrooms, Bathroom and separate w/c. The property is in good condition throughout and offered to the market on a CHAIN FREE basis.

For more information or to arrange a viewing please do not hesitate to call in and speak with one of our Property Consultants. Early viewing is recommended.



Reception

18'0" x 10'9" (5.49 x 3.30)

Kitchen

9'10" x 9'2" (3.0 x 2.8)

Bedroom One

13'5" x 9'10" (4.1 x 3.0)

Bedroom Two

11'5" x 9'10" (3.5 x 3.0)

Bedroom Three

8'10" x 7'10" (2.7 x 2.4)

Bathroom

W.C.

Material Information

Tenure: Leasehold

Length Of Lease: Approx 89 Years remaining

Annual Ground Rent: £10.00 Per year

Annual Service Charge: £4,290.94 Per year

Council Tax Band: C

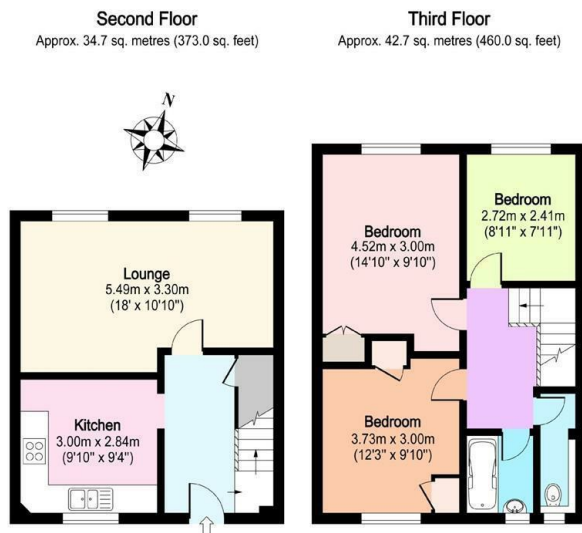

Total area, approx. 77.4 sq. metres (833.0 sq. feet)
For illustration purposes only - not to scale

