



## 49 Whittington Crescent, Wantage, OX12 9GB

£2,500 PCM - 12th December 2025.

- Four bedroom detached house
- Large garden
- Ultrafast broadband Available
- Open plan kitchen/dining room
- Off street parking for 2 cars
- Three double bedrooms
- Gas central heating

# 49 Whittington Crescent, Wantage OX12 9GB

Four bedroom detached house offering a high standard of accommodation. Comprising of open plan kitchen/dining room with gas hob, dishwasher, washing machine, fridge/freezer, sitting room, 2nd reception room/study. 3 double bedrooms, ensuite shower to bedroom one, family bathroom with shower over bath. single bedroom. Large garden, single garage which is divided off into two rooms for storage. Off street parking for 2 cars. Gas central heating.

The Ofcom Broadband Checker states there is:

- Ultrafast broadband has download speeds of greater than 300Mbps



Council Tax Band: E





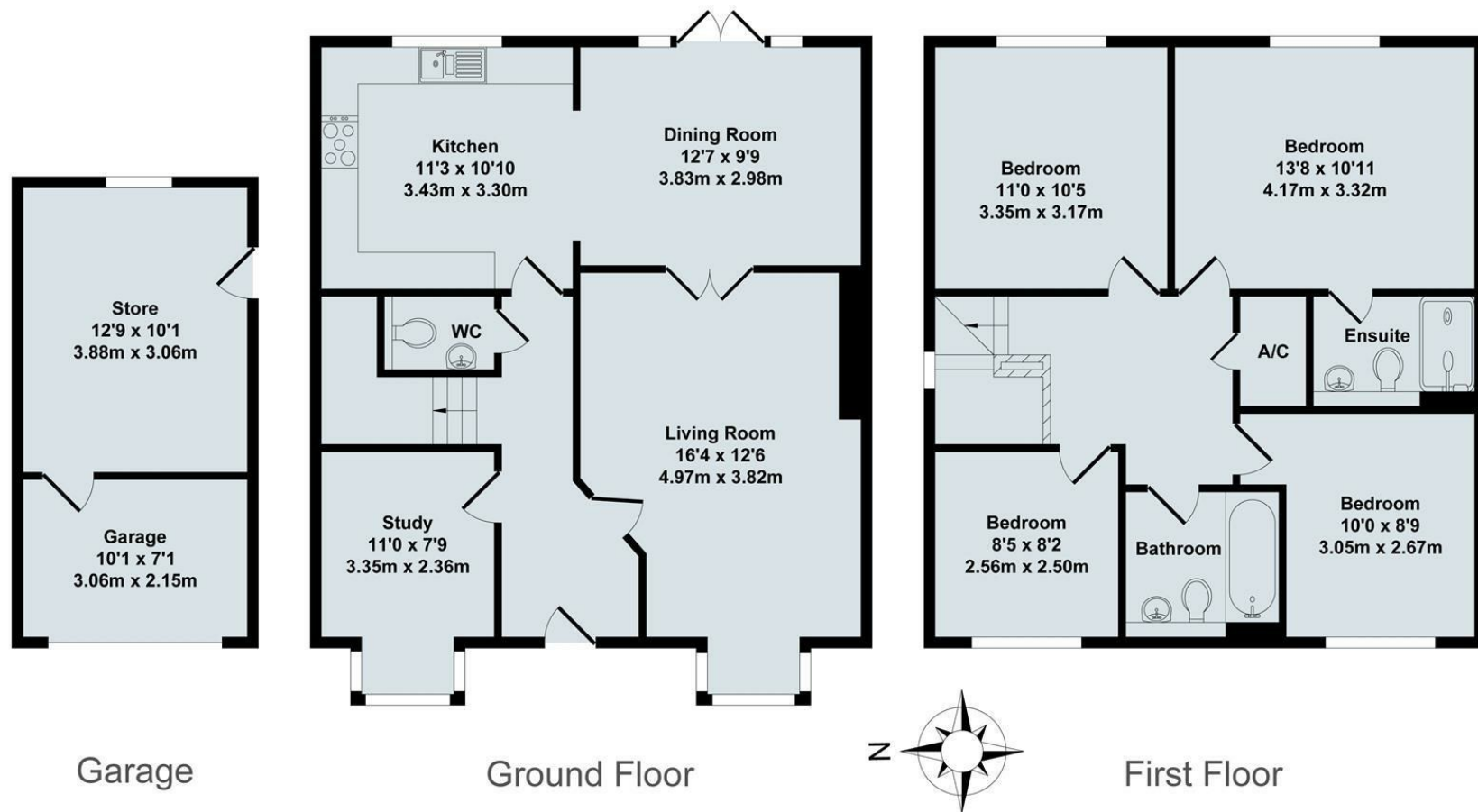

Total Approx. Floor Area 1498 Sq.Ft. (139.20 Sq.M.)

All items illustrated on this plan are included in the "Total Approx Floor Area"







## Energy Efficiency Rating

	Current	Potential
Very energy efficient - lower running costs		
(92 plus) <b>A</b>		<b>94</b>
(81-91) <b>B</b>	<b>84</b>	
(69-80) <b>C</b>		
(55-68) <b>D</b>		
(39-54) <b>E</b>		
(21-38) <b>F</b>		
(1-20) <b>G</b>		
Not energy efficient - higher running costs		
<b>England &amp; Wales</b>	EU Directive 2002/91/EC	



### Directions

### Viewings

Viewings by arrangement only. Call 01235 514267 to make an appointment.

### Council Tax Band

E