



21 Worcester Drive, Didcot, Oxon, OX11 8UP

£1,300 PCM - 21st August 2025

- TWO BEDROOM HOUSE
- CLOSE TO TOWN CENTRE
- REAR GARDEN
- PARKING

21 Worcester Drive, Didcot OX11 8UP

A two bedroom mid terrace house situated on the edge of the town and within easy reach of the rail station. It comprises: Two double bedrooms both with fitted wardrobes. Bathroom with shower over. Lounge/Diner. Fully fitted kitchen with cooker, washing machine and fridge/freezer. Electric heating. Rear garden. Parking. EPC Rating D Council Tax Band C

The Ofcom Broadband Checker states there is

- Ultrafast broadband has download speeds of greater than 300Mbps.

When an application is agreed a holding deposit will be required of a maximum of one weeks rent



Council Tax Band: C



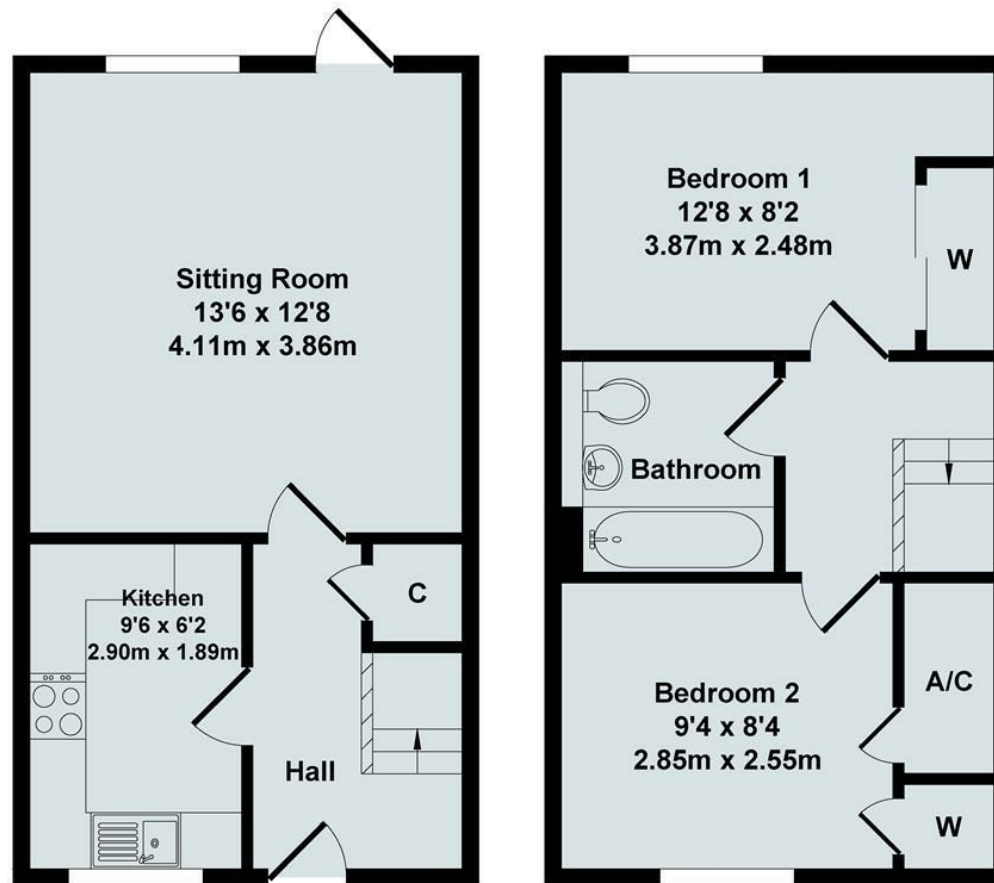

Ground Floor



First Floor

Total Approx. Floor Area 590 Sq.Ft. (54.80 Sq.M.)

All items illustrated on this plan are included in the "Total Approx Floor Area"

Energy Efficiency Rating

	Current	Potential
Very energy efficient - lower running costs		
(92 plus) A		84
(81-91) B		
(69-80) C		
(55-68) D	59	
(39-54) E		
(21-38) F		
(1-20) G		
Not energy efficient - higher running costs		
England & Wales	EU Directive 2002/91/EC	

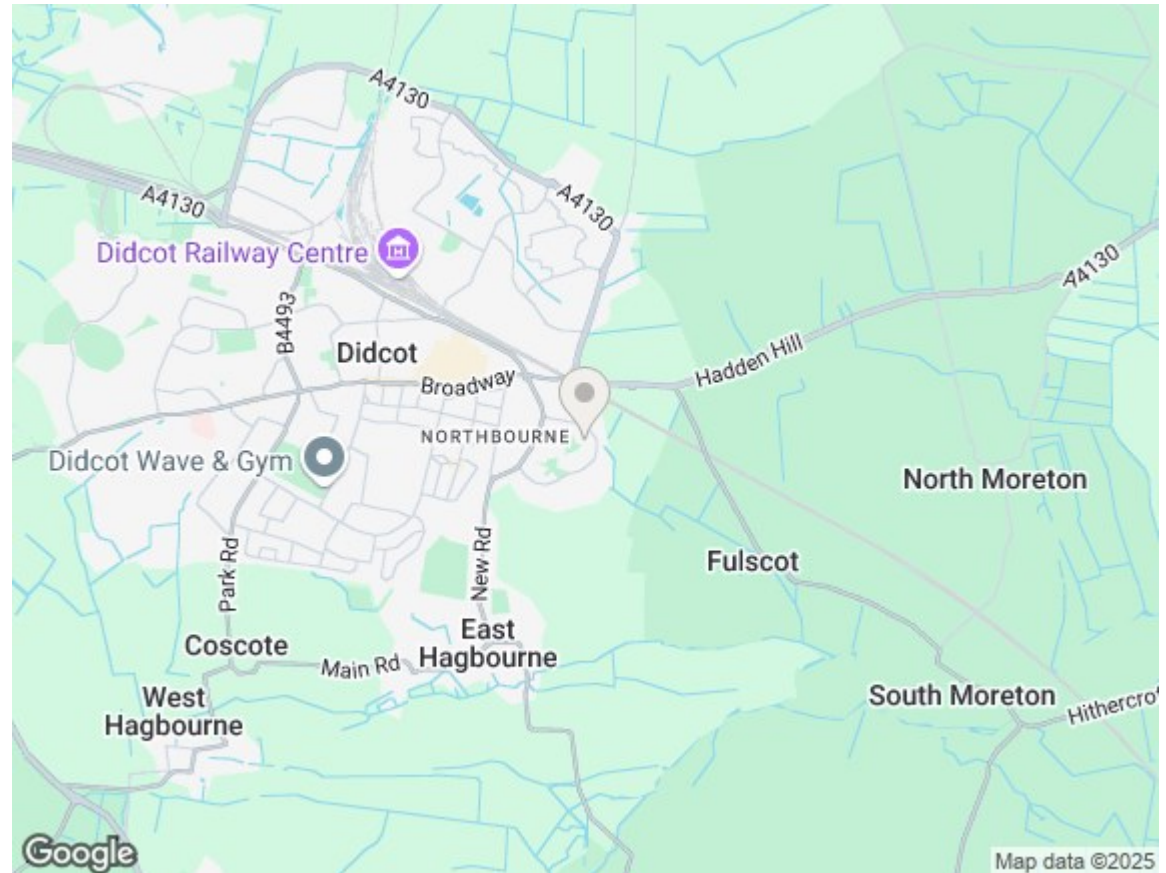

Directions

Viewings

Viewings by arrangement only. Call 01235 514267 to make an appointment.

Council Tax Band

C