



## 26 Littleworth Road, Benson, Wallingford, OX10 6LY

£1,425 PCM - 7th August 2025.

- 2 BEDROOMS
- GARDEN
- ALLOCATED PARKING
- CLOSE TO BENSON VILLAGE

# 26 Littleworth Road, Wallingford OX10 6LY

Two bedroom mid terrace house, located on this popular Cala Homes development on the edge of Benson village. Comprising of fully fitted kitchen with gas hob, electric oven, fridge/freezer, washing machine, dishwasher, sitting room with doors to the garden, cloakroom, double bedroom with en-suite shower room and fitted wardrobes, 2nd bedroom, family bathroom. Good size, rear garden. Allocated parking. Gas central heating. Council Tax Band D. EPC B.

The Ofcom Broadband Checker states there is:

- Ultrafast broadband has download speeds of greater than 300Mbps.

When an application is agreed a holding deposit will be required of a maximum of one weeks rent



Council Tax Band: D





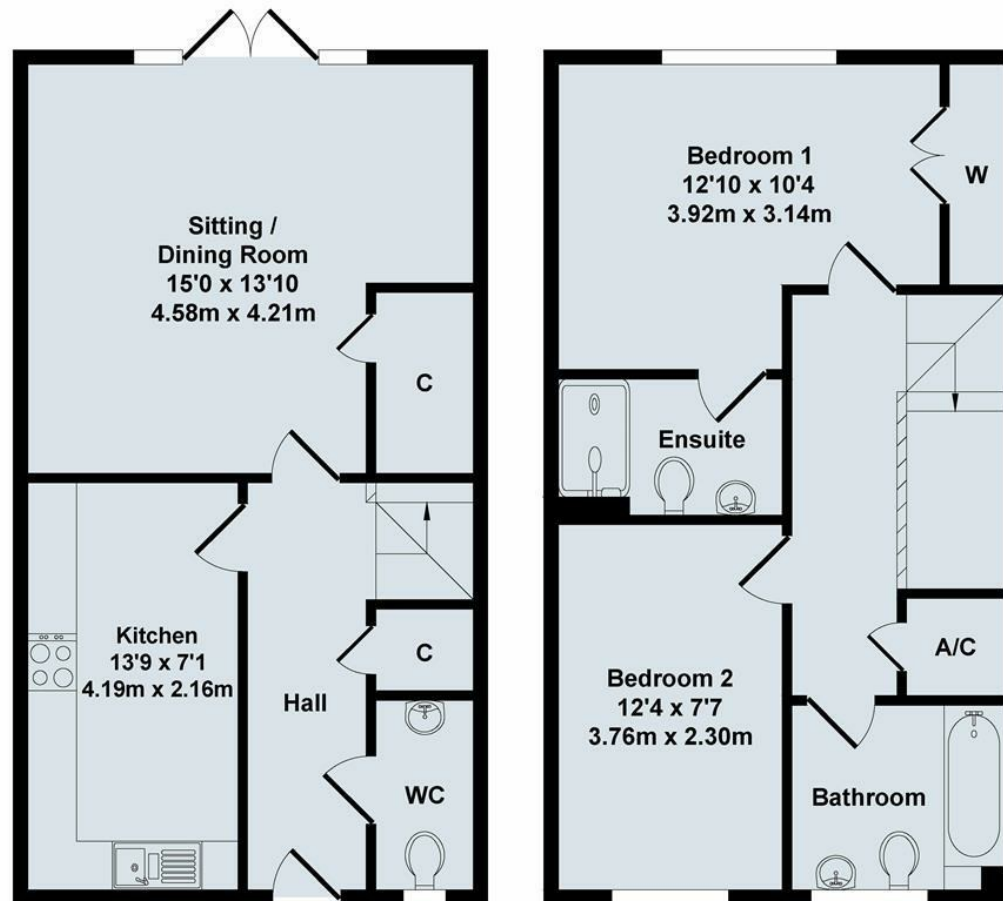

Ground Floor

First Floor

Total Approx. Floor Area 837 Sq.Ft. (77.80 Sq.M.)

All items illustrated on this plan are included in the "Total Approx Floor Area"







## Energy Efficiency Rating

	Current	Potential
Very energy efficient - lower running costs		97
(92 plus) <b>A</b>	84	
(81-91) <b>B</b>		
(69-80) <b>C</b>		
(55-68) <b>D</b>		
(39-54) <b>E</b>		
(21-38) <b>F</b>		
(1-20) <b>G</b>		
Not energy efficient - higher running costs		
<b>England &amp; Wales</b>	EU Directive 2002/91/EC	

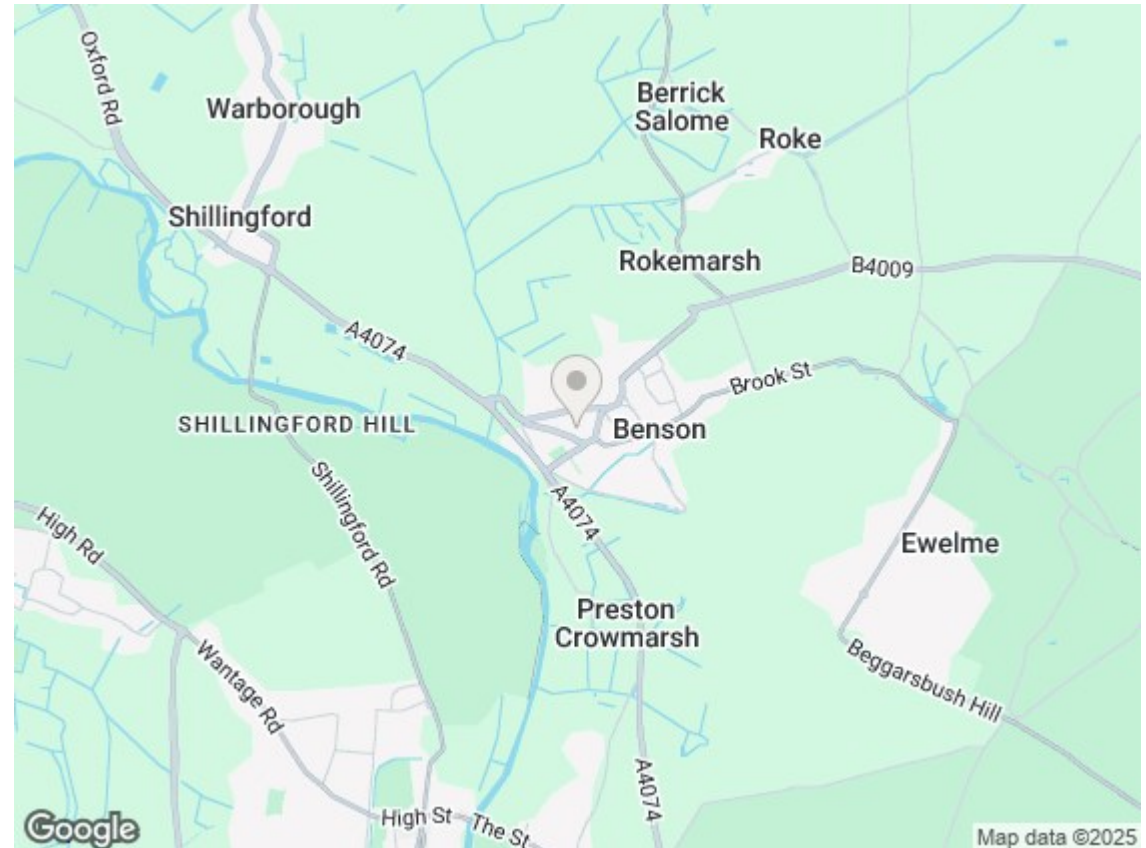

### Directions

### Viewings

Viewings by arrangement only. Call 01235 514267 to make an appointment.

### Council Tax Band

D