



27 Nuffield Close, Didcot, OX11 8TW

£1,600 PCM - 9th September 2024.

- Immaculately presented
- Located within easy walking distance of the town centre
- Gas central heating
- Garden is enclosed and has a shed
- Council Tax Band C. EPC Rating B

27 Nuffield Close, Didcot OX11 8TW

Immaculately presented, 3 bedroom house located within easy walking distance of the town centre and rail station. Kitchen/dining room with cooker, fridge/freezer, washing machine and tumble dryer. Spacious sitting room with bifold doors overlooking the garden. 2 double bedrooms, single bedroom. Bathroom. Gas central heating, solar panels. Ample parking. Garden is enclosed and has a shed. Council Tax Band C. EPC rating B

The Ofcom Broadband Checker states there is:

- Ultrafast broadband has download speeds of greater than 300Mbps

When an application is agreed a holding deposit will be required of a maximum of one weeks rent



Council Tax Band: C







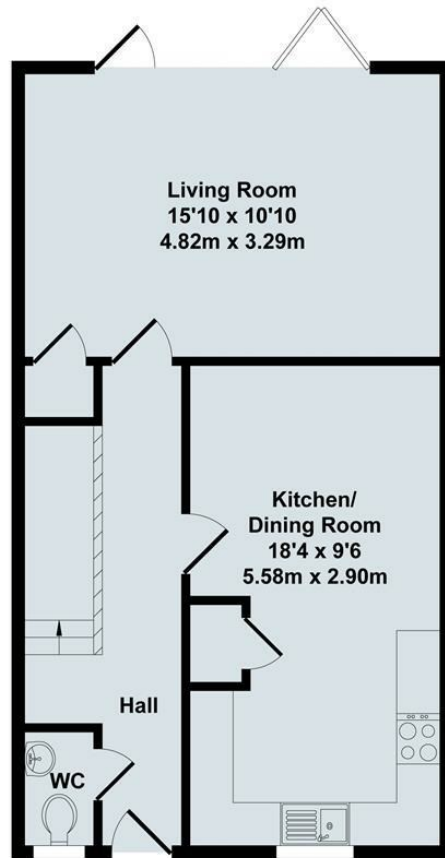

Ground Floor

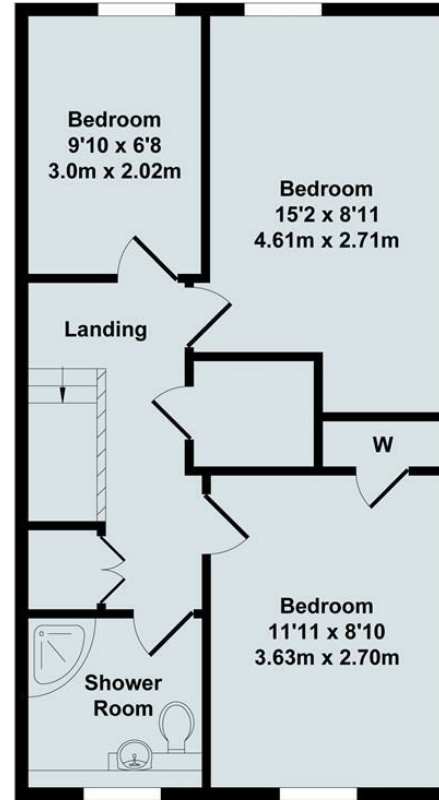

First Floor



Total Approx. Floor Area 931 Sq.Ft. (86.50 Sq.M.)

All items illustrated on this plan are included in the "Total Approx Floor Area"

Energy Efficiency Rating		
	Current	Potential
<i>Very energy efficient - lower running costs</i>		
(92 plus) A		
(81-91) B		
(69-80) C		
(55-68) D		
(39-54) E		
(21-38) F		
(1-20) G		
<i>Not energy efficient - higher running costs</i>		
England & Wales	EU Directive 2002/91/EC	

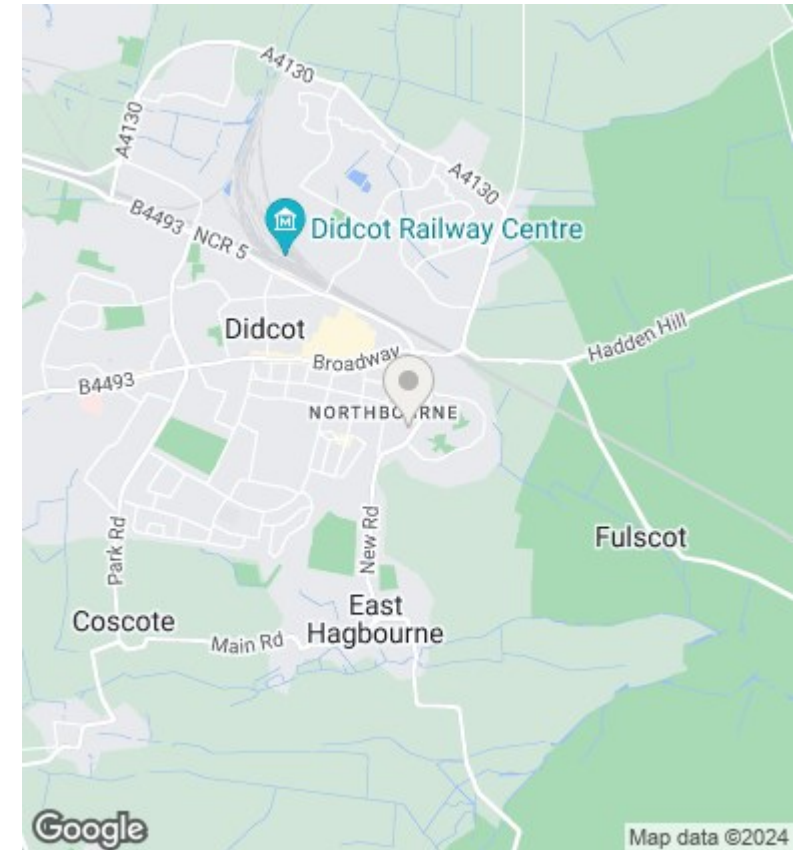

Directions

103 Broadway, Didcot, Oxfordshire, OX11 8AL
01235 514267

Viewings

Viewings by arrangement only. Call 01235 514267 to make an appointment.

Council Tax Band

C

southoxon@tmlettings.co.uk
<https://www.tmlettings.co.uk>