



**Sunbury Close  
Dukinfield, SK16 5HP**

**Offers in the region of £247,000**

Home Estate Agents are pleased to offer for sale this substantial four bedroom extended semi detached property ideally located in a popular location on an elevated position with fantastic views to the rear.

The well planned family sized accommodation is in need of a little cosmetic attention which has been reflected in the realistic asking price and briefly comprises: To the ground floor, entrance hallway, good sized family lounge, fitted dining kitchen with long range views and patio doors to the rear garden, the hallway offers direct access to the garage and the utility/Storage room beyond. To the first floor there are four good sized bedrooms and a family bathroom/WC. To the outside there is a garden and driveway to the front leading to the garage, whilst to the rear lies an excellent sized tiered garden offering far reaching views over Tameside and Manchester. The property further benefits from Upvc double glazing and gas central heating ensuring that this property will appeal to even the most discerning of purchasers!

Viewing Highly Recommended!

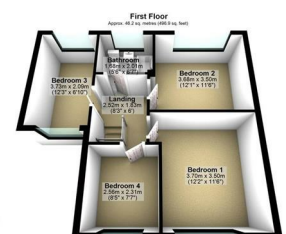
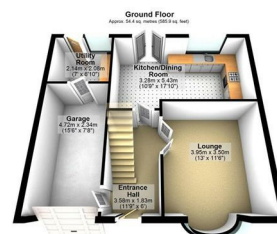

Total area: approx. 1006 sq. metres (10828 sq. feet)

- Four Bedroom Extended Semi ■ Deceptively Spacious Detached
- Gardens & Driveway ■ Long RabgeViews to Rear
- Popular Residential Location ■ Viewing Essential!