



Carrbrook Crescent
Stalybridge, SK15 3LR
Offers over £239,950

Carrbrook Crescent, Stalybridge, SK15 3LR

Nestled in the coveted Carrbrook area, this delightful three-bedroom semi-detached property presents an ideal opportunity for growing families. Boasting a serene environment with picturesque countryside views, this home offers a perfect blend of comfort, convenience, and tranquility. The property boasts a spacious lounge and kitchen/diner providing the perfect space for relaxation and gatherings with family and friends. Situated in the highly sought-after Carrbrook area, residents enjoy easy access to a host of local amenities, reputable schools, and efficient transport links. Whether it's shopping, education, or commuting, everything is within reach. Don't miss this opportunity to make this charming property your new home. ****Viewing Highly Recommended****

In brief the accommodation comprises of: Hallway, lounge and kitchen/diner to the ground floor. Three bedrooms and bathroom to the first floor. Lawned garden to the front. Enclosed spacious tiered garden to the rear.

GROUND FLOOR

Porch

Door to front, door leading to:

Hallway

Double glazed window to side, radiator, stairs leading to first floor, doors leading to:

Lounge 17'2" x 10'9" (5.24m x 3.27m)

Double glazed window to front, feature fireplace with inset fire, radiator.

Kitchen/Diner 8'6" x 16'10" (2.58m x 5.12m)

Fitted with a matching range of base and eye level units with worktop space over, inset sink and drainer with mixer tap, plumbing for washing machine, space for fridge/freezer, built-in oven, built-in hob with extractor hood over, two double glazed windows to rear, radiator, door leading out to rear garden.

FIRST FLOOR

Landing

Double glazed window to side, loft access, door to storage cupboard, doors leading to:

Bedroom 1 12'0" x 10'0" (3.66m x 3.04m)

Double glazed window to front, radiator.

Bedroom 2 11'5" x 9'0" (3.49m x 2.74m)

Double glazed window to rear, radiator.

Bedroom 3 7'0" x 6'4" (2.14m x 1.93m)

Double glazed window to front, radiator.

Bathroom 5'6" x 7'7" (1.68m x 2.31m)

Three piece suite comprising bath, pedestal wash hand basin and low-level WC, tiled walls, two double glazed windows to rear.

OUTSIDE

Lawned garden to the front. Enclosed garden to the rear with paved patio seating area and lawn.

DISCLAIMER

Home Estate Agents believe all the particulars given to be accurate. They have not tested or inspected any equipment, apparatus, fixtures or fittings and cannot, therefore, offer any proof or confirmation as to their condition or fitness for purpose thereof. The purchaser is advised to obtain the necessary verification from the solicitor or the surveyor. All measurements given are approximate and for guide purposes only and should not be relied upon as accurate for the purpose of buying fixtures, floor-coverings, etc. The buyer should satisfy him/her self of all measurements prior to purchase.

Before we can accept an offer for any property we will need certain information from you which will enable us to qualify your offer. If you are making a cash offer which is not dependent upon the sale of another property we will require proof of funds. You should be advised that any approach to a bank, building society or solicitor before we have qualified your offer may result in legal or survey fees

being lost. In addition, any delay may result in the property being offered to someone else.

WWW.HOMEA.CO.UK



Ground Floor

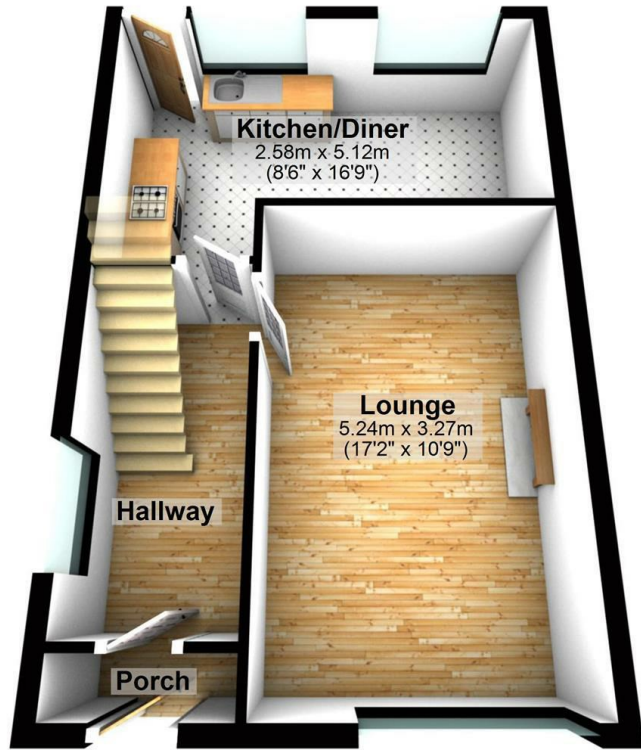

First Floor

