



**Salisbury Drive
Dukinfield, SK16 5DL**

Offers in the region of £280,000

Home Estate Agents are pleased to offer for sale this fantastic two bedroom extended detached bungalow offering family sized accommodation of which only a full personal inspection will fully reveal.

Offering fantastic potential and with extremely versatile accommodation this family home has been well cared for over the years and is certainly a credit to the owner with well planned accommodation that briefly comprises: To the ground floor, entrance porch, lounge through dining room with long range view to Manchester, Oldham and beyond, fitted kitchen, two excellent sized bedrooms and a bathroom/WC. The loft is certainly worthy of note being of a considerable size with potential to create further accommodation if required. To the outside the property boasts excellent sized gardens to the front and rear with block paved driveway to the front providing potential parking for two/three vehicles. The property is Upvc double glazed and central heated and only a full personal inspection will fully reveal the quality of accommodation that is on offer.

AN OPPORTINUTIY NOT TO BE MISSED!

- Impressively Sized Two Bedroom Extended Bungalow
- Sought After Location
- Fantastic Potential
- Versatile Accommodation
- Gardens & Driveway
- Chain Free!

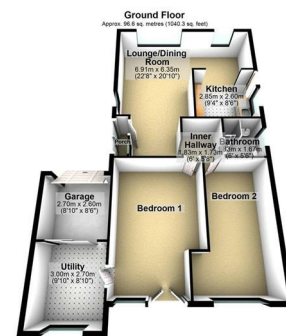

Total area: approx. 96.6 sq. metres (1040.3 sq. feet)