



Luscombe Maye
Since 1873

Membland, NEWTON FERRERS, South Devon

Guide Price £695,000

3 2 2



A rare opportunity to acquire a unique three double bedroom property which has come to the market for the first time in 35 years in the historic setting of Membland, a peaceful hamlet steeped in history situated just over a mile east of the creek side villages of Newton Ferrers and Noss Mayo.. Originally part of the Revelestoke Estate this superb 18th Century Grade II Listed property benefits from many period features and spacious accommodation. The property enjoys a generous mature enclosed garden with the added benefit of a detached double garage and ample off road parking. Within walking distance of stunning National Trust coastal walks, beaches and the estuary villages of Newton Ferrers and Noss Mayo. From the front garden, part glazed double doors open into the garden room with quarry tiled floor and exposed stonework to one wall. A glazed door leads into the entrance hallway, with stairs to first floor. The sitting room is beautifully proportioned with a high ceiling, deep window sills and French doors opening out to the main courtyard, a feature stone built fireplace with slate hearth and granite mantel fitted with a wood burning stove. There is an inner hallway with attractive archway leading through to the kitchen/dining room fitted with a range of oak floor base and wall units. On the first floor there is a master bedroom with en-suite shower room, two further double bedrooms with built in storage and a family bathroom.

To the front of the property there are two attractive brick arches leading to a covered seating area, and the communal courtyard. In the rear garden there is a workshop and a lean-to woodstore and patio area. The remainder of the rear garden is laid to lawn, with built-in BBQ, fruit trees and planted shrubs. At the top of the garden there is a drive with off road parking for up to 4 cars and a detached double garage with up and over door and a side pedestrian door.

Verified Material Information

Further information available by scanning the QR code available in the images or by following the link:

<https://moverly.com/sale/KNk7ePutvW4fpPHRFVERmp/view>



Pheasant Cottage, Membland, Newton Ferrers, Devon, PL8 1HP

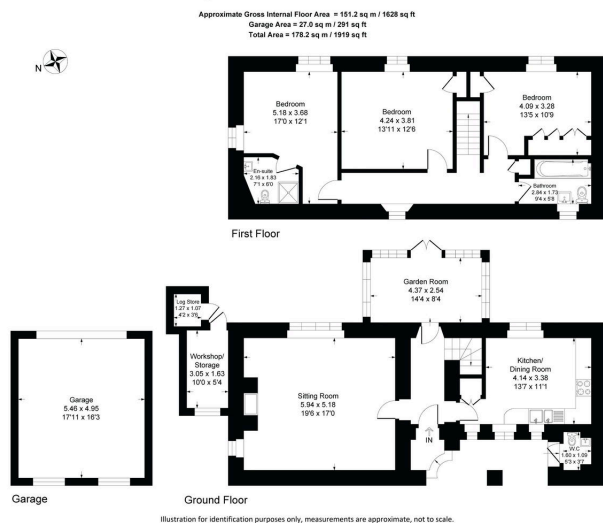

- Character three bedroom property
- Period features
- Detached double garage and off road parking
- Garden room
- Level garden
- Delightful mature gardens
- Within walking distance of the coast
- Farmhouse style kitchen
- Drawing room
- No chain

