



Luscombe Maye
Since 1873

The Orchard, Modbury

Guide Price £612,500

🛏 5 🚿 3 🚗 1



- Utility Room
- Two Bedrooms with Ensuite
- Walking Distance to Town Centre
- Views over Modbury Town
- Double Garage
- Nearby Amenities
- Modern Finishes Throughout
- Naturally Light and Bright
- Driveway Parking
- Five Double Bedrooms



An immaculately presented five bedroom semi-detached house located in the heart of Modbury with a double garage, driveway parking, private garden and views over the town.

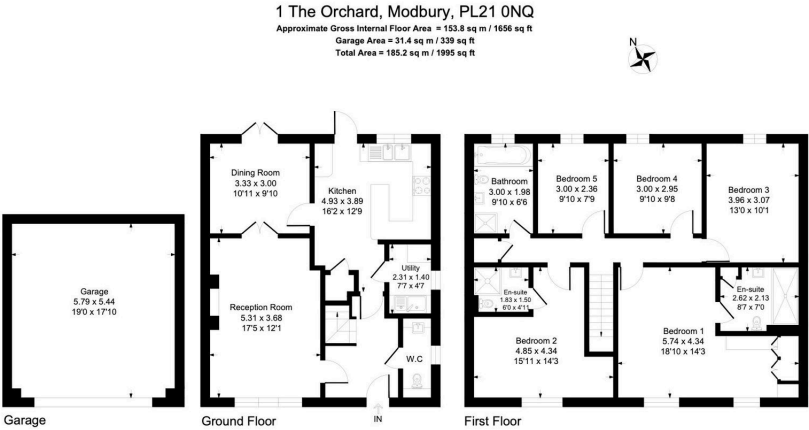
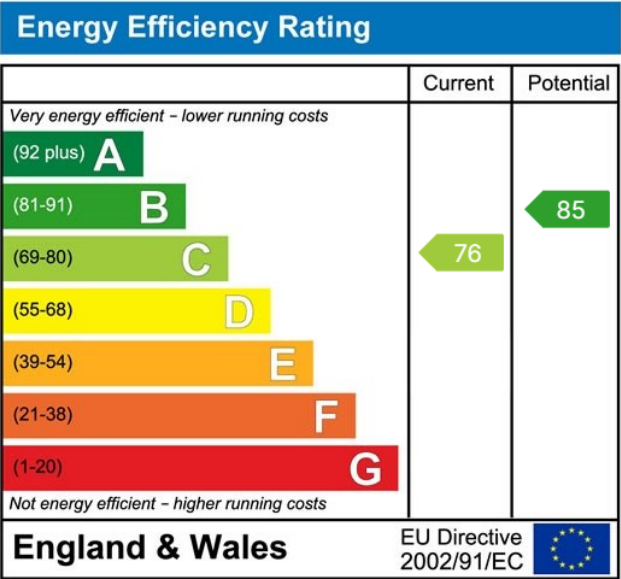

Illustration for identification purposes only, measurements are approximate, not to scale.



Modbury:
3 Church Street, Modbury, Ivybridge PL21 0QW
01548 830831
modbury@luscombemaye.com
www.luscombemaye.com

Important Notice: Luscombe Maye gives notice that: 1. These particulars do not constitute an offer or contract or part thereof. 2. All descriptions, photographs and plans are for guidance only and should not be relied upon as statements or representations of fact. All measurements are approximate and not necessarily to scale. Any prospective purchaser must satisfy themselves of the correctness of the information within the particulars by inspection or otherwise. 3. Luscombe Maye does not have any authority to give any representations or warranties whatsoever in relation to this property (including but not limited to planning/building regulations), nor can it enter into any contract on behalf of the Vendor.