

The Orchard, Modbury, PL21 0NQ

Guide Price £280,000

 2  2  1



An immaculately presented two bedroom top-floor apartment benefiting from outstanding views across Modbury and two private parking spaces. EPC Rating C.



Luscombe Maye

Since 1873

Key Features

- Immaculately Presented Apartment
- Master Bedroom with Ensuite
- Outstanding Views over Modbury
- Quiet and Peaceful Location
- Surrounded by Countryside Walks
- Two Double Bedrooms
- Two Parking Spaces
- Walking Distance to Nearby Amenities
- Communal Garden
- Recently Modernised and Improved Throughout

8 St Georges Court, Modbury, PL21 0NQ

Approximate Gross Internal Floor Area = 63.9 sq m / 688 sq ft

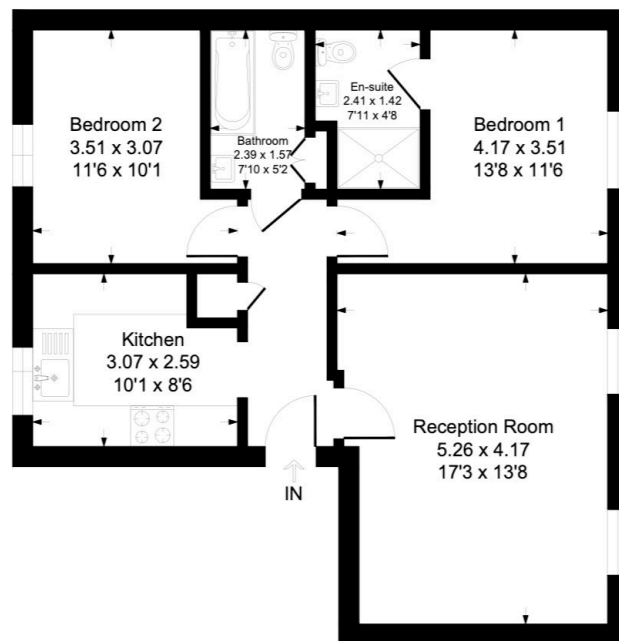

Second Floor

Illustration for identification purposes only, measurements are approximate, not to scale.