

 Luscombe Maye
Since 1873

Brookside

Tuckenhay, Totnes TQ9 7EL
Guide Price £695,000



Full Description

SITUATION

Alongside the Harbourne River (Bow Creek), a tidal Dart tributary, Tuckenhay is a pretty and tiny village between Ashprington and Crnworthy. Tuckenhay has two well known inns serving good food and there are good pubs at Ashprington and Cornworthy too. Also nearby is Sharpham Vineyard and Restaurant. The mediaeval town of Totnes with independent shops, good facilities and a mainline station is 4 miles away and Dartmoor, the South Hams and the glorious South Devon coast are all within easy reach.

DESCRIPTION

Luscombe Maye is proud to offer the rare opportunity to buy this detached bungalow in the heart of Tuckenhay.

The accommodation briefly comprises a kitchen, dining room, living room, and three double bedrooms. The kitchen is well appointed with wall and base units and finished in a fitting sage green colour. The dining room is a very serene space, with beautiful, dual aspect, floor to ceiling windows overlooking the garden and flowing stream. The dining room leads into the living room which is similarly a very light room with a central fireplace and a door out to the sun room.

All three bedrooms are a good size offering ample space for double beds, all serviced by the three piece family bathroom.

Outside, the property has driveway parking and a fabulous wrap around garden with a stream running along the entirety of the Southeast boundary. The garden is mainly laid to lawn and has well established flowers and shrubs throughout.

SERVICES

All mains services connected

TENURE

Freehold

VIEWINGS

Viewing strictly by appointment with Luscombe Maye.

LOCAL AUTHORITY

South Hams District Council. Follaton House, Plymouth Road, Totnes TQ9 5NE. Tel: 01803 861234. www.southhams.com

DIRECTIONS

What3Words - inserting.sling.spoons

LETTINGS

Luscombe Maye also offers an Award Winning Lettings service. If you are considering Letting your own property, or a buy to let purchase, please contact Andrew or Ross on 01752 393330 or lettings@luscombemaye.com to discuss our range of bespoke services.

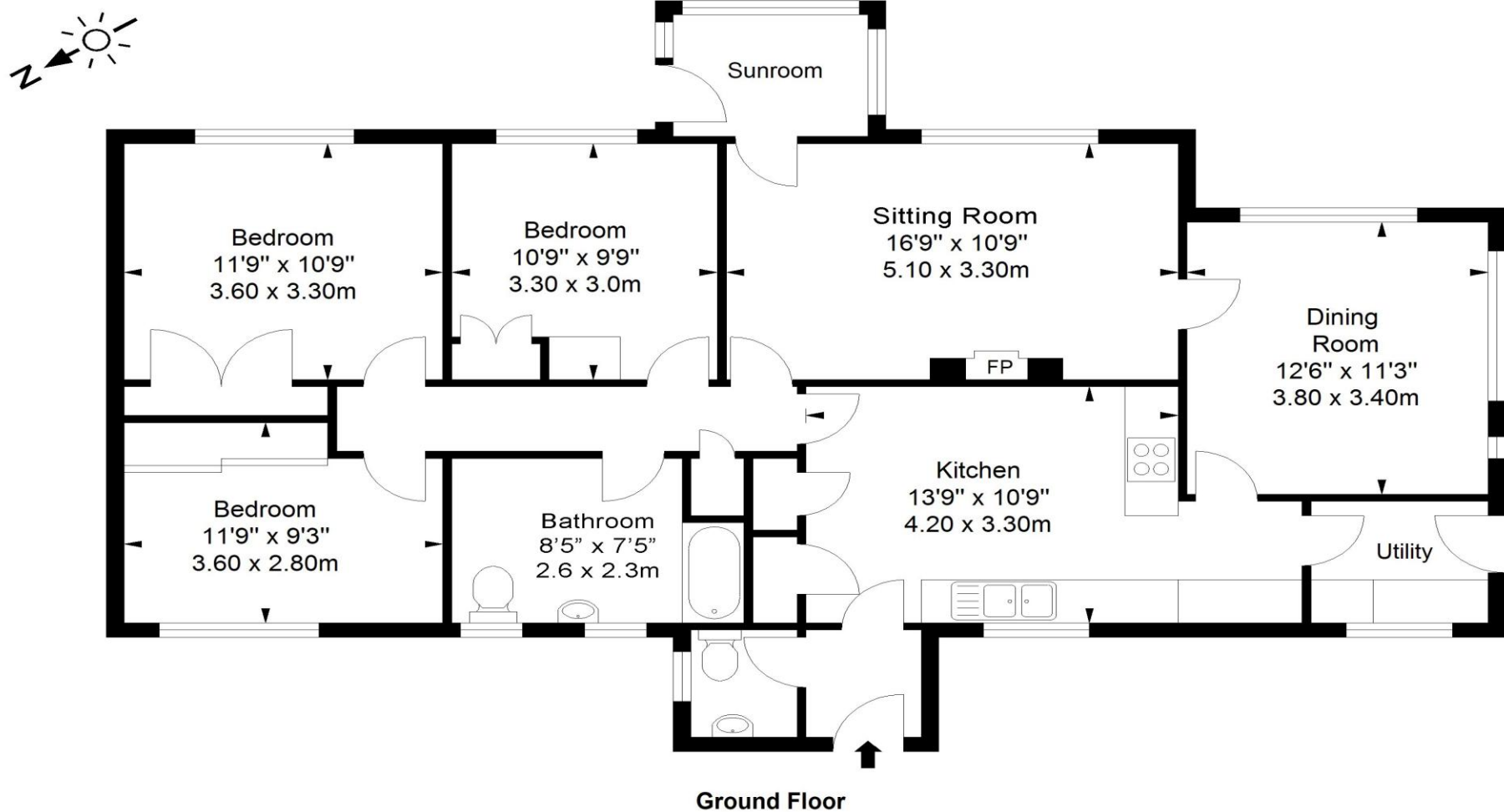
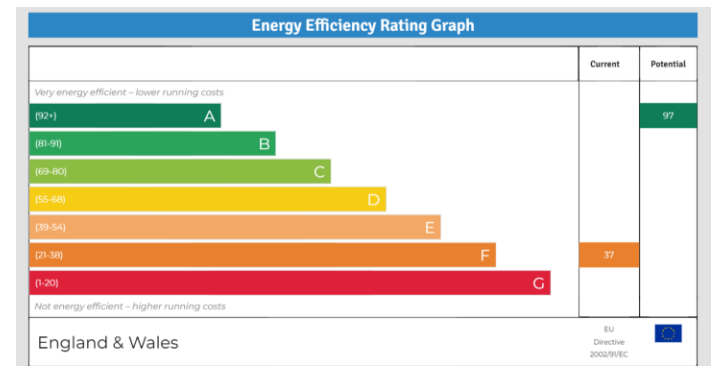

Approximate Gross Internal Area = 107.49 sqm / 1157 sq ft

01803 869920

www.luscombemaye.com

Totnes@luscombemaye.com

Important Notice: Luscombe Maye gives notice that: 1. These particulars do not constitute an offer or contract or part thereof. 2. All descriptions, photographs and plans are for guidance only and should not be relied upon as statements or representations of fact. All measurements are approximate and not necessarily to scale. Any prospective purchaser must satisfy themselves of the correctness of the information within the particulars by inspection or otherwise. 3. Luscombe Maye does not have any authority to give any representations or warranties whatsoever in relation to this property (including but not limited to planning/building regulations), nor can it enter into any contract on behalf of the Vendor. 59 Fore Street, Totnes, Devon, TQ9 5NJ

Luscombe Maye
Since 1873