



Luscombe Maye
Since 1873

Causen Cottage, The Grove, Totnes

Guide Price £900,000

🛏 4 🚿 2 🚽 3



- Hidden Gem Situated in the Heart of Totnes
- Four Bedroom Family Home
- Planning Permission for 2 Bedroom, Study & 2 Bath Dwelling
- South Facing Position
- First Time to the Market
- Versatile Living Space
- Including Self Contained One Bedroom Annex
- Mature Walled Garden
- Two Allocated Parking Spaces
- Owns 'The Grove' Bank & Trees on Shared Road



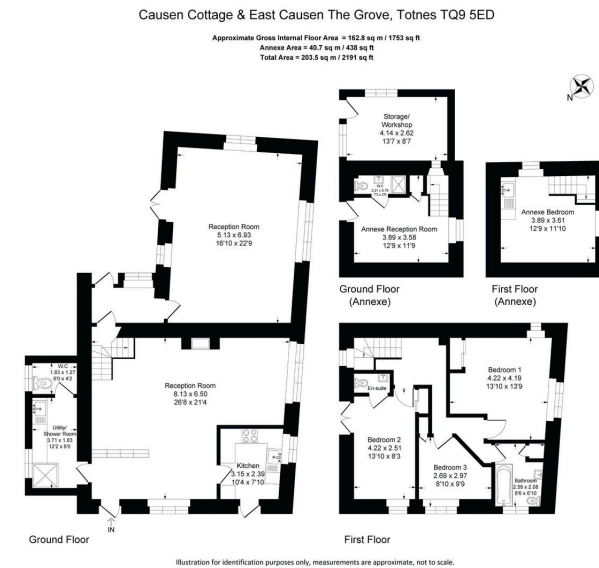

Hidden Gem Situated in the Heart of Totnes | Versatile Living Space | Four Bedroom Family Home | Including Self Contained One Bedroom Annex | Planning Permission for 2 Bedroom, Study & 2 Bath Dwelling | Mature Walled Garden | South Facing Position | Two Allocated Parking Spaces | First Time to the Market | Owns 'The Grove' Bank & Trees on Shared Road

