



# Luscombe Maye

Since 1873

## Priory View, Cornworthy

Guide Price £395,000

3 1 1



- Detached Bungalow
- Three Bedrooms
- Open Plan Living Space
- Private & Enclosed Garden
- Garage Workshop
- Basement Storage
- Driveway Parking
- Highly Sought After Village Location
- Views of Cornworthy Priory
- EPC E

Important Notice: Luscombe Maye gives notice that: 1. These particulars do not constitute an offer or contract or part thereof. 2. All descriptions, photographs and plans are for guidance only and should not be relied upon as statements or representations of fact. All measurements are approximate and not necessarily to scale. Any prospective purchaser must satisfy themselves of the correctness of the information within the particulars by inspection or otherwise. 3. Luscombe Maye does not have any authority to give any representations or warranties whatsoever in relation to this property (including but not limited to planning/building regulations), nor can it enter into any contract on behalf of the Vendor.



**Luscombe  
Maye** Since 1873

**Totnes:**  
59 Fore Street, Totnes TQ9 5NJ  
01803 869920  
totnes@luscombemaye.com  
[www.luscombemaye.com](http://www.luscombemaye.com)



# Luscombe Maye

Since 1873



## 16 Priory View, Cornworthy, TQ9 7HN

Approximate Gross Internal Floor Area = 89.7 sq m / 966 sq ft  
Garage Area = 12.6 sq m / 136 sq ft  
Total Area = 102.3 sq m / 1102 sq ft

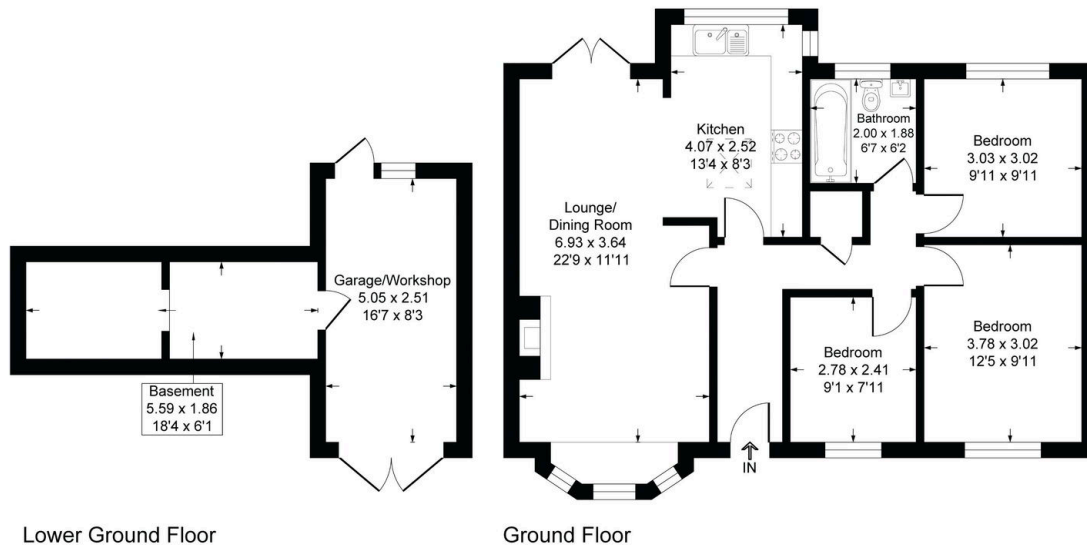

Illustration for identification purposes only, measurements are approximate, not to scale.

Detached Bungalow | Basement Storage | Three Bedrooms | Driveway Parking | Open Plan Living Space | Highly Sought After Village Location | Private & Enclosed Garden | Views of Cornworthy Priory | Garage Workshop | EPC E



## Luscombe Maye

Since 1873

Totnes:  
59 Fore Street, Totnes TQ9 5NJ  
01803 869920  
totnes@luscombemaye.com  
[www.luscombemaye.com](http://www.luscombemaye.com)