



## 37a Chatsworth Road, Harrogate

Harrogate

Guide Price £245,000



# MYRINGS





## 37a Chatsworth Road

Harrogate, Harrogate

CLOSE TO TOWN CENTRE - LARGE LUXURY BATHROOM - ENCLOSED PATIO GARDEN TO THE REAR - 3 DOUBLE BEDROOMS - CELLAR SPACE - PRIMARY SCHOOL 4 MINUTES WALK - TRAIN STATION 15 MINUTES WALK

Council Tax band: B

Tenure: Freehold

- CLOSE TO TOWN CENTRE
- 3 DOUBLE BEDROOMS
- LARGE LUXURY BATHROOM
- CELLAR SPACE
- ENCLOSED PATIO GARDEN TO THE REAR
- TRAIN STATION 15 MINUTES WALK
- PRIMARY SCHOOL 4 MINUTES WALK



MYRINGS





# Chatsworth Road , Harrogate, HG1

Approximate Area = 1156 sq ft / 107.3 sq m

Limited Use Area(s) = 73 sq ft / 6.7 sq m

Total = 1229 sq ft / 114 sq m

For identification only - Not to scale



Denotes restricted  
head height

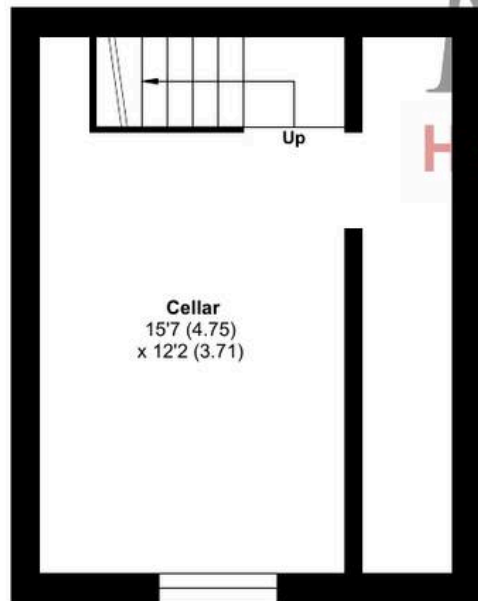

**BASEMENT**

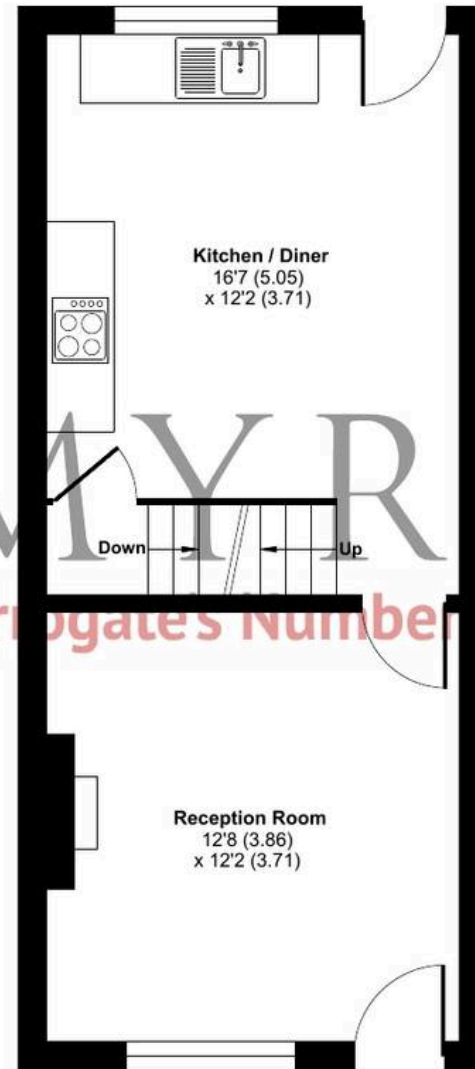

**GROUND FLOOR**

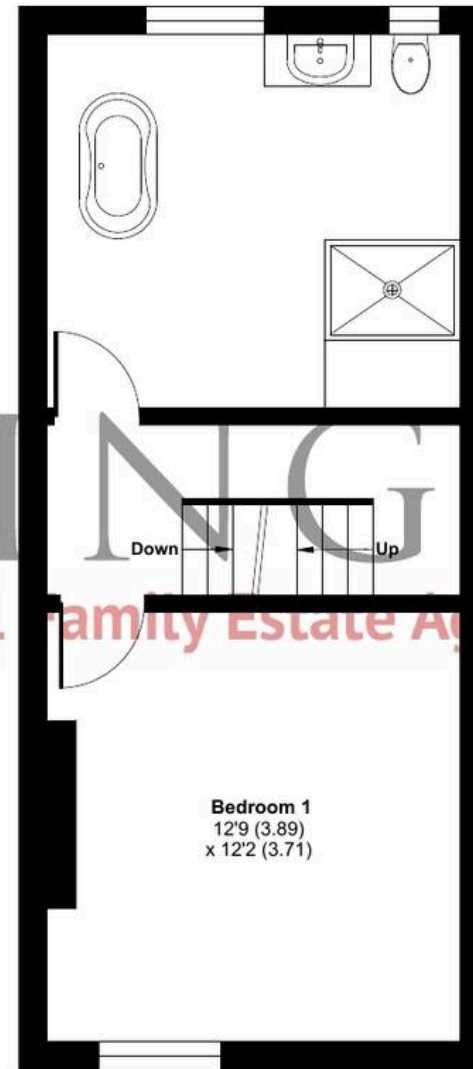

**FIRST FLOOR**

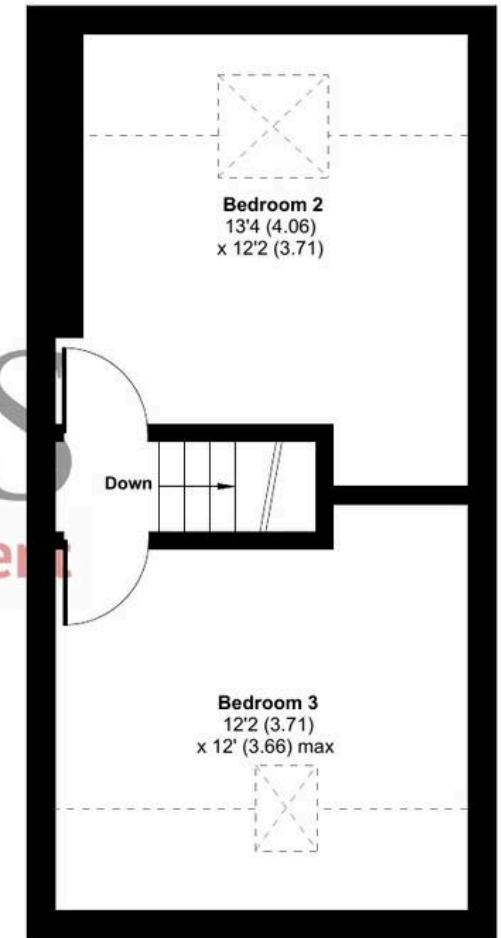

**SECOND FLOOR**



Floor plan produced in accordance with RICS Property Measurement Standards incorporating International Property Measurement Standards (IPMS2 Residential). © ncheom 2024.  
Produced for Myrings. REF: 1138790









## Myrings Estate Agents

Myrings Estate Agents Ltd, 10 Princes Square - HG1 1LX

01423

566400

▪ [enquiries@myringsestateagents.com](mailto:enquiries@myringsestateagents.com) ▪ <http://myringsestateagents.com/>

