



32 Wedderburn Road, Harrogate

Harrogate

Guide Price £360,000



MYRINGS

Harrogate's Family Estate Agent



32 Wedderburn Road

, Harrogate

Offered with no onward chain this spacious stone fronted semi-detached property located in a highly convenient position being close to all amenities benefits from having driveway parking for multiple vehicles along with garage and an enclosed rear garden.

Council Tax band: C

- NO CHAIN
- DRIVEWAY FOR MULTIPLE VEHICLES
- GARAGE
- ENCLOSED REAR GARDEN
- CONVENIENT LOCATION
- CLOSE TO ALL AMENITIES
- SOCIABLE KITCHEN DINER



MYRINGS



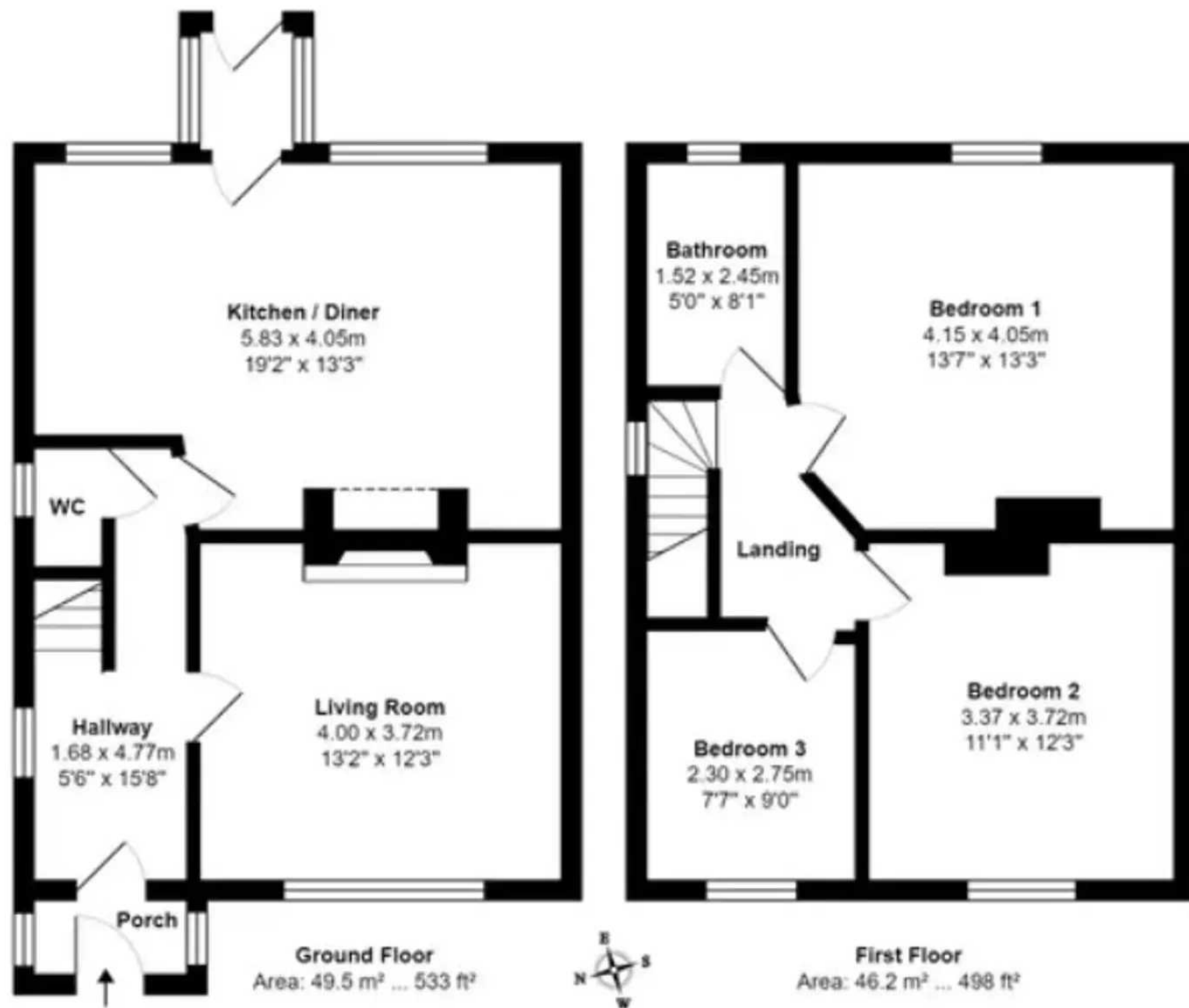

Total Area: 95.7 m² ... 1030 ft²

All measurements are approximate and for display purposes only.

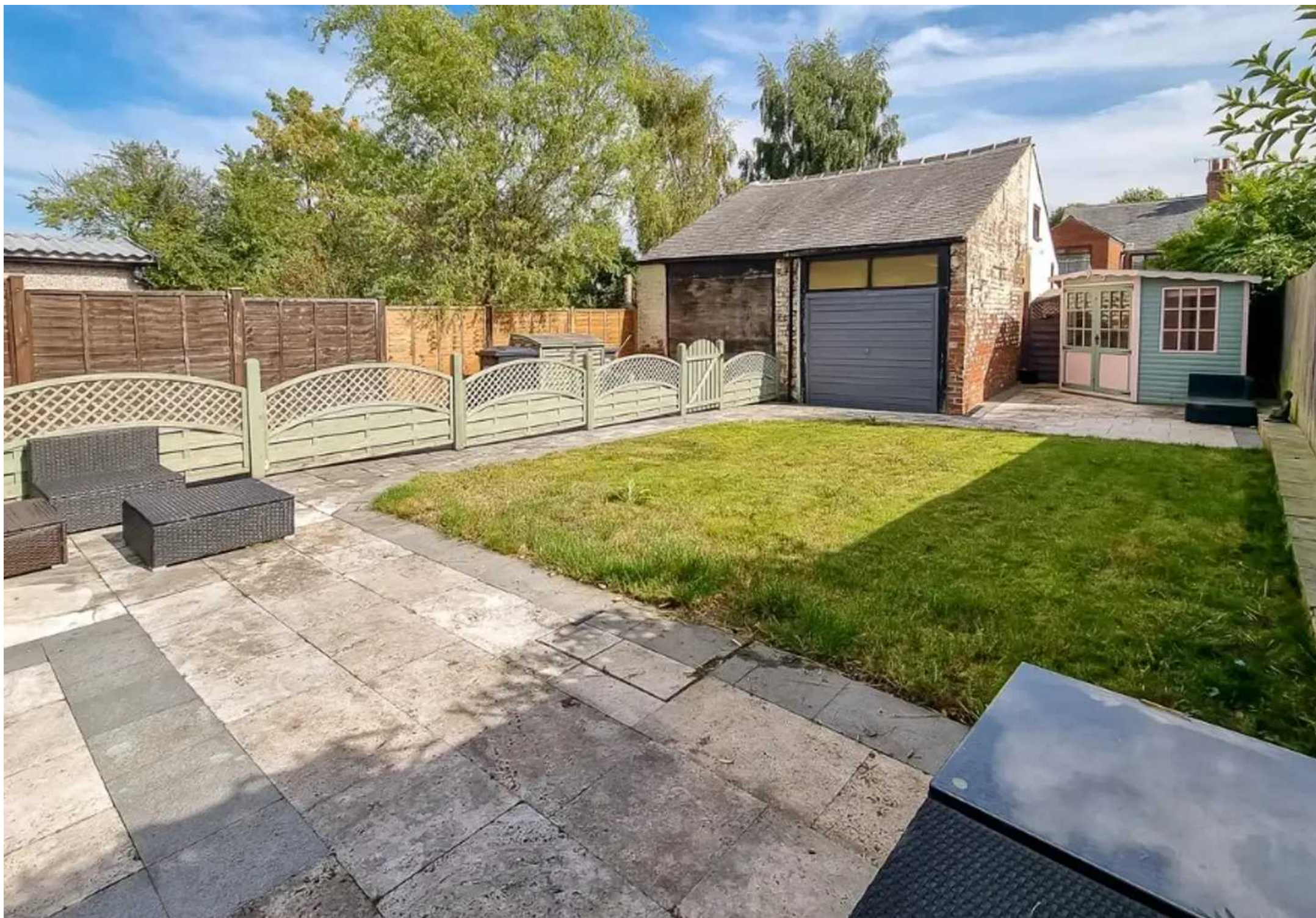



Myrings Estate Agents

Myrings Estate Agents Ltd, 10 Princes Square - HG1 1LX

01423
566400

• enquiries@myringsestateagents.com • <http://myringsestateagents.com/>

