



Luscombe Maye

Since 1873

Trevanna Road, Kingsbridge, TQ7 1ET

Guide Price £695,000

3 2 1



DESCRIPTION

This charming three-bedroom detached bungalow is nestled in a quiet, tucked-away corner of Kingsbridge, offering both privacy and a highly desirable location. The property boasts a spacious, well-designed layout, perfect for modern family living.

Upon entry, you'll be welcomed by a bright and airy dining area filled with natural light from sliding glazed doors that open directly onto the garden, providing an ideal space to entertain. The adjacent cosy living room, also featuring sliding glazed doors, allows even more light to flow into the heart of the home.

The modern fitted kitchen is well-equipped with contemporary fixtures and plenty of storage, making it a joy to cook and prepare meals. The three generously sized double bedrooms provide ample space, with the master bedroom benefiting from an en-suite bathroom that includes a level-access walk-in shower, WC, corner sink pedestal unit, a heated towel rail and underfloor heating for added comfort.

A family bathroom serves the remaining bedrooms, offering all the functionality needed for family life. Outside, accessed via some steps, the spacious garden features mature shrubs and a greenhouse, providing a peaceful and private outdoor retreat.

Additional benefits include a double fronted garage providing ample off-road parking and a further three spaces on the lower ground floor that provide additional storage.

The property offers the perfect combination of comfort, convenience, and style and is brilliantly located in the popular market town of Kingsbridge within easy walking distance of the town centre, local schools (Kingsbridge Community College is less than 5 minutes walk) and woodland walks making it an ideal choice for those looking for a tranquil retreat in a desirable location.



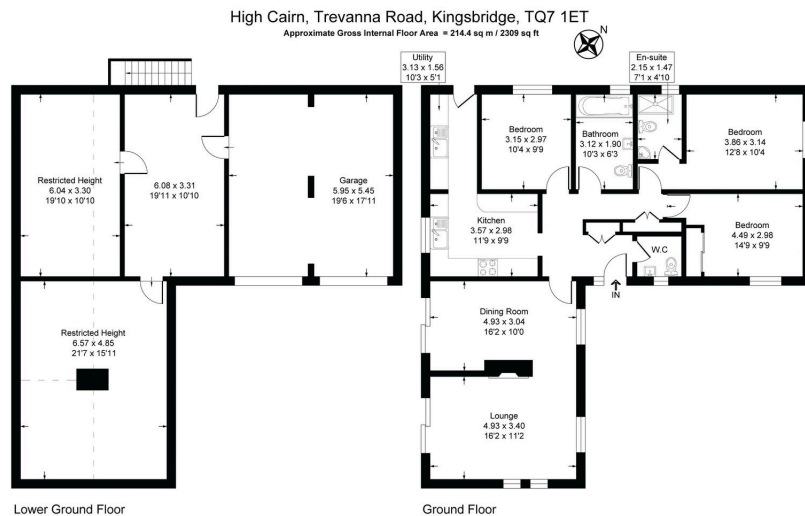

Illustration for identification purposes only, measurements are approximate, not to scale.



- Three bedroom bungalow
- Tucked away position
- Close to local school and town centre
- Light and airy living room/dining area
- Modern kitchen
- Spacious garden
- Double fronted garage
- Ample storage

