



Luscombe Maye
Since 1873

Hillside, Goveton, TQ7 2DT

£252,950

2 1 1



Set in the charming hamlet of Goveton, this delightful Devon cottage has been tastefully refurbished whilst retaining its original character. Just a short drive from Kingsbridge, yet tucked away from the bustle of town life, it offers a peaceful retreat in a truly picturesque setting.

Inside, the thoughtfully designed kitchen has been fitted with modern appliances while maintaining a cosy and traditional feel. The living and dining room is a welcoming space, featuring a wood-burning stove with stone inglenook adding warmth and character, making it the perfect spot to unwind during the colder months. Completing the ground floor you will find a modern shower room and utility area providing convenience and practicality.

Upstairs, there are two well-proportioned double bedrooms. The principle bedroom benefits from stunning rural views, creating a wonderful outlook to wake up to each morning, whilst the second bedroom enjoys views towards the rear garden.

The property's garden is a true highlight being spacious and south-facing, it enjoys long hours of sunshine and is mainly laid to lawn. Mature plants and shrubs border the plot, adding to the charm, while a summer house at the top of the garden offers a peaceful spot to sit back and take in the far-reaching countryside views. The garden's elevated position allows you to fully appreciate the beauty of the surrounding landscape, with only the sounds of birdsong to accompany you.

This is a rare opportunity to acquire a charming Devon cottage in a sought-after rural location, offering a perfect blend of character, comfort and countryside living.

Verified Material Information:

Council tax band: B

Tenure: Freehold

Property type: House

Property construction: Standard form



Hope Cottage, 2 Hillside, Goveton, Kingsbridge, TQ7 2DT

Approximate Gross Internal Floor Area = 50.7 sq m / 547 sq ft

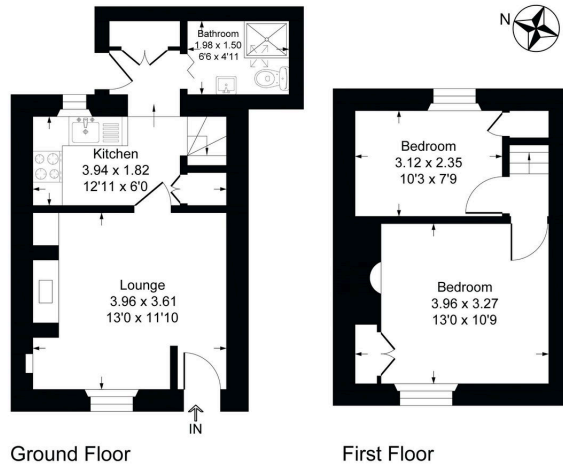

Illustration for identification purposes only, measurements are approximate, not to scale.

- Quintessential Devon Cottage • Abundance of Character & Charm
- Wood Burning Stove
- Modern & Thoughtfully Designed Kitchen
- Utility Area
- Modern & Spacious Shower Room
- Two Double Bedrooms
- Breathtaking Countryside Views
- Beautiful Garden
- Summer House

