



Luscombe Maye

Since 1873

# Meadowside, Chillington

£415,000

4 1 2



A delightful family home, perfectly positioned in a peaceful village location, just a short distance from the coast. This property offers a blend of countryside and coastal living with nearby amenities.

You are greeted by a welcoming entrance porch with plenty of space for coats and shoes. The hallway features built-in storage and leads to the first floor via a staircase. The dual aspect living room is a highlight, with sliding doors that open onto a decked area, perfect for enjoying the picturesque views. This room is complete with a wood burner, making it a warm retreat during the winter months. The kitchen is the heart of the home, boasting a central breakfast island, an Aga and stunning views over the fields. It flows seamlessly into the dining room and conservatory. The dining area extends into a bright conservatory, which features a charming glazed bay window and patio doors leading out to the deck, offering additional space for enjoying the garden and views beyond. Completing the ground floor, the versatile study, which could also serve as a fourth bedroom, includes built-in storage and a convenient cloakroom.

The first floor hosts three well-sized double bedrooms, each offering comfort and privacy. A modern family shower room completes the upstairs accommodation.

The south-facing garden is a true feature, mainly laid to lawn and bordered by open countryside. A raised decked area runs the width of the property, providing a perfect spot for outdoor dining and relaxation. The front of the property offers a gravel driveway with ample parking for up to four vehicles, with a pathway leading to the welcoming entrance porch.

This home is ideal for those seeking a peaceful village lifestyle, with the added benefit of coastal proximity. With stunning views, versatile living spaces and beautiful gardens.

### Polite Notice

This property is subject to a Devon restriction.



13 Meadowside, Chillington, Kingsbridge, TQ7 2HT

Approximate Gross Internal Floor Area = 121.6 sq m / 1309 sq ft

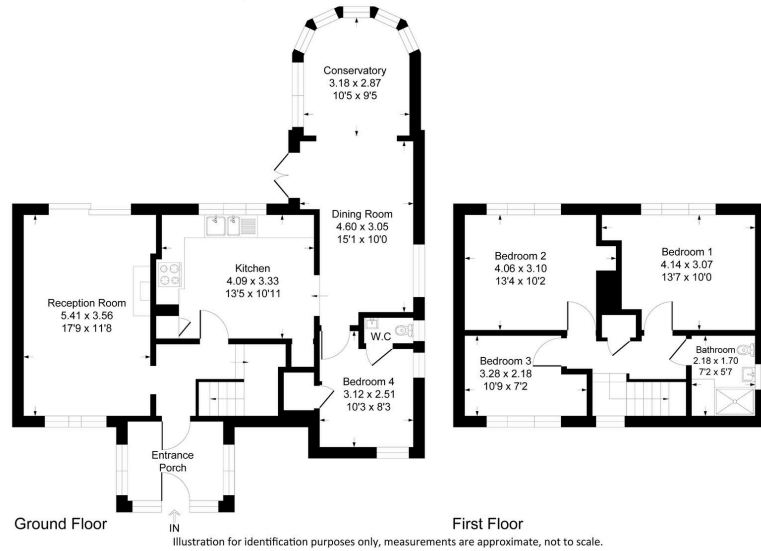

- Semi-detached
- Spacious, light & airy
- 4 bedrooms
- Ample parking
- Stunning rural views
- Peaceful location
- Proximity to amenities
- Popular village location



Important Notice: Luscombe Maye gives notice that: 1. These particulars do not constitute an offer or contract or part thereof. 2. All descriptions, photographs and plans are for guidance only and should not be relied upon as statements or representations of fact. All measurements are approximate and not necessarily to scale. Any prospective purchaser must satisfy themselves of the correctness of the information within the particulars by inspection or otherwise. 3. Luscombe Maye does not have any authority to give any representations or warranties whatsoever in relation to this property (including but not limited to planning/building regulations), nor can it enter into any contract on behalf of the Vendor.



**Kingsbridge:**  
62 Fore Street, Kingsbridge TQ7 1PP  
01548 857474  
kingsbridge@luscombemaye.com  
[www.luscombemaye.com](http://www.luscombemaye.com)